

DASH NO.	M CODE	MADE FROM
----------	--------	-----------

GSD

127-20-9

REVISIONS		
ISSUE	CHANGES	
1	CN 32698 E KH 11/12/90	
2	ER 32993 JCA 03/19/91	

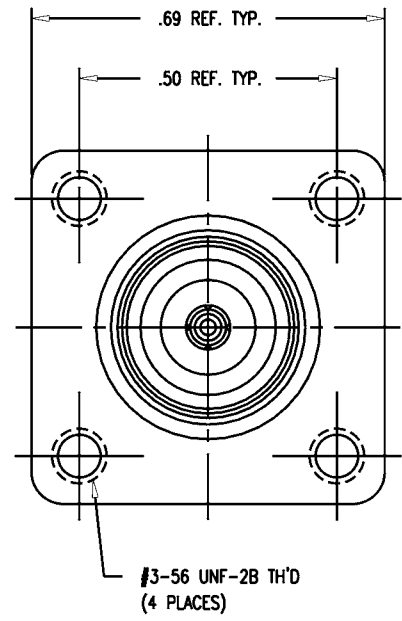
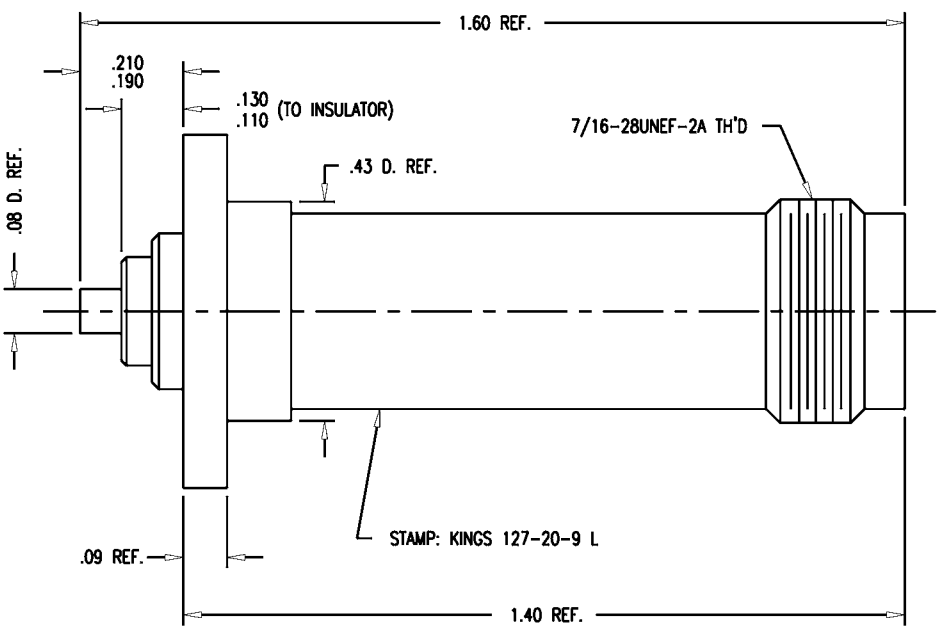

- NOTES:
- INTERFACE PER MIL-STD-348, FIG. 313-2.
 - MATERIALS:
INSULATOR: TEFLON, ASTM-D-1457
CENTER CONTACT: BER. COP., ASTM-B-196
ALL OTHER PARTS: BRASS, QQ-B-626
 - FINISHES:
CENTER CONTACT: HARD GOLD PLT. PER MIL-G-45204
ALL OTHER METAL PARTS: KINGS TARNISH RESISTANT FINISH (TR-5)
 - ELECTRICAL CHARACTERISTICS:
NOMINAL IMPEDANCE: 50 OHMS
VOLTAGE RATING: 500 VRMS
FREQUENCY RANGE: DC TO 11 GHz
 - REFERENCE DOCUMENT ONLY: SENSOR SYSTEMS DWG. S72-173511 REV. A

SCALE 4:1	
APPROX SURFACE AREA	
WAS: E-16627	
USED ON	
REF:	
RECEPTACLE, PANEL, TNC	
DRAWN JCA	DATE 10/29/90
DESIGN CT	DATE 10/29/90
APPR.	DATE

GSD

KINGS
 ELECTRONICS CO., INC.
 TUCKAHOE, NEW YORK 10707
127-20-9