

CATALOG NUMBER	"A" INTERFACE
0119-727-3-FD	FULL DETENT
0119-727-3-LD	LIMITED DETENT
0119-727-3-SB	SMOOTH BORE

MATERIAL AND FINISH

SHROUD AND HOUSING: CRES 303; PASSIVATED  
 CENTER CONTACT AND BUSHING: BeCu; GOLD PLATE 50-100 μ INCHES OVER NICKEL PLATE 50 μ INCHES MIN.  
 DIELECTRICS: VIRGIN PTFE (TEFLON)

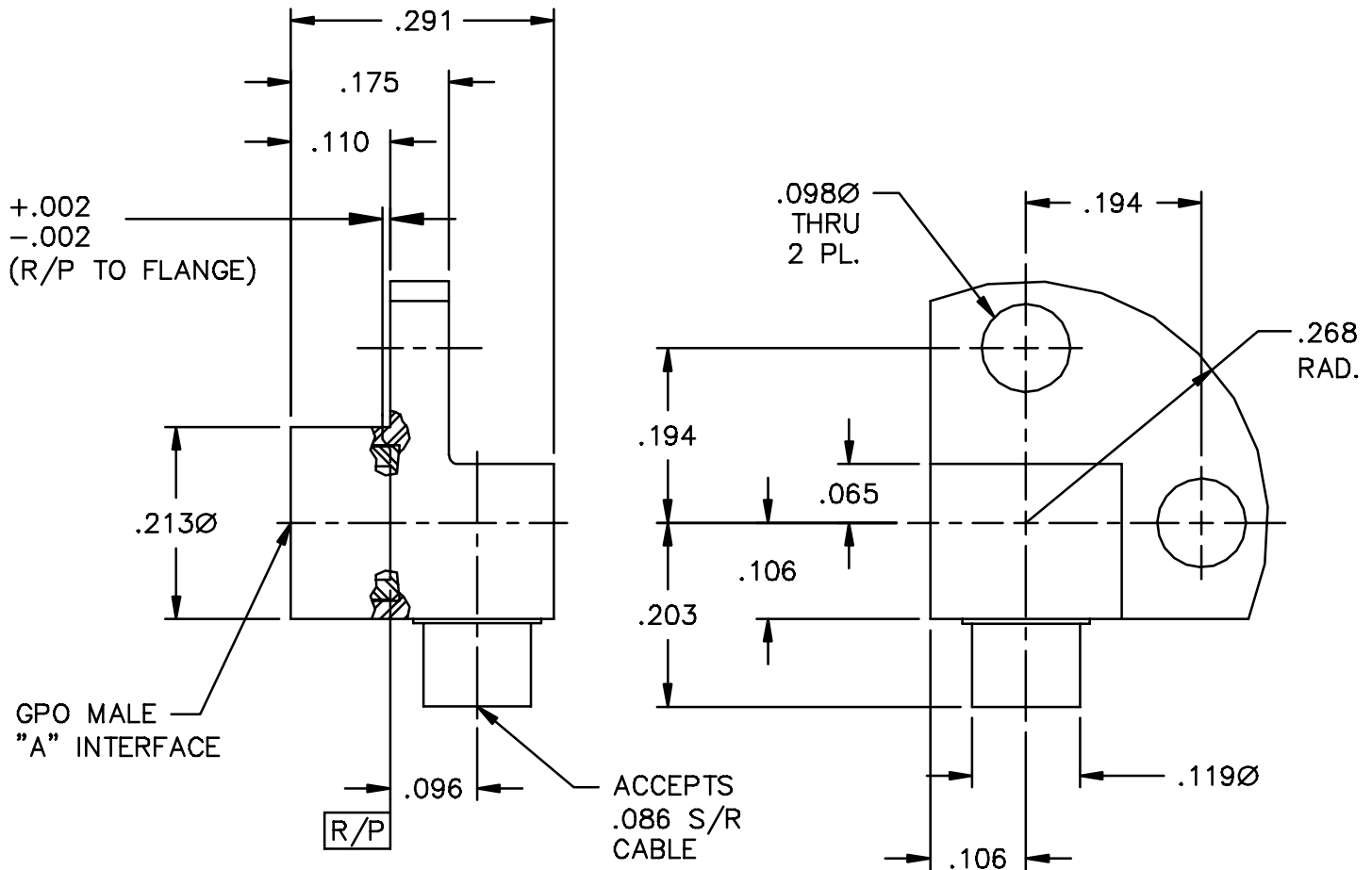

NOTE:  
 MIRROR IMAGE OF 0119-704-3-TAB

GPO MALE R/A  
 TO .086 S/R CABLE  
 (TAB DETENT)

IDENT CODE:  
 82316

REVISION: E

**GILBERT  
 ENGINEERING**

SOURCE FILE: MECR# 758

DWG. NO.: OL-0119-727-3-TAB

ASSY. PROC.: AP01-038