

CIRCUIT DIAGRAM

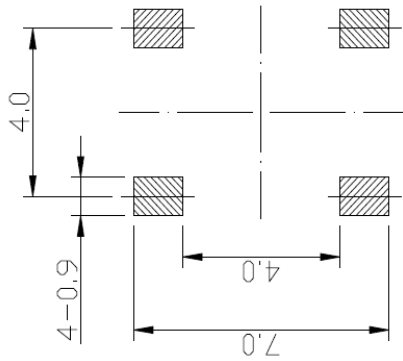

P.C.B LAND DIMENSION

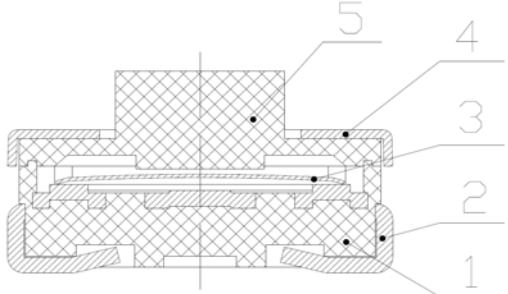
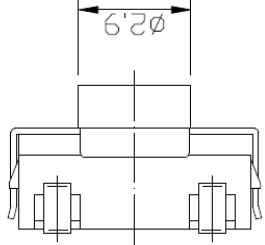
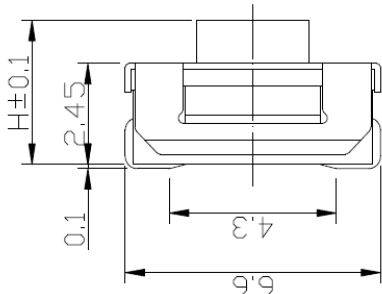

Stem Color	XX
Blue	BL
White	WT

SPECIFICATIONS
 Rating: DC 12V 50mA
 Contact Resistance: 100m ohm max
 General Tolerance: ±0.3
 Contact Resistance: 100mΩ
 Insulation Resistance: 100MΩ
 Withstanding Voltage: 250V AC

Item	Name	Material	Finish
1	Base	Liquid Crystal Polymer	
2	Terminal	Brass	Ag Plating
3	Contact	Phosphor Bronze	Ag Plating
4	Cover	SUS 301	
5	Stem	Rubber	Blue or White

RoHS compliant

Rev.	Description	Date	Approved	Drawing	Name	Date
				Approved	Howard	10/14/11
				Checked	Lizzy	10/14/11
				Drawn	Tina	10/14/11
				0.0 ± 0.35	0.00 ± 0.20	Angles ± 3'
				UNIT: mm		

Central Components Manufacturing
 440 Lincoln Blvd., Middlesex, New Jersey 08846
 Phone 732 469-5720 888 288-5152 Fax 732 469-1919

Part No.: **SWT-KTJ-A06035-XX**

Description: Tactile Switch, Type KTJ-A06035