

Straight PCB, Series 109, Standard Density Connectors (MIL Qualified)

Material and Finish:

- Shell** — Steel, cadmium plated
- Insert** — Approved material per MIL-DTL-24308
- Contact** — Copper alloy plated gold over nickel underplate*
- Spacer** — Aluminum alloy, Iridite finish

Related Product Data:

- Cavity Identification** — page 5101
- Mounting, Mating Specifications** — page 5143
- Accessories** — pages 5148-5150
- PCB Layouts** — See page 5144 or AMP customer drawing.
- *Socket Body** — .000050 [0.00127] min. gold over .000050 [0.00127] min. nickel
- Mating Area** — .000050 [0.00127] min. gold over .000050 [0.00127] min. nickel
- Plug Body** — .000050 [0.00127] min. gold over .000050 [0.00127] min. nickel

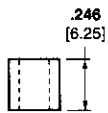

Spacer

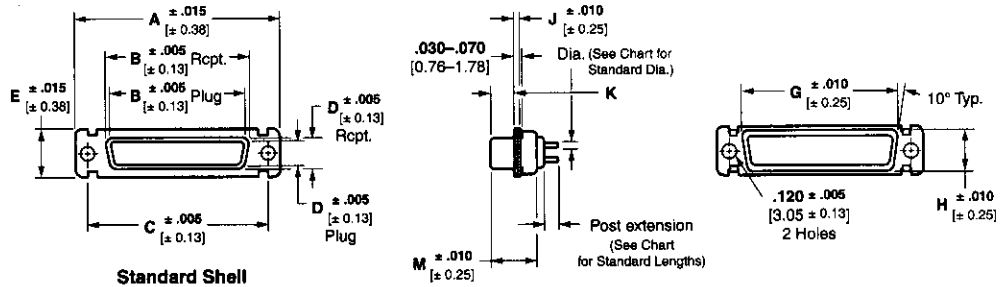

Standard Shell

MS Shell Size	Connector Style	Dimensions									
		A	B	C	D	E	G	H	J	K	M
1	Plug	1.213 30.81	.666 16.92	.984 24.99	.329 8.36	.494 12.55	.759 19.28	.422 10.72	.030 0.76	.238/.229 6.04/5.81	.422 10.72
	Receptacle	1.213 30.81	.643 16.33	.984 24.99	.311 7.90	.494 12.55	.759 19.28	.422 10.72	.030 0.76	.248/.238 6.29/6.04	.429 10.90
2	Plug	1.541 39.14	.994 25.25	1.312 33.32	.329 8.36	.494 12.55	1.083 27.51	.422 10.72	.030 0.76	.238/.229 6.04/5.81	.422 10.72
	Receptacle	1.541 39.14	.971 24.66	1.312 33.32	.311 7.90	.494 12.55	1.083 27.51	.422 10.72	.030 0.76	.248/.238 6.29/6.04	.429 10.90
3	Plug	2.088 53.04	1.534 38.96	1.852 47.04	.329 8.36	.494 12.55	1.625 41.28	.422 10.72	.039 0.99	.236/.224 5.99/5.68	.426 10.82
	Receptacle	2.088 53.04	1.511 38.38	1.852 47.04	.311 7.90	.494 12.55	1.625 41.28	.422 10.72	.030 0.76	.248/.238 6.29/6.04	.429 10.90
4	Plug	2.729 69.32	2.182 55.42	2.500 63.5	.329 8.36	.494 12.55	2.272 57.71	.422 10.72	.039 0.99	.236/.224 5.99/5.68	.426 10.82
	Receptacle	2.729 69.32	2.159 54.84	2.500 63.5	.311 7.90	.494 12.55	2.272 57.71	.422 10.72	.030 0.76	.248/.238 6.29/6.04	.429 10.90
5	Plug	2.635 66.93	2.079 52.81	2.406 61.11	.441 11.20	.605 15.37	2.178 55.32	.534 13.56	.039 0.99	.236/.224 5.99/5.68	.426 10.82
	Receptacle	2.635 66.93	2.064 52.43	2.406 61.11	.423 10.74	.605 15.37	2.178 55.32	.534 13.55	.030 0.76	.248/.238 6.29/6.04	.429 10.90

Receptacle Assemblies

Shell Size	No. Pos.	Post Dia.	Post Ext. ±.020 [± 0.51]	Military Part No. M24308/	AMP Part No.
1	9	.030 0.76	.156 3.96	23-1F	443975-1
2	15	.030 0.76	.156 3.96	23-2F	443975-2
3	25	.030 0.76	.156 3.96	23-3F	443975-3
4	37	.030 0.76	.156 3.96	23-4F	443975-4
5	50	.030 0.76	.156 3.96	23-5F	443975-5
1	9	.030 0.76	.188 4.78	23-7F	443976-1
2	15	.030 0.76	.188 4.78	23-8F	443976-2
3	25	.030 0.76	.188 4.78	23-9F	443976-3
4	37	.030 0.76	.188 4.78	23-10F	443976-4
5	50	.030 0.76	.188 4.78	23-11F	443976-5
1	9	.040 1.02	.156 3.96	23-13F	443977-1
2	15	.040 1.02	.156 3.96	23-14F	443977-2
3	25	.040 1.02	.156 3.96	23-15F	443977-3
4	37	.040 1.02	.156 3.96	23-16F	443977-4
5	50	.040 1.02	.156 3.96	23-17F	443977-5
1	9	.040 1.02	.188 4.78	23-19F	443978-1
2	15	.040 1.02	.188 4.78	23-20F	443978-2
3	25	.040 1.02	.188 4.78	23-21F	443978-3
4	37	.040 1.02	.188 4.78	23-22F	443978-4
5	50	.040 1.02	.188 4.78	23-23F	443978-5

Plug Assemblies

Shell Size	No. Pos.	Post Dia.	Post Ext. ±.020 [± 0.51]	Military Part No. M24308/	AMP Part No.
1	9	.030 0.76	.156 3.96	24-1F	1218124-1
2	15	.030 0.76	.156 3.96	24-2F	1218124-2
3	25	.030 0.76	.156 3.96	24-3F	1218124-3
4	37	.030 0.76	.156 3.96	24-4F	1218124-4
5	50	.030 0.76	.156 3.96	24-5F	1218124-5
1	9	.030 0.76	.188 4.78	24-7F	1218125-1
2	15	.030 0.76	.188 4.78	24-8F	1218125-2
3	25	.030 0.76	.188 4.78	24-9F	1218125-3
4	37	.030 0.76	.188 4.78	24-10F	1218125-4
5	50	.030 0.76	.188 4.78	24-11F	1218125-5
1	9	.040 1.02	.156 3.96	24-13F	1218126-1
2	15	.040 1.02	.156 3.96	24-14F	1218126-2
3	25	.040 1.02	.156 3.96	24-15F	1218126-3
4	37	.040 1.02	.156 3.96	24-16F	1218126-4
5	50	.040 1.02	.156 3.96	24-17F	1218126-5
1	9	.040 1.02	.188 4.78	24-19F	1218127-1
2	15	.040 1.02	.188 4.78	24-20F	1218127-2
3	25	.040 1.02	.188 4.78	24-21F	1218127-3
4	37	.040 1.02	.188 4.78	24-22F	1218127-4
5	50	.040 1.02	.188 4.78	24-23F	1218127-5