

## High-frequency Power Ceramic Capacitors

Small Size Feed-thru Type DC6 Series

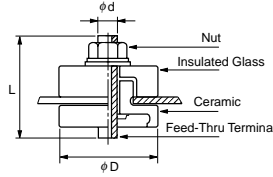

Part Number	Cap. (pF)	Cap. Tol. (%)	DC Rated Volt. (kV)	DC Test Volt. (kV)	Dimensions (mm)			Torque (N·m)
					ϕ D	L	ϕ d	
DC6F33G502PE2B	5000	+100 - 0	4	6	60	48	8	0.5
DC6F33D502PE1B	5000	+100 - 0	2	3	40	48	8	0.3

Operating Temp. Range : -10 to +75°C

## Ceramic Trimmer Capacitors

### ● TZY2 Series

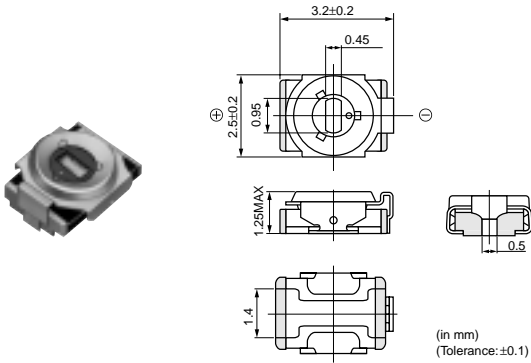

Part Number	Cmin. (pF)	Cmax. (pF)	TC	Q	Rated Voltage	Withstanding Voltage	Stator/Case Color
TZY2Z2R5A001	0.65 max.	2.5 +100/-0%	NP0±300ppm/°C	200min. at 200MHz, Cmax.	25Vdc	55Vdc	White
TZY2Z030A001	1.5 max.	3.0 +100/-0%	NP0±300ppm/°C	300min. at 1MHz, Cmax.	25Vdc	55Vdc	Light green
TZY2Z060A001	2.5 max.	6.0 +100/-0%	NP0±300ppm/°C	500min. at 1MHz, Cmax.	25Vdc	55Vdc	Light green
TZY2Z100A001	3.0 max.	10.0 +100/-0%	NP0±300ppm/°C	500min. at 1MHz, Cmax.	25Vdc	55Vdc	Light green
TZY2R200A001	4.5 max.	20.0 +100/-0%	N750±500ppm/°C	500min. at 1MHz, Cmax.	25Vdc	55Vdc	Brown
TZY2R250A001	5.5 max.	25.0 +100/-0%	N750±500ppm/°C	300min. at 1MHz, Cmax.	25Vdc	55Vdc	Brown
TZY2K450A001	8.0 max.	45.0 +100/-0%	N1000±500ppm/°C	300min. at 1MHz, Cmax.	25Vdc	55Vdc	Light Brown

Insulation Resistance : 10000M ohm min. Torque : 0.5-5.0mNm Operating Temperature Range : -25-+85°C

## ● TZV2 Series

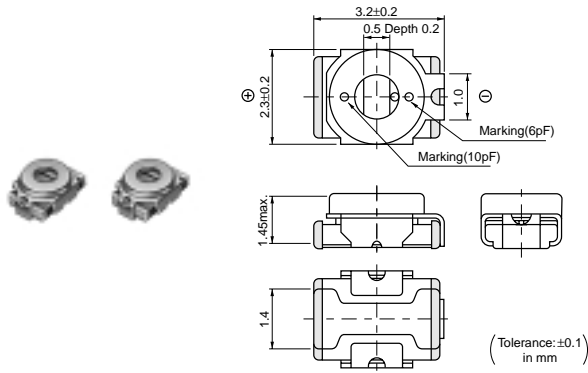

Part Number	Cmin. (pF)	Cmax. (pF)	TC	Q	Rated Voltage	Withstanding Voltage	Stator/Case Color
TZV2Z2R5A110	0.65 max.	2.5 +100/-0%	NP0±300ppm/°C	200min. at 200MHz, Cmax.	25Vdc	55Vdc	White
TZV2Z030A110	1.5 max.	3.0 +100/-0%	NP0±300ppm/°C	300min. at 1MHz, Cmax.	25Vdc	55Vdc	LightGreen
TZV2Z060A110	2.5 max.	6.0 +100/-0%	NP0±300ppm/°C	500min. at 1MHz, Cmax.	25Vdc	55Vdc	LightGreen+Marking
TZV2Z100A110	3.0 max.	10.0 +100/-0%	NP0±300ppm/°C	500min. at 1MHz, Cmax.	25Vdc	55Vdc	LightGreen+Marking
TZV2R200A110	4.5 max.	20.0 +100/-0%	N750±500ppm/°C	500min. at 1MHz, Cmax.	25Vdc	55Vdc	Brown

Insulation Resistance : 10000M ohm min. Torque : 1.0~10.0mNm Operating Temperature Range : -25~+85°C

## ● TZS2 Series

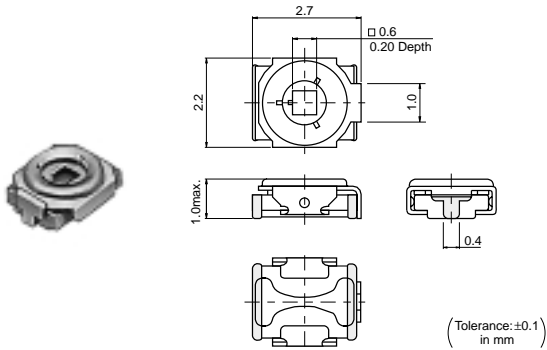

Part Number	Cmin. (pF)	Cmax. (pF)	TC	Q	Rated Voltage	Withstanding Voltage	Stator/Case Color
TZS2Z060A001	3.0 max.	6.0 +100/-0%	NP0±300ppm/°C	500min. at 1MHz, Cmax.	25Vdc	55Vdc	Light Green
TZS2Z100A001	3.5 max.	10.0 +100/-0%	NP0±300ppm/°C	500min. at 1MHz, Cmax.	25Vdc	55Vdc	Light Green
TZS2R200A001	7.0 max.	20.0 +100/-0%	N750±500ppm/°C	500min. at 1MHz, Cmax.	25Vdc	55Vdc	Brown

Insulation Resistance : 10000M ohm min. Torque : 0.5~5.0mNm Operating Temperature Range : -25~+85°C

## ● TZC3 Series

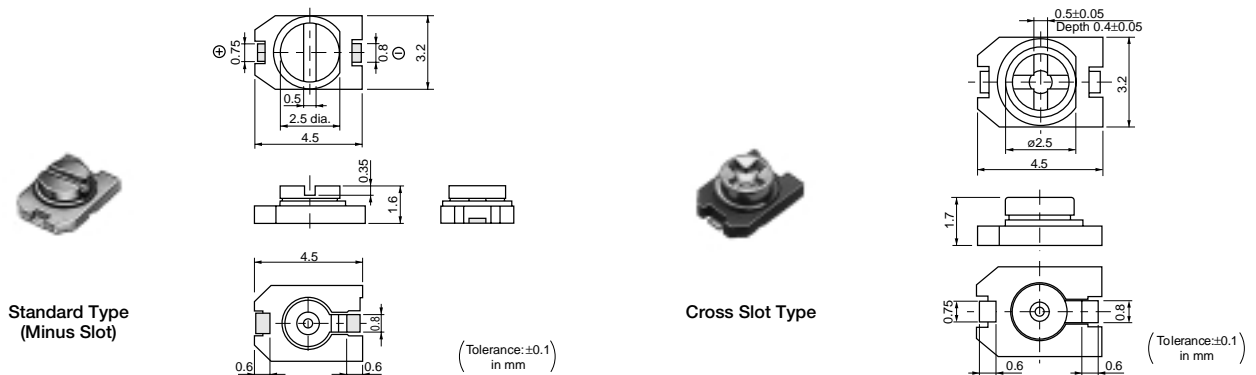

Part Number	Cmin. (pF)	Cmax. (pF)	TC	Q	Rated Voltage	Withstanding Voltage	Stator/Case Color
TZC3Z030A□□□	1.4 max.	3.0 +50/-0%	NP0±300ppm/°C	300min. at 1MHz, Cmax.	100Vdc	220Vdc	Brown
TZC3Z060A□□□	2.0 max.	6.0 +50/-0%	NP0±300ppm/°C	500min. at 1MHz, Cmax.	100Vdc	220Vdc	Blue
TZC3R100A□□□	3.0 max.	10.0 +50/-0%	N750±300ppm/°C	500min. at 1MHz, Cmax.	100Vdc	220Vdc	White
TZC3P200A□□□	5.0 max.	20.0 +50/-0%	N1200±500ppm/°C	300min. at 1MHz, Cmax.	100Vdc	220Vdc	Red
TZC3P300A□□□	6.5 max.	30.0 +50/-0%	N1200±500ppm/°C	300min. at 1MHz, Cmax.	100Vdc	220Vdc	Green

Insulation Resistance : 10000M ohm min. Torque : 1.5~10.0mNm Operating Temperature Range : -25~+85°C  
The last three digits show the slot type. 110:standard(minus) type, 310:plus type.

● TZB4 Series

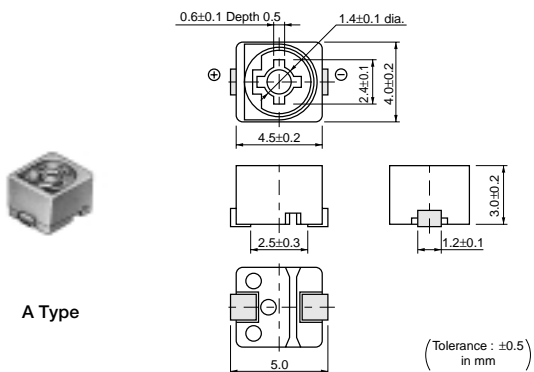

A Type

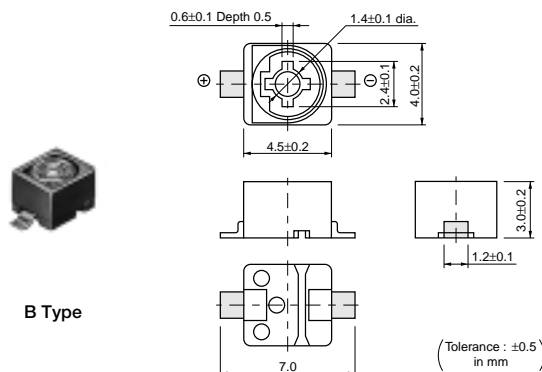

B Type

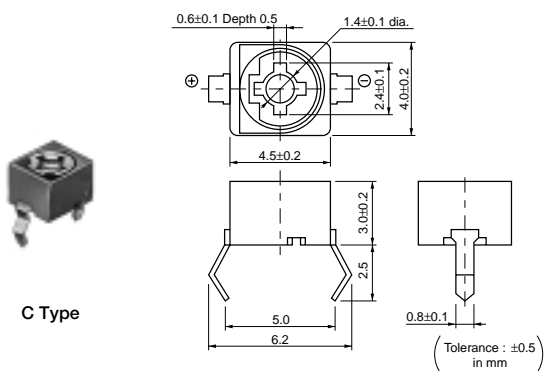

C Type

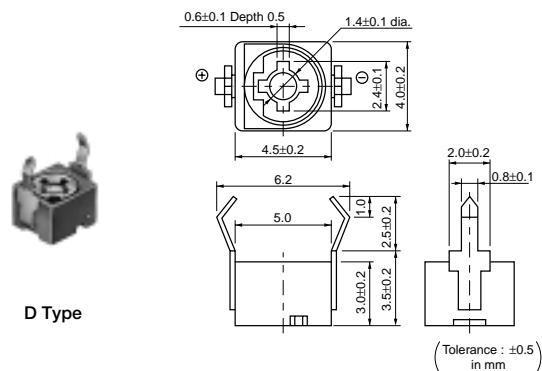

D Type

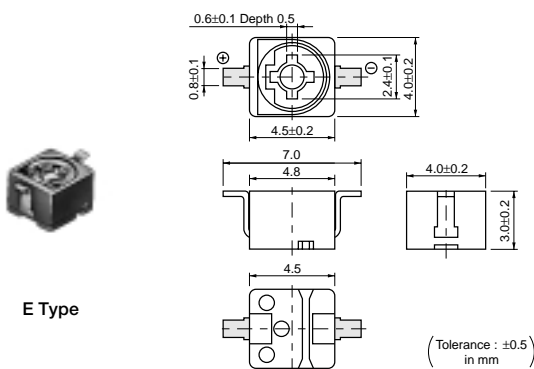

E Type

Part Number	Cmin. (pF)	Cmax. (pF)	TC	Q	Rated Voltage	Withstanding Voltage	Stator/Case Color
TZB4Z030□□10	1.4 max.	3.0 +50/-0%	NP0±200ppm/°C	300min. at 1MHz, Cmax	100Vdc	220Vdc	Brown
TZB4Z060□□10	2.0 max.	6.0 +50/-0%	NP0±200ppm/°C	500min. at 1MHz, Cmax.	100Vdc	220Vdc	Blue
TZB4Z100□□10	3.0 max.	10.0 +50/-0%	NP0±300ppm/°C	500min. at 1MHz, Cmax.	100Vdc	220Vdc	White
TZB4R200□□10	4.5 max.	20.0 +50/-0%	N750±300ppm/°C	500min. at 1MHz, Cmax	100Vdc	220Vdc	Red
TZB4P300□□10	6.5 max.	30.0 +50/-0%	N1200±500ppm/°C	300min. at 1MHz, Cmax	100Vdc	220Vdc	Green

Continued on the following page.

Continued from the preceding page.

Part Number	Cmin. (pF)	Cmax. (pF)	TC	Q	Rated Voltage	Withstanding Voltage	Stator/Case Color
TZB4P400□□10	8.5 max.	40.0 +50/-0%	N1200±500ppm/°C	300min. at 1MHz, Cmax	100Vdc	220Vdc	Yellow
TZB4Z250□□10	4.0 max.	25.0 +100/-0%	NP0±300ppm/°C	300min. at 1MHz, Cmax.	50Vdc	110Vdc	Black+Marking
TZB4R500□□10	7.0 max.	50.0 +100/-0%	N750±300ppm/°C	300min. at 1MHz, Cmax	50Vdc	110Vdc	Black+Marking

Insulation Resistance : 10000M ohm min. Torque : 1.5~10.0mNm Operating Temperature Range : -25~+85°C  
Two blank columns are filled with cover film codes(A: not provided, B: provided) and terminal type codes.

● TZ03 Series

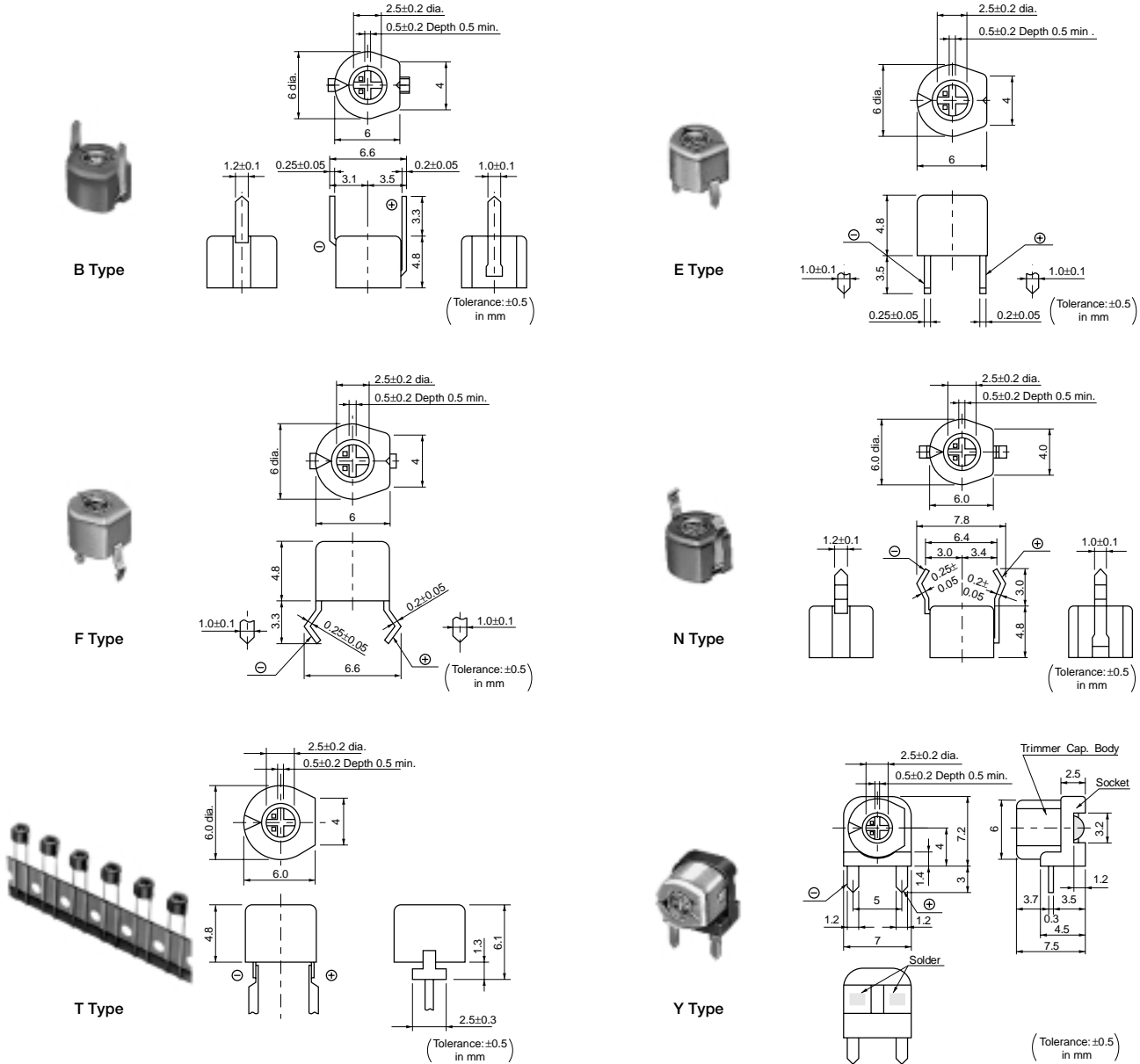

Part Number	Cmin. (pF)	Cmax. (pF)	TC	Q	Rated Voltage	Withstanding Voltage	Stator/Case Color
TZ03Z2R3□169	1.25 max.	2.3 +50/-0%	NP0±200ppm/°C	300min. at 1MHz, Cmax.	100Vdc	220Vdc	Black
TZ03Z050□169	1.5 max.	5.0 +50/-0%	NP0±200ppm/°C	500min. at 1MHz, Cmax.	100Vdc	220Vdc	Blue
TZ03Z070□169	2.0 max.	7.0 +50/-0%	NP0±200ppm/°C	500min. at 1MHz, Cmax.	100Vdc	220Vdc	Blue
TZ03N100□169	2.1 max.	10.0 +50/-0%	N200±200ppm/°C	500min. at 1MHz, Cmax.	100Vdc	220Vdc	White
TZ03Z100□169	2.7 max.	10.0 +50/-0%	NP0±200ppm/°C	500min. at 1MHz, Cmax.	100Vdc	220Vdc	Blue
TZ03T110□169	3.0 max.	11.0 +50/-0%	N450±300ppm/°C	500min. at 1MHz, Cmax.	100Vdc	220Vdc	White
TZ03R200□169	4.2 max.	20.0 +50/-0%	N750±300ppm/°C	500min. at 1MHz, Cmax.	100Vdc	220Vdc	Red

Continued on the following page.

Continued from the preceding page.

Part Number	Cmin. (pF)	Cmax. (pF)	TC	Q	Rated Voltage	Withstanding Voltage	Stator/Case Color
TZ03T200□169	4.2 max.	20.0 +50/-0%	N450±300ppm/°C	500min. at 1MHz, Cmax.	100Vdc	220Vdc	Pink
TZ03R300□169	5.2 max.	30.0 +50/-0%	N750±300ppm/°C	500min. at 1MHz, Cmax.	100Vdc	220Vdc	Green
TZ03P450□169	6.8 max.	45.0 +50/-0%	N1200±500ppm/°C	300min. at 1MHz, Cmax.	100Vdc	220Vdc	Yellow
TZ03P600□169	9.8 max.	60.0 +50/-0%	N1200±500ppm/°C	300min. at 1MHz, Cmax.	100Vdc	220Vdc	Brown
TZ03Z500□169	6.0 max.	50.0 +100/-0%	NP0±300ppm/°C	300min. at 1MHz, Cmax.	50Vdc	110Vdc	Orange
TZ03R900□169	9.0 max.	90.0 +100/-0%	N750±300ppm/°C	300min. at 1MHz, Cmax.	50Vdc	110Vdc	Black+Dot
TZ03R121□169	10.0 max.	120.0 +100/-0%	N750±300ppm/°C	300min. at 1MHz, Cmax.	50Vdc	110Vdc	Black

Insulation Resistance : 10000M ohm min. Torque : 2.0~15.0mNm Operating Temperature Range : -25~+85°C  
A blank column is filled with terminal type codes.

## C Networks

### ● 4 Elements BXXC Series

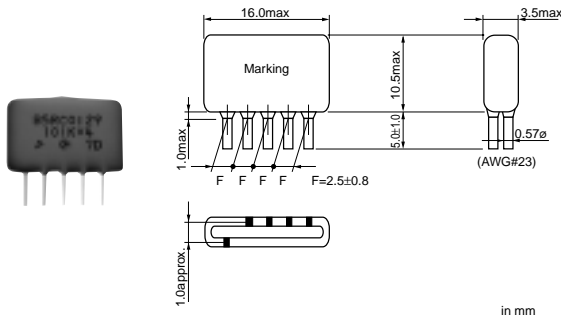

Part Number	Number of Elements	Capacitance (pF)	Cap. Tolerance (%)	TC Code	Rated Voltage (Vdc)
B5RC0129-33N	4	100	±10	Y5P	50
B5RC0128-33N	4	220	±10	Y5P	50
B5RC0122-33N	4	330	±20	Y5P	50
B5RC0123-33N	4	470	±20	Y5P	50
B5RC0135-33N	4	560	±20	Y5P	50
B5RC0124-33N	4	1000	±20	Y5P	50
B5RC0125-33N	4	2200	±20	Y5T	50
B5RC0126-33N	4	4700	+80,-20	FZ	50
B5RC0127-65N	4	10000	+80,-20	FZ	50

### ● 6 Elements BXXC Series

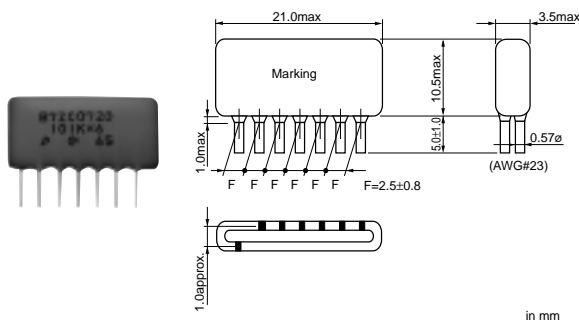

Part Number	Number of Elements	Capacitance (pF)	Cap. Tolerance (%)	TC Code	Rated Voltage (Vdc)
B7ZC0720-33N	6	100	±10	Y5P	50
B7ZC0713-33N	6	220	±10	Y5P	50
B7ZC0719-33N	6	330	±20	Y5P	50
B7ZC0717-33N	6	470	±20	Y5P	50
B7ZC0718-33N	6	560	±20	Y5P	50
B7ZC0716-33N	6	1000	±20	Y5P	50
B7ZC0715-33N	6	2200	±20	Y5T	50
B7ZC0714-33N	6	4700	+80,-20	FZ	50
B7ZC0711-65N	6	10000	+80,-20	FZ	50

● 7 Elements BXXC Series

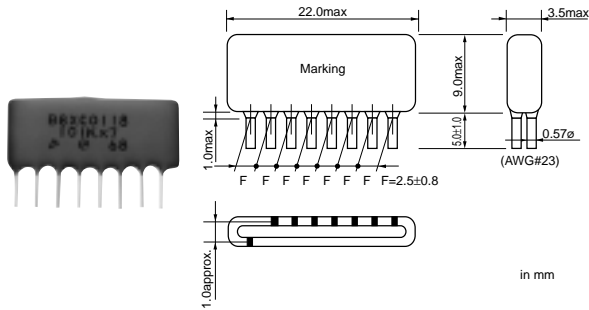

Part Number	Number of Elements	Capacitance (pF)	Cap. Tolerance (%)	TC Code	Rated Voltage (Vdc)
B8XC0118-33N	7	100	±10	Y5P	50
B8XC0117-33N	7	220	±10	Y5P	50
B8XC0116-33N	7	330	±20	Y5P	50
B8XC0119-33N	7	470	±20	Y5P	50
B8XC0115-33N	7	560	±20	Y5P	50
B8XC0114-33N	7	1000	±20	Y5P	50
B8XC0113-33N	7	2200	+40,-20	Y5U	50
B8XC0112-33N	7	4700	+80,-20	FZ	50

● 7 Elements B8ZC Series

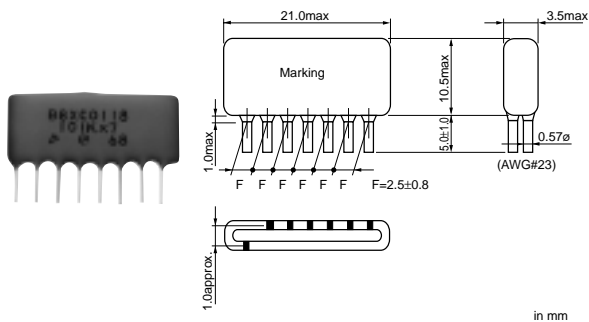

Part Number	Number of Elements	Capacitance (pF)	Cap. Tolerance (%)	TC Code	Rated Voltage (Vdc)
B8ZC0111-33N	7	8200	+80,-20	FZ	50

● 8 Elements BXXC Series

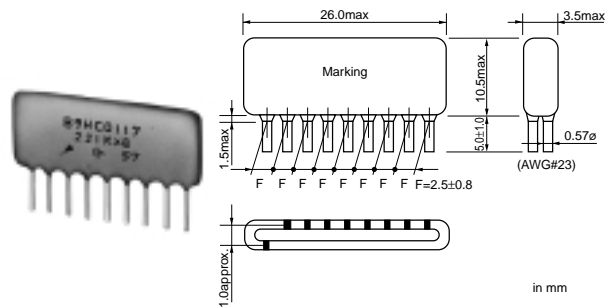

Part Number	Number of Elements	Capacitance (pF)	Cap. Tolerance (%)	TC Code	Rated Voltage (Vdc)
B9HC0118-33N	8	100	±10	Y5P	50
B9HC0117-33N	8	220	±10	Y5P	50
B9HC0119-33N	8	330	±20	Y5P	50
B9HC0115-33N	8	470	±20	Y5P	50
B9HC0116-33N	8	560	±20	Y5P	50
B9HC0114-33N	8	1000	±20	Y5P	50
B9HC0113-33N	8	2200	+40,-20	Y5U	50

● Low-Profile CGSD Series

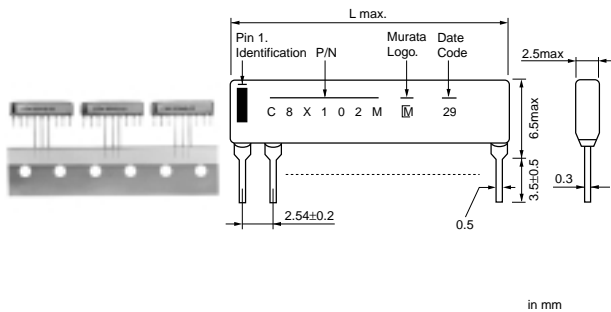

Part Number	Number of Elements	Capacitance (pF)	Cap. Tolerance (%)	TC Code	Rated Voltage (Vdc)
CGSD4X101M-T21	4	100	±20	Y5P	50
CGSD4X221M-T21	4	220	±20	Y5P	50
CGSD4X331M-T21	4	330	±20	Y5P	50
CGSD4X102M-T21	4	1000	±20	Y5R	50
CGSD4X222M-T21	4	2200	±20	Y5R	50
CGSD4X103N-T21	4	10000	±30	Y5R	16
CGSD6X101M-T21	6	100	±20	Y5P	50
CGSD6X221M-T21	6	220	±20	Y5P	50
CGSD6X331M-T21	6	330	±20	Y5P	50
CGSD6X102M-T21	6	1000	±20	Y5R	50
CGSD6X222M-T21	6	2200	±20	Y5R	50
CGSD6X103N-T21	6	10000	±30	Y5R	16
CGSD8X101M-T21	8	100	±20	Y5P	50
CGSD8X221M-T21	8	220	±20	Y5P	50
CGSD8X331M-T21	8	330	±20	Y5P	50
CGSD8X102M-T21	8	1000	±20	Y5R	50
CGSD8X222M-T21	8	2200	±20	Y5R	50
CGSD8X103N-T21	8	10000	±30	Y5R	16