

PLEASE CHECK WWW.MOLEX.COM FOR LATEST PART INFORMATION

Part Number: [0190690057](#)
Status: **Active**
Overview: [Solderless Terminals](#)
Description: [Krimptite Ring Tongue Terminal for 18-22 AWG Wire](#)

Documents:

[3D Model](#) [Product Specification PS-19902-011-001 \(PDF\)](#)
[Drawing \(PDF\)](#) [RoHS Certificate of Compliance \(PDF\)](#)
[3D Model \(PDF\)](#)

Agency Certification

CSA LR18689
 UL E32244

General

Product Family [Ring and Spade Terminals](#)
 Series [19069](#)
 Crimp Quality Equipment [Yes](#)
 Overview [Solderless Terminals](#)
 Product Name [Krimptite](#)
 Taxonomy [Ring and Spade Terminals](#)
 Type [Ring](#)
 UPC [800753067844](#)

Physical

Barrel Type [Closed](#)
 Insulation [None](#)
 Material - Plating Mating [Tin](#)
 Material - Plating Termination [Tin](#)
 Net Weight [0.302/g](#)
 Packaging Type [Adhesive Tape on Reel](#)
 Plating min - Mating [2.540µm](#)
 Plating min - Termination [2.540µm](#)
 Stud Size [8 \(M4\)](#)
 Termination Interface: Style [Crimp or Compression](#)
 Wire Size AWG [18, 20, 22](#)
 Wire Size mm² [0.35-0.80](#)

Solder Process Data

Lead-freeProcess Capability [N/A](#)

Material Info

Engineering Number [AA-132-08T](#)

Reference - Drawing Numbers

Product Specification [PS-19902-011-001](#)
 Sales Drawing [SD-19069-004-001](#)

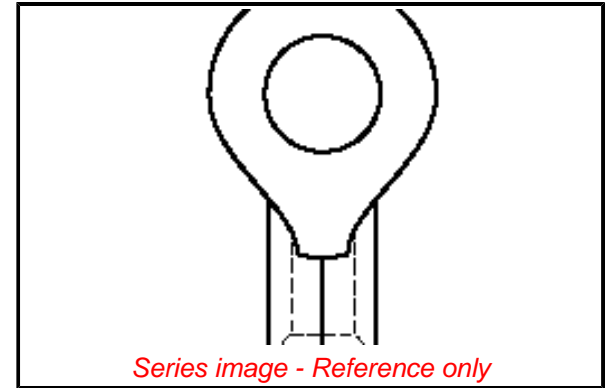

Series image - Reference only

EU ELV

Not Relevant

EU RoHS

Compliant

REACH SVHC

Not Contained per -
 D(2022)9120-DC (17
 Jan 2023)

Halogen-Free

Status

Low-Halogen

For more information, please visit [Contact US](#)

China ROHS

ELV

RoHS Phthalates

China RoHS

Green Image

Not Relevant

Not Contained

Search Parts in this Series

[19069 Series](#)

Application Tooling | FAQ

Tooling specifications and manuals are found by selecting the products below. Crimp Height Specifications are then contained in the Application Tooling Specification document.

Global

Description

Product #

ATP Crimp Dies [190270034](#)

for the Tape Crimp

Module and ATP-101

& 301 Press

Mini-Mac Applicator [638853800](#)