

PRODUCT DATA DRAWING

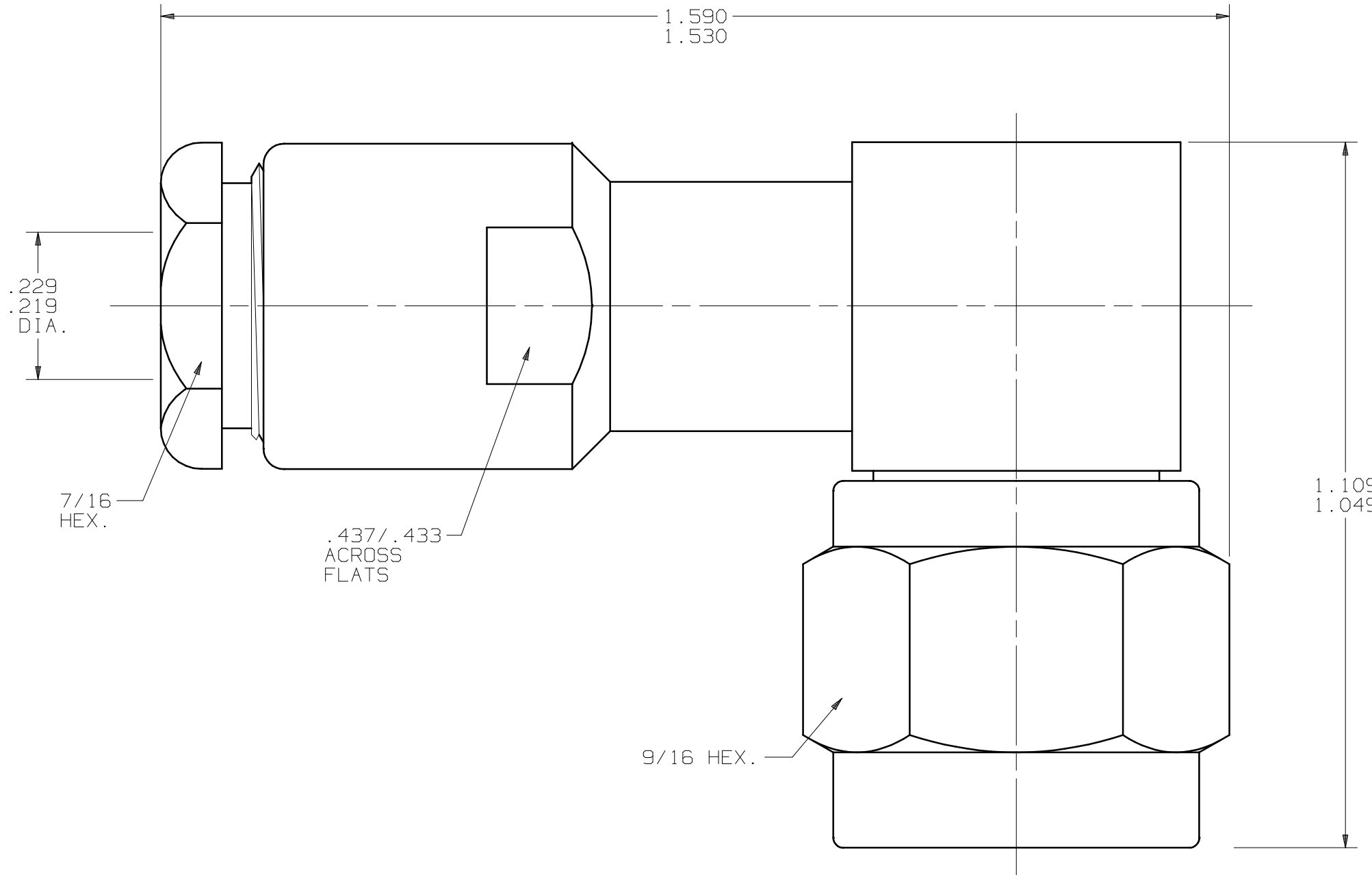

MATERIAL:

BODIES,
CLAMP,
SLEEVE,
WASHER,
BUSHING
CLAMP NUT,
COUPLING NUT: STAINLESS STEEL PER ASTM-A-479,
ALLOY UNS-S31600, COND A.

CONTACTS: BERYLLIUM COPPER PER STM-B-196,
ALLOY C17300, COND TD04.

LOCK RING: PHOSPHOR BRONZE PER ASTM-B-159,
ALLOY 51000, TEMPER H08.

INSULATORS: PTFE PER ASTM-D-1710.

GASKETS: SILICONE RUBBER PER ZZ-R-765,
CLASS II, GRADE 50/60.

FINISH:

BODIES,
CLAMP,
SLEEVE,
WASHER,
BUSHING
CLAMP NUT,
COUPLING NUT: PASSIVATED PER QQ-P-35, TYPE II.

CONTACTS: GOLD PER MIL-G-45204, TYPE I,
GRADE C, CLASS 1; OVER NICKEL
PER QQ-N-290 CLASS 1.

PERFORMANCE:

IMPEDANCE: 50 OHMS
DWV: 1500 VRMS
FREQ. RANGE: DC-15.0 GHz
INSUL. RES.: 5000 MEGOHMS, MIN.

SYM.	DESCRIPTION	DATE	APPR.	UNLESS OTHERWISE SPECIFIED: 1) ALL DIMENSIONS ARE AFTER PLATING. 2) BREAK CORNERS & EDGES .005 R. MAX. 3) CHAM. 1st & LAST THDS. 4) SURFACE ROUGHNESS 63 J MIL-STD-10. 5) DIAS. ON COMMON CENTERS TO BE CONCENTRIC WITHIN .005 T.I.R. 6) REMOVE ALL BURRS.	DIMENSIONS ARE IN INCHES			SV Microwave, Inc. 2400 Centrepark West Drive, Suite 100 West Palm Beach, FL 33409 TITLE: PTNC PLUG CUBED RIGHT ANGLE FOR RG-142/U CABLE DWG. NO. SF4515-6003
					TOLERANCES:			
					DECIMALS	FRACTIONAL	ANGULAR	
					.X ±.030		X° ±1°0'	
.XX ±.015	±1/64	X°X' ±15'						
.XXX ±.005								
	MATERIAL: PER BOM	□" AREA:						
	FINISH: PER BOM	N/A						
		SIZE	CAGE NO.	SCALE				
		B	95077	5X				
		APPROVED: STW 11/01/02						