

MATERIALS AND FINISHES:

BODY & HOUSING: BRASS
 PLATED: GOLD (30µ-in MIN)
 OVER NICKEL (100µ-in MIN)

CONTACT: BERYLLIUM COPPER
 PLATED: GOLD (30µ-in MIN)
 OVER NICKEL (100µ-in MIN)

INSULATOR: PTFE

PACKAGE PER TABLE

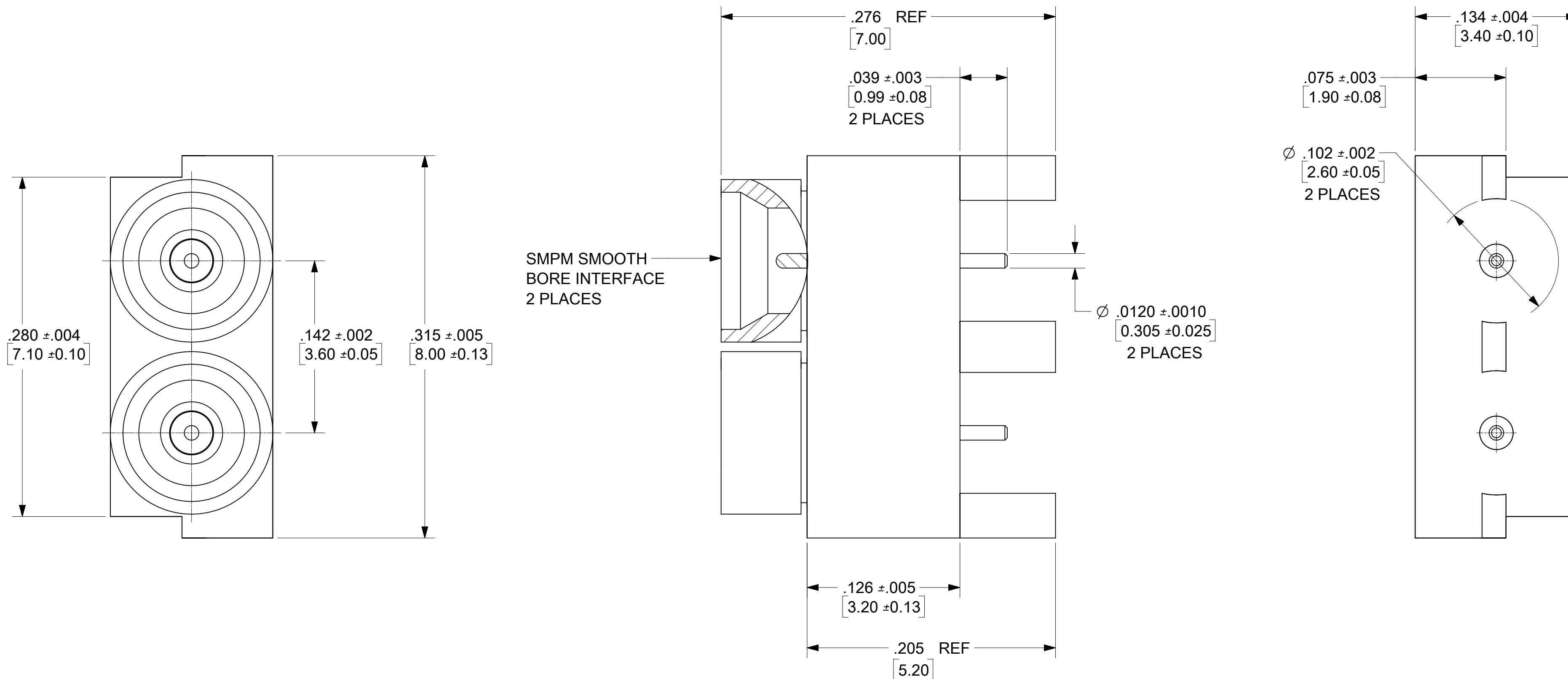
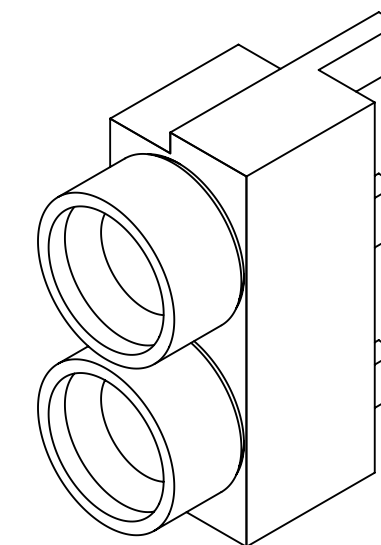

| | | | |
|------------|-------------|--------------------------|---------------|
| 73300-5061 | TAPE & REEL | PS-89675-3730 | PRODUCT SPEC. |
| 73300-5060 | TRAY | MIL-STD-348B, FIG. 328.3 | INTERFACE |
| PART NO. | PACKAGING | SPECIFICATION | DESCRIPTION |

THIS DRAWING CONTAINS INFORMATION THAT IS PROPRIETARY TO MOLEX ELECTRONIC TECHNOLOGIES, LLC AND SHOULD NOT BE USED WITHOUT WRITTEN PERMISSION

| | | | | | | | |
|-----------------|---|--|--------|-----------------|------------------------|---|---|
| QUALITY SYMBOLS | 2017/03/24 2017/04/05 REVISED EC NO: 114048 DRWN: RYEH CHKD: APPR: YCHENG | GENERAL TOLERANCES (UNLESS SPECIFIED) | | DIMENSION UNITS | SCALE | | |
| | | | | INCH | NTS | | |
| ▽ = 0 | | MM | INCH | DRWN BY | DATE | | DUAL SMPM PLUG 50 OHMS SMOOTH BORE EDGE LAUNCH SMPM-P/PCB EWR-10146-B |
| ▽ = 0 | | 4 PLACES ± | ± | B SHAH | 2015/09/09 | | |
| ▽ = 0 | | 3 PLACES ± | ± 0.01 | CHK'D BY | DATE | | |
| ▽ = 0 | | 2 PLACES ± | ± 0.25 | PSWAMI02 | 2016/12/07 | PRODUCT CUSTOMER DRAWING | |
| ▽ = 0 | | 1 PLACES ± | ± | APPR BY | DATE | | |
| ▽ = 0 | | 0 PLACES ± | ± | AROBERTSON | 2015/09/09 | SERIES: 73300 MATERIAL NUMBER: SEE TABLE CUSTOMER: | |
| ▽ = 0 | | ANGULAR TOL = 2.0 | | DRAWING SIZE | THIRD ANGLE PROJECTION | DOCUMENT NUMBER: SD-73300-506 DOC TYPE: PSD DOC PART: 000 SHEET NUMBER: 1 OF 4 | |
| ▽ = 0 | | DRAFT WHERE APPLICABLE MUST REMAIN WITHIN DIMENSIONS | | C | | | |

| | |
|----------------|--------------|
| RELEASE STATUS | RELEASE DATE |
| 12 | 11 |

NOTES

- 1) THE COPPER IS 0.005"/0.127mm FROM THE PCB EDGE. FOR PRODUCTION RUNS, MANY PCB HOUSES WILL REQUIRE A SPACING OF 0.010"/0.254mm FROM COPPER TO THE EDGE. THIS DRAWING IS A COMPROMISE BETWEEN PRODUCTION NEEDS AND OPTIMAL PERFORMANCE.
- 2) THE TRACEWIDTH SHOWN AS TBD SHOULD BE SET BY THE CUSTOMER IN ORDER TO MEET IMPEDANCE REQUIREMENTS.
- 3) THE PADS ARE RECOMMENDATIONS FOR OPENINGS IN THE SOLDERMASK. COPPER MAY EXTEND BEYOND THE PADS SHOWN. PINNING VIAS TO GROUND MUST ALSO BE ADDED AS NEEDED BY THE CUSTOMER.

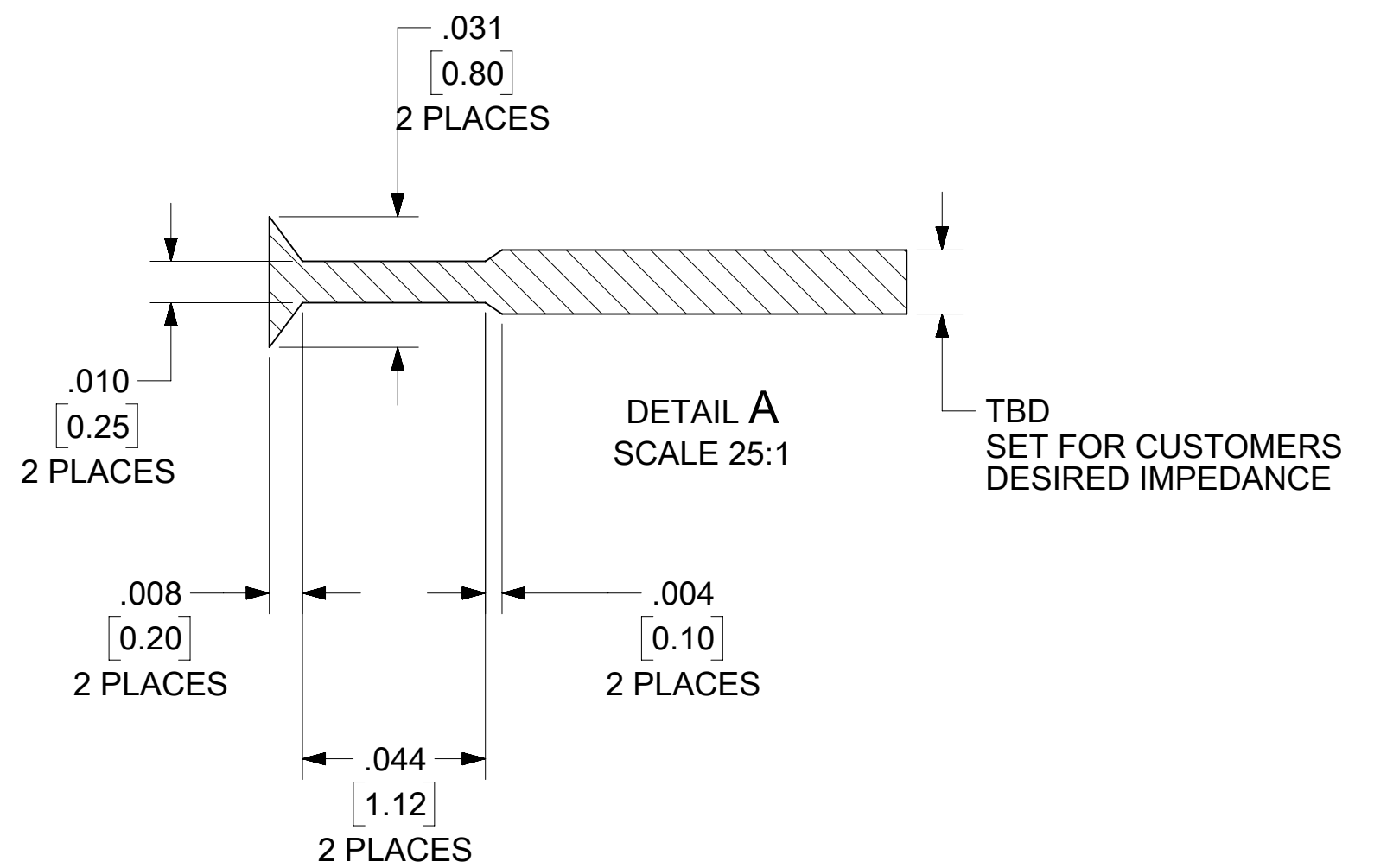
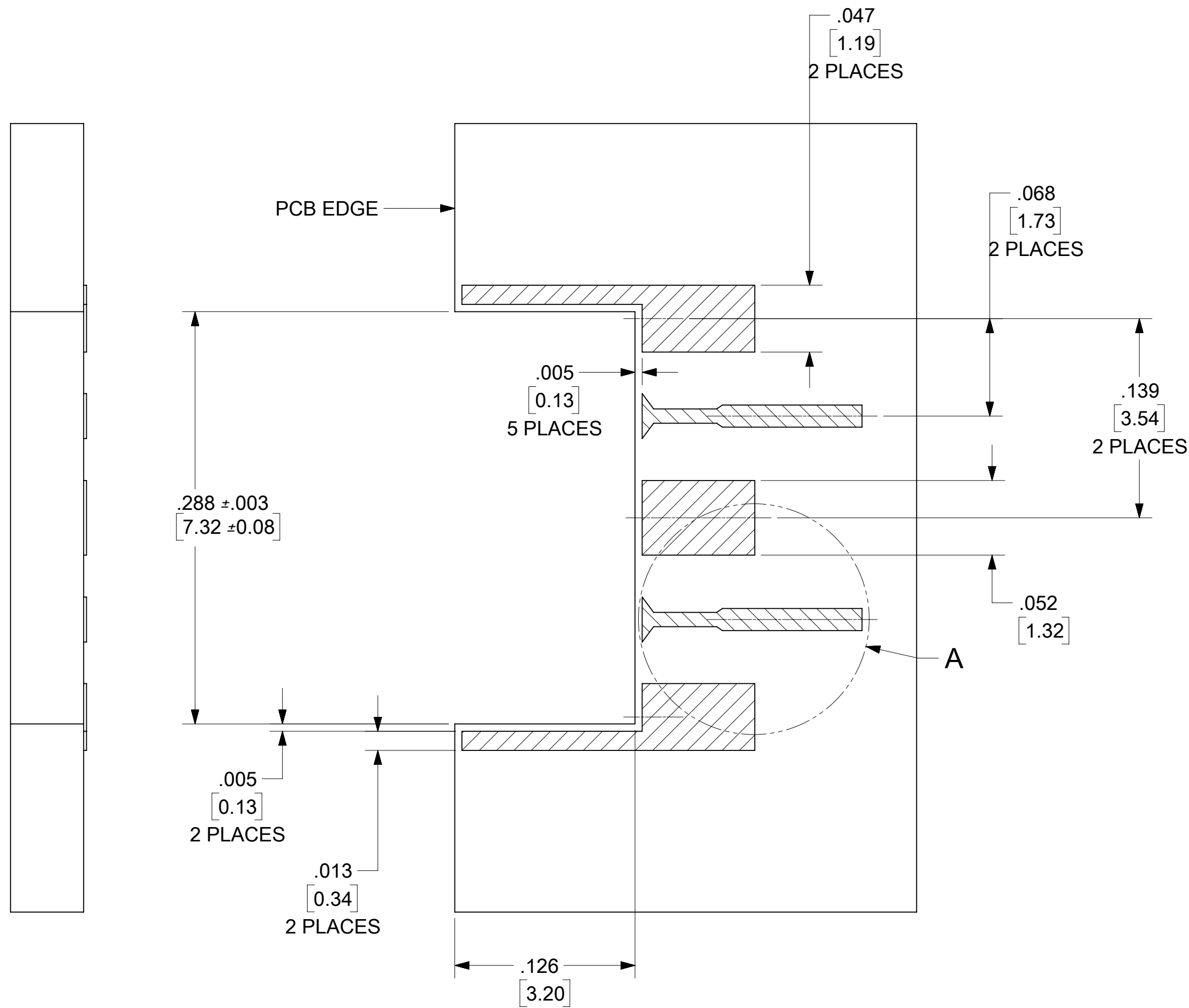

| | | | | |
|---|---|---|---|--|
| QUALITY SYMBOLS | THIS DRAWING CONTAINS INFORMATION THAT IS PROPRIETARY TO MOLEX ELECTRONIC TECHNOLOGIES, LLC AND SHOULD NOT BE USED WITHOUT WRITTEN PERMISSION | | | |
| | GENERAL TOLERANCES (UNLESS SPECIFIED) MM INCH 4 PLACES ± ± 3 PLACES ± ± 0.01 2 PLACES ± 0.25 ± 1 PLACES ± ± 0 PLACES ± ± | | DIMENSION UNITS SCALE INCH DRWN BY DATE BSHAH 2015/09/09 CHK'D BY DATE PSWAMI02 2016/12/07 APPR BY DATE AROBERTSON 2015/09/09 | |
| = 0 = 0 = 0 = 0 = 0 = 0 = 0 = 0 | DRAFT WHERE APPLICABLE MUST REMAIN WITHIN DIMENSIONS | | DRAWING SIZE THIRD ANGLE PROJECTION C | |
| | PRODUCT CUSTOMER DRAWING | | SERIES MATERIAL NUMBER CUSTOMER 73300 SEE TABLE | |
| DOCUMENT NUMBER DOC TYPE DOC PART SHEET NUMBER SD-73300-506 PSD 000 2 OF 4 | | MOLEX® DUAL SMPM PLUG 50 OHMS SMOOTH BORE EDGE LAUNCH SMPM-P/PCB EWR-10146-B | | |

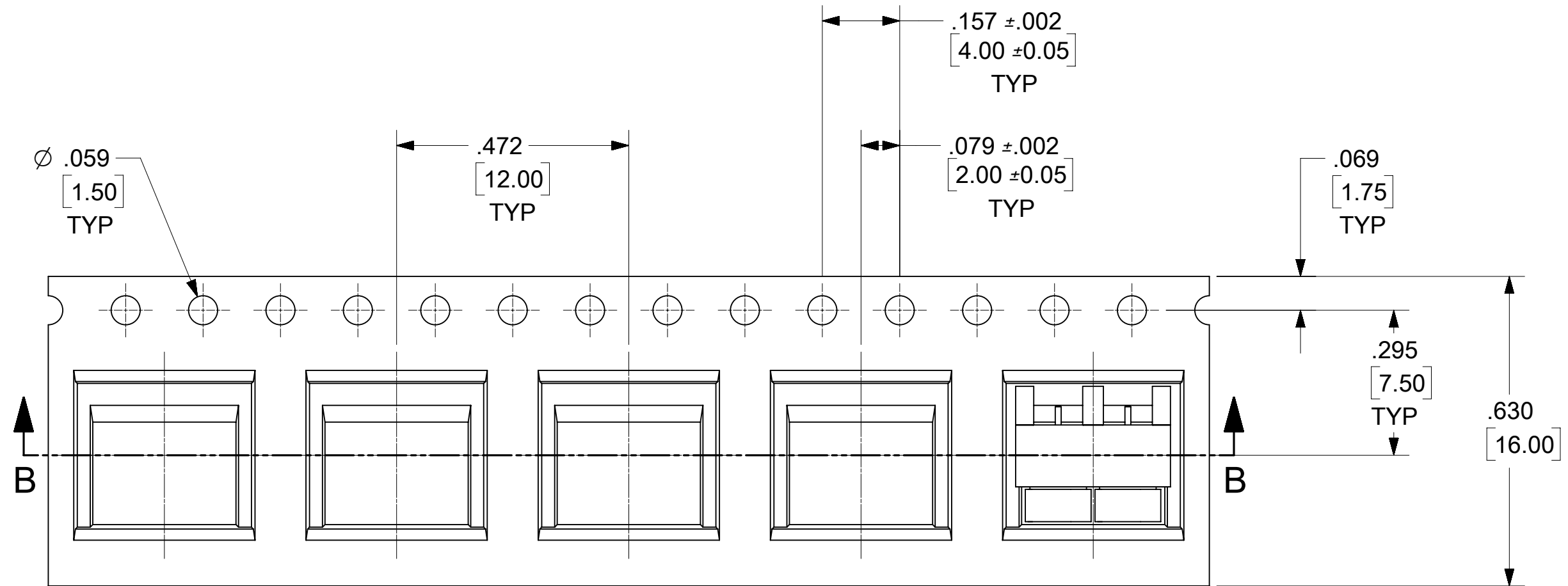

FOR 73300-5061 ONLY

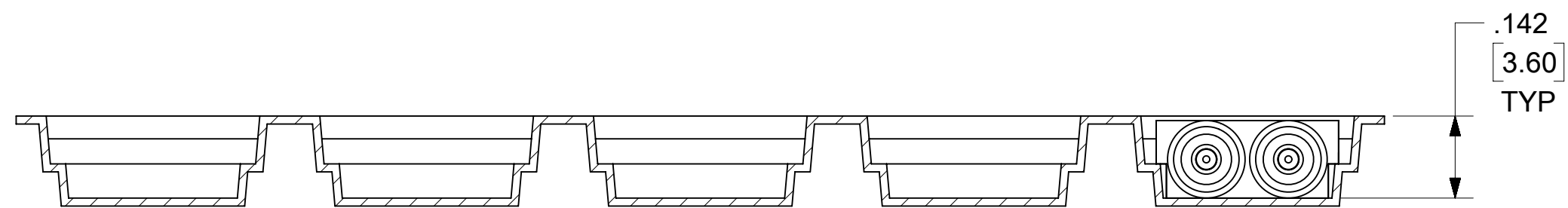

SECTION B-B

| | | | | | | | | | | | | | |
|-------------------|-------|---|-------|--------------|-------|------------------------|-------|---|-------|-----------------|---|---------------------------------------|--|
| QUALITY SYMBOLS | | THIS DRAWING CONTAINS INFORMATION THAT IS PROPRIETARY TO MOLEX ELECTRONIC TECHNOLOGIES, LLC AND SHOULD NOT BE USED WITHOUT WRITTEN PERMISSION | | | | | | | | | | | |
| ▽ = 0 | ▽ = 0 | ▽ = 0 | ▽ = 0 | ▽ = 0 | ▽ = 0 | ▽ = 0 | ▽ = 0 | ▽ = 0 | ▽ = 0 | ▽ = 0 | THIS DRAWING CONTAINS INFORMATION THAT IS PROPRIETARY TO MOLEX ELECTRONIC TECHNOLOGIES, LLC AND SHOULD NOT BE USED WITHOUT WRITTEN PERMISSION | | |
| | | | | | | | | | | | | GENERAL TOLERANCES (UNLESS SPECIFIED) | |
| 2017/03/24 | | 2017/04/05 | | INCH | | NTS | | | | | | | |
| 4 PLACES ± | | ± | | DRWN BY | | DATE | | | | | | | |
| 3 PLACES ± | | ± 0.01 | | BSHAH | | 2015/09/09 | | DUAL SMPM PLUG 50 OHMS SMOOTH BORE EDGE LAUNCH SMPM-P/PCB EWR-10146-B | | | | | |
| 2 PLACES ± | | ± 0.25 | | CHK'D BY | | DATE | | | | | | | |
| 1 PLACES ± | | ± | | PSWAMI02 | | 2016/12/07 | | PRODUCT CUSTOMER DRAWING | | | | | |
| 0 PLACES ± | | ± | | APPR BY | | DATE | | | | | | | |
| ANGULAR TOL = 2.0 | | DRAFT WHERE APPLICABLE MUST REMAIN WITHIN DIMENSIONS | | DRAWING SIZE | | THIRD ANGLE PROJECTION | | SERIES | | MATERIAL NUMBER | | CUSTOMER | |
| C1 | | C | | 73300 | | SEE TABLE | | 73300 | | SEE TABLE | | | |
| C1 | | C | | SD-73300-506 | | PSD | | 000 | | 3 OF 4 | | | |

