

REV	ECN NO	REVISIONS	DRN	CKD	APP	QA	CM	DATE
A	94258	NEW RELEASE	LD		CS			6-14-22

ASSEMBLY NUMBER	LED COLOR	DIMENSIONS			LED OPERATING CHARACTERISTICS AT 25°C AMBIENT										ABSOLUTE MAXIMUM RATINGS AT 25°C AMBIENT				
					PEAK WAVELENGTH (nm) TYP	DOMINANT WAVELENGTH (nm) TYP	VIEWING ANGLE (°)	LUMINOUS INTENSITY (mcd)			FORWARD VOLTAGE (V)			REVERSE CURRENT (mA)	POWER DISSIPATION (mW)	CONTINUOUS FORWARD CURRENT (mA)	PEAK FORWARD CURRENT (mA)	OPERATING TEMPERATURE (°C)	STORAGE TEMPERATURE (°C)
		DIM "A"	DIM "B"	DIM "C"				TEST CONDITION	MIN	TYP	MAX	TEST CONDITION	TYP	MAX	MAX				
550-0205-100F	GREEN DIFFUSED	.135	.020	.043	565	570	60	10 mA	25	60	90	20 mA	2.1	2.6	100 @ Vf=5V	100	30	90	-55 TO +100
550-0305-100F	YELLOW DIFFUSED	.135	.020	.043	585	588	60	10 mA	3.7	12.6		20 mA	2.1	2.6	100 @ Vf=5V	60	20	80	-55 TO +100
550-0405-100F	RED DIFFUSED	.135	.020	.043	635	625	60	10 mA	19	60		20 mA	2.0	2.6	100 @ Vf=5V	100	30	120	-55 TO +100
550-0505-100F	RED DIFFUSED 5 VOLT	.197	.025	.050	635		60	5v	2.1	—			—	—	100 @ Vf=5V	—	—	—	-40 TO +85
550-0705-100F	GREEN DIFFUSED 5 VOLT	.197	.025	.050	565		60	5v	—	1.8			—	—	100 @ Vf=5V	—	—	—	-20 TO +85
550-2205-100F	GREEN DIFFUSED	.190	.020	.043	563		65	10 mA	3.6	10.0			2.1	3.0	10 @ Vf=3V	75	25	60	-25 TO +85
550-2305-100F	YELLOW DIFFUSED	.190	.020	.043	585	590	50	10 mA	19	40	100	20 mA	2.1	2.6	100 @ Vf=5V	52	20	60	-40 TO +85
550-2405-100F	RED DIFFUSED	.190	.020	.043	650		50	10 mA	2.2	6.3			2.2	2.55	10 @ Vf=3V	60	20	60	-25 TO +85

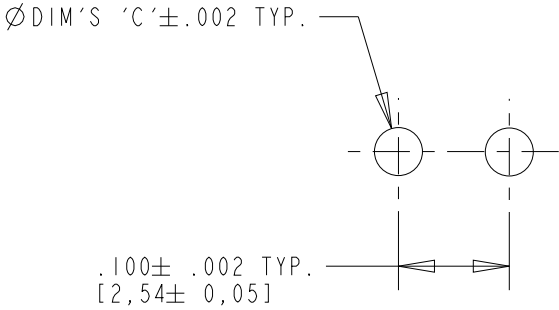
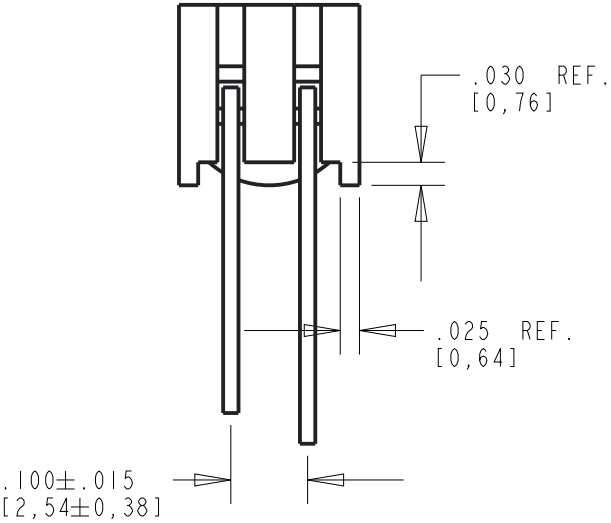
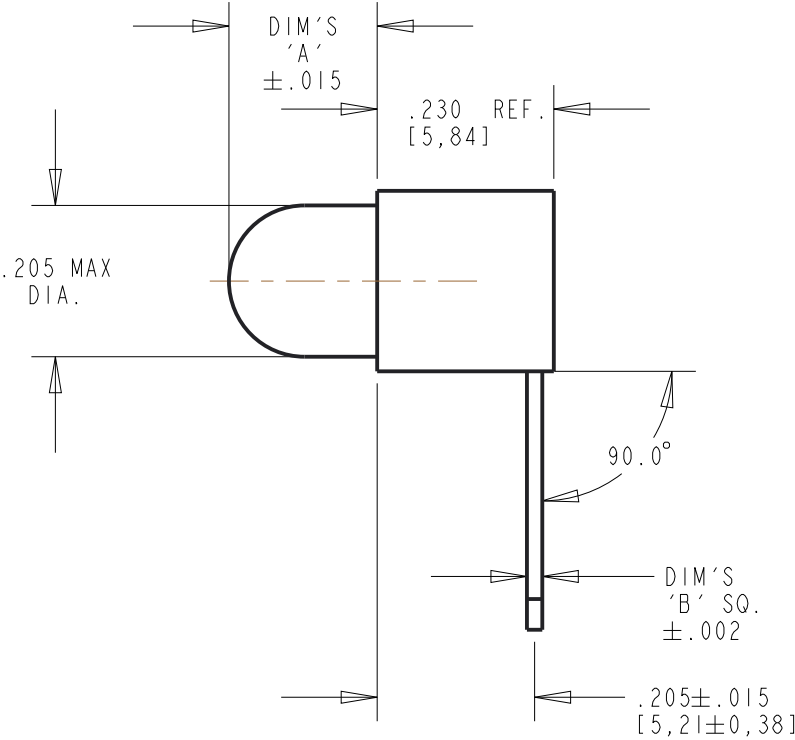
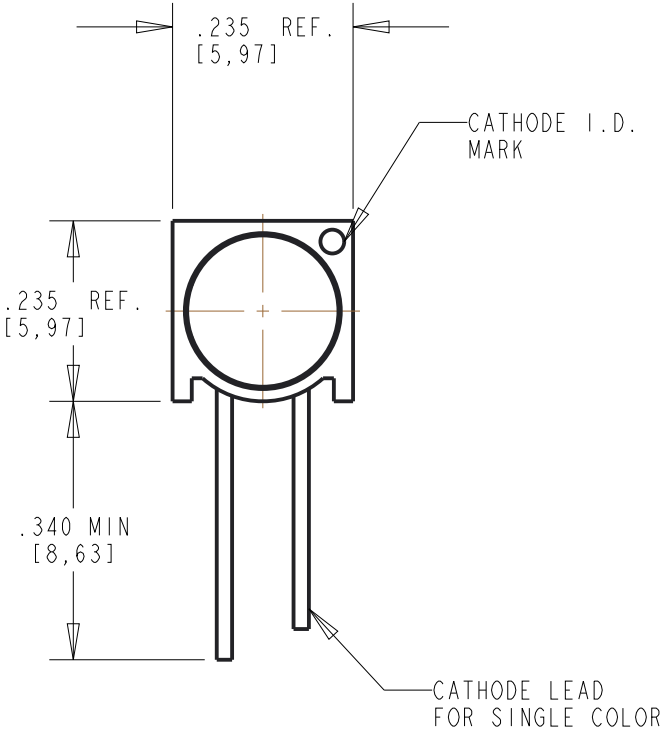

ATTENTION:
OBSERVE PRECAUTIONS FOR
HANDLING ELECTROSTATIC
SENSITIVE DEVICES

NOTES:

- LEADS TO FIT INTO HOLE PATTERN AS SHOWN.
- LED LEAD DIMENSIONS SHOWN ARE MEASURED AT HOUSING EXIT.
- PIN NUMBERS FOR REFERENCE ONLY, DESIGNATION NON-EXISTENT ON PARTS.
- THIS ASSEMBLY CONTAINS ELECTROSTATIC SENSITIVE DEVICES (ESDS). MAINTAIN ALL PRECAUTIONARY MEASURES DURING ASSEMBLY, HANDLING AND STORAGE IN ACCORDANCE WITH IPC-A-610.
- DIALIGHT PART NUMBER: 550-XX05-100F.

RECOMMENDED P.C.B. HOLE PATTERN

THIS DRAWING AND THE CONTENTS HEREIN ARE CONFIDENTIAL AND THE SOLE PROPERTY OF DIALIGHT CORP. REPRODUCTION OF THIS DRAWING OR CONSTRUCTION OF ANY PARTS WITHIN THIS DRAWING ARE FORBIDDEN WITHOUT THE WRITTEN CONSENT OF DIALIGHT CORP.		
SCALE: 6.000	DRAWING NUMBER	REV
ALL DIM'S: INCH (mm)	C-18570	A
TOLERANCES: UNLESS OTHERWISE SPECIFIED FRACTIONS: ±1/64 DECIMALS (.XX): ±.01 DECIMALS (.XXX): ±.005	TITLE	
ANGLES: ±1°	5mm LED CBI, SQ. BACK HOUSING	
FINISH	RoHS COMPLIANT	
FSCM 83330	MATERIAL	
	Dialight	1501 ROUTE 34 SOUTH FARMINGDALE, NJ 07727 (732) 919-3119 www.dialight.com
	SHEET 1 OF 1	FAMILY TABLE: