

DASH NO.	M CODE	MADE FROM
----------	--------	-----------

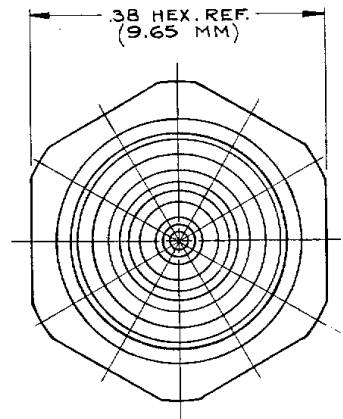
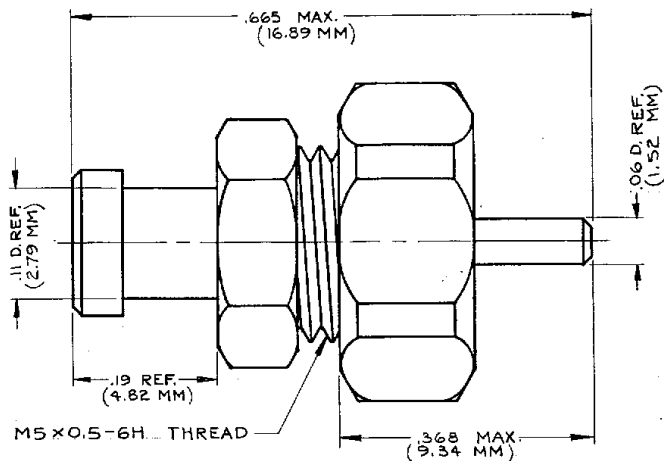

NOTES:

- FOR USE WITH RG-316/U CABLE.
- MATES WITH KINGS 2294-1-4.
- MATERIALS:
 SPRING - MUSIC WIRE, QQ-W-470.
 ALL OTHER METAL PARTS -
 BRASS, QQ-B-626
 INSULATORS - TEFLON, L-P-403.
- FINISHES:
 SPRING - CADMIUM PLT., .0002 MIN.
 (QQ-P-416).
 CENTER CONTACT - GOLD PLT., .0001 MIN.,
 (MIL-G-45204) OVER NICKEL PLT.,
 .0002 MIN. (QQ-N-290).

- ALL OTHER METAL PARTS - GOLD PLT.,
.0005 MIN. (MIL-G-45204)
OVER NICKEL PLT., .0002
MIN. (QQ-N-290).
ELECTRICAL CHARACTERISTICS -
NOMINAL IMPEDANCE - 50 Ω.
FREQUENCY RANGE - DC TO 700 MHz.
MAX. OPERATING VOLTAGE -
500 VOLTS RMS.
5. FOR CABLING INSTRUCTIONS SEE 3-466.

UNLESS OTHERWISE SPECIFIED:

- | | |
|--|--|
| 1. TOLERANCES: FRACTIONS & 2 PLACE DECIMALS ± .010 | 2. REMOVE ALL BURRS, BREAK SHARP EDGES .005 MAX. |
| 3 PLACE DECIMALS ± .004 | 3. NO FILLETS PERMITTED. |
| ANGLES ± 0°30' | 4. SURFACE ROUGHNESS 63 MICRONS RMS MAX. |
| T. I. R. CONCENTRICITY OF ANY 2 DIAMETERS MAY | 5. ALL DIMENSIONS PRIOR TO PLATING. |
| NOT EXCEED HALF THE SUM OF THEIR TOLERANCES. | 6. ALL PLATING IN ACCORDANCE WITH KER 10004. |

REVISIONS

ISSUE	CHANGES
0	ER 23652 GJG 20 AUG 82
1	CN 32426 E KH 13 AUG 90

K-3972

GSD

SCALE	8:1
APPROX. SURFACE AREA	
USED ON:	
REF.	U.S. ARMY MISSILE COM. DWG. 9167003 REV. H ₃
SUB-MINIATURE PLUG	
DRAWN	GJG DATE 24 NOV 81
APPR.	MJS DATE 29 NOV 81
KINGS ELECTRONICS CO., INC. LICHFIELD, NEW YORK 14870	

GSD

K-3972