

Compact Current Transformers

CT Series

FEATURES

These compact, thin sensors are used to detect current in protective and control circuits in various devices, including switching power supplies.

TEMPERATURE RANGES

Operating temperature range	-20 to +70°C
Temperature rise	40°C max.

SHAPES AND DIMENSIONS/TERMINAL POSITIONS

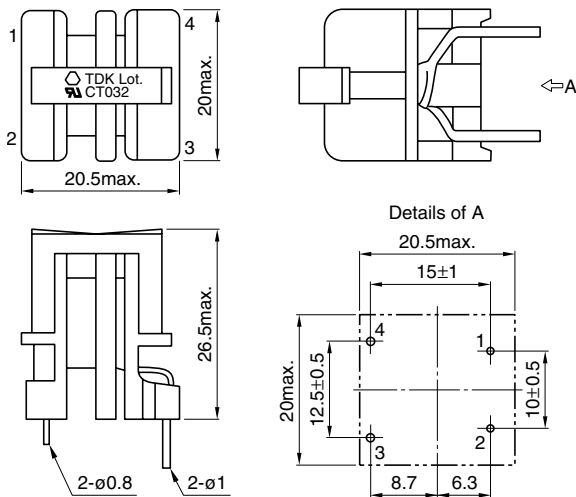

Fig.1

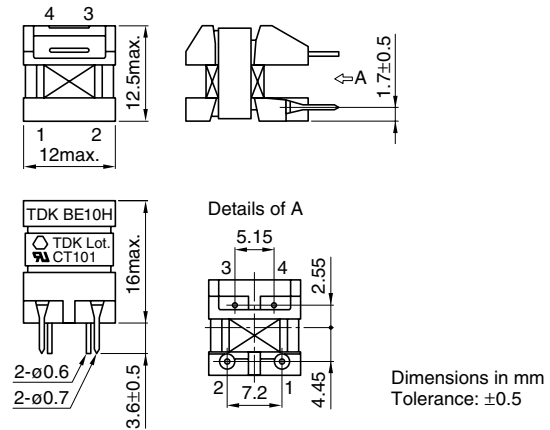

Fig.2

Dimensions in mm
Tolerance: ± 0.5

ELECTRICAL CHARACTERISTICS

Part No.	Turn ratio $N_1:N_2$	Inductance (mH)min. N_2	DC resistance(Ω)max.		Withstand voltage E_{ac} (kV)	Fig.
			N_1	N_2		
CT032	2:200	12	0.005	8	3.75	1
CT034	1:200	12	0.004	8		
CT101	1:100	6	0.005	5	2	2
CT201	1:200	24	0.005	15		

TERMINAL CONNECTIONS

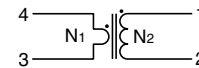

TYPICAL ELECTRICAL CHARACTERISTICS

OUTPUT CHARACTERISTICS

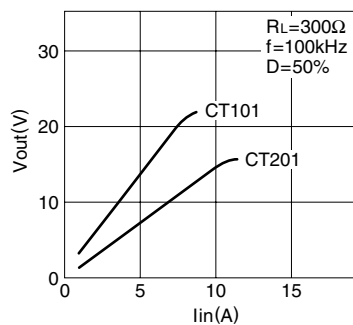
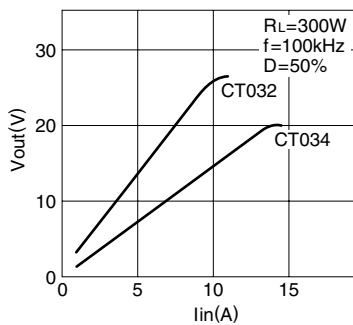

TYPICAL ELECTRICAL CHARACTERISTICS

OUTPUT CHARACTERISTICS FOR TERMINATING RESISTANCE (RL) CHANGE

CT032

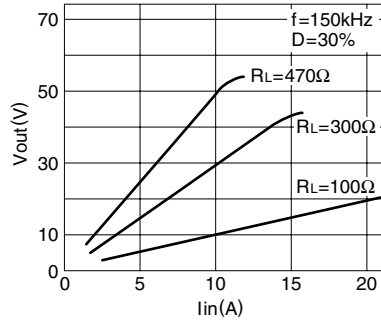

CT101

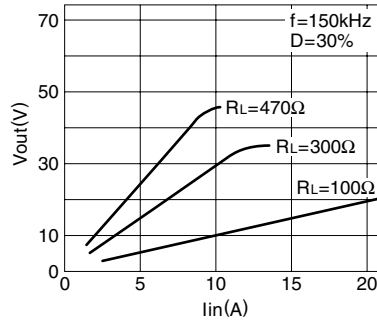

CT034

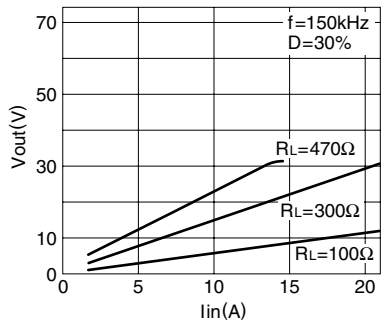

CT201

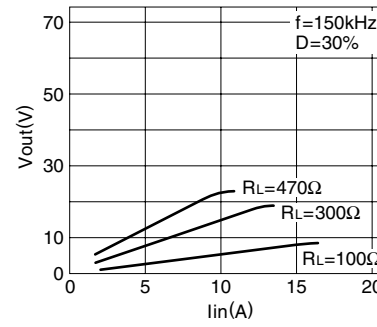

MEASURING CIRCUIT

