

GSD

1705-2-1

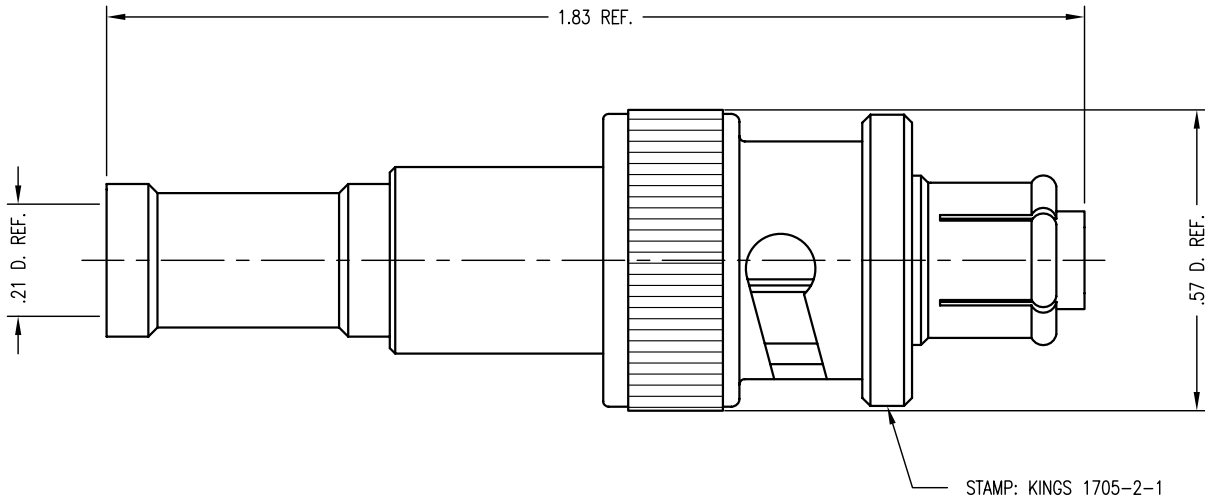

- NOTES:
- FOR USE WITH RG-58, 58A, 58C, 141 & 141A/U CABLES.
 - FOR CABLING INSTRUCTIONS SEE CP-441.
 - FOR CRIMPING USE DIE KTH-2061.
 - FOR CABLE TRIMMING USE KTJ-72 & KTD-136.
 - INTERFACE PER MIL-STD-348, FIG. 314-2.
 - MATERIALS:
 INSULATOR: REXOLITE, L-P-516
 GASKET: SIL. RUB., ZZ-R-765
 K-GRIP SLEEVE: COMMERCIAL BRONZE TUBE, ALLOY 220
 SPRING WASHER & CONTACTS: BER. COP., ASTM-B-196
 ALL OTHER PARTS: BRASS, ASTM-B16
 - FINISHES:
 CENTER CONTACT: HARD GOLD PLT. PER MIL-G-45204
 SPRING WASHER: SILVER PLATE PER QQ-S-365
 ALL OTHER METAL PARTS: KINGS TARNISH RESISTANT NICKEL FINISH (TR-5)
 - ELECTRICAL CHARACTERISTICS:
 OPERATING VOLTAGE: 3500 VOLTS AC
 5000 VOLTS DC

REVISIONS

ISSUE	CHANGES
2	CN 17012 E KH 10/17/94
D	REVISED PER ER19059 GGR 10/085/2009

KAM3981

THIS DRAWING, THE DESIGNS AND IDEAS EMBODIED IN THE DEVICE TO WHICH IT RELATES, AND THE METHOD OF PRODUCING THE DEVICE, ARE THE PROPERTY OF WINCHESTER ELECTRONICS CORPORATION AND SHALL NOT BE EMPLOYED, COPIED, OR DISCLOSED TO ANYONE, IN ANY MANNER WITHOUT THE CONSENT OF WINCHESTER ELECTRONICS CORPORATION.

SCALE 4:1

APPROX SURFACE AREA

USED ON

REF:

PLUG, SHV

DRAWN KH	DATE 10/17/94
DESIGN MJB	DATE 10/18/94
APPR.	DATE

<p>WINCHESTER ELECTRONICS</p>	<p>Winchester Electronics 82 Barnes Industrial Road North Wallingford, CT 06492</p>
-------------------------------	--

GSD

1705-2-1