

15

1501 12

Jack connectors



Jack chassis socket acc. to JIS C 6560 JC25J3B, 2.5 mm, 3 poles/stereo, angular version, with 2 break contacts, for printed circuit boards, surface mounting technology (SMT)

State: Obsolete

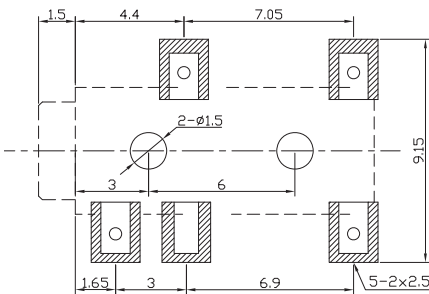
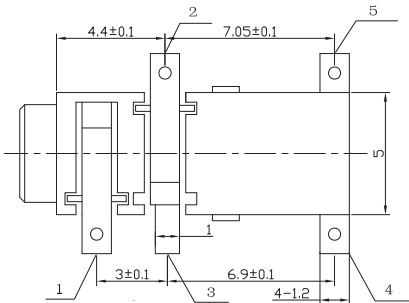
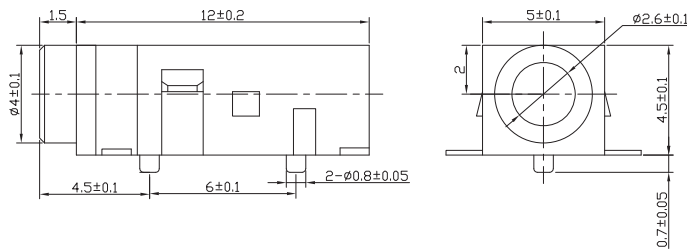

*a

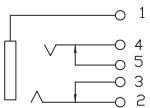

*a printed circuit board layout, solder side view

Environmental conditions

Temperature range -20 °C/+70 °C

Materials

Insulating body PA GF, V-0 according to UL94
Contact spring Cu alloy, silver-plated

Mechanical data

Mating cycles 5000
Insertion force 3–30 N¹
Withdrawal force 3–30 N¹

¹ measured with a gauge plug, initial value

Electrical data (at T_{amb} 20 °C)

Contact resistance ≤ 50 mΩ
Rated current 1 A
Rated voltage 12 V DC
Rated impulse voltage 250 V/60 s
Insulation resistance ≥ 100 MΩ

Associated products

Counterparts
☑ KLS 13

15

1501 12

Designation	Pole Number	PU (Pieces)	MDQ (Pieces)
1501 12 VP3	3	1000	1000

Packaging:

on reel