

DWG. NO.		500-900-1160N	
REV	DESCRIPTION	BY	APPD
A	RELEASED PER NPR 1611	12/17/99	[Signature]

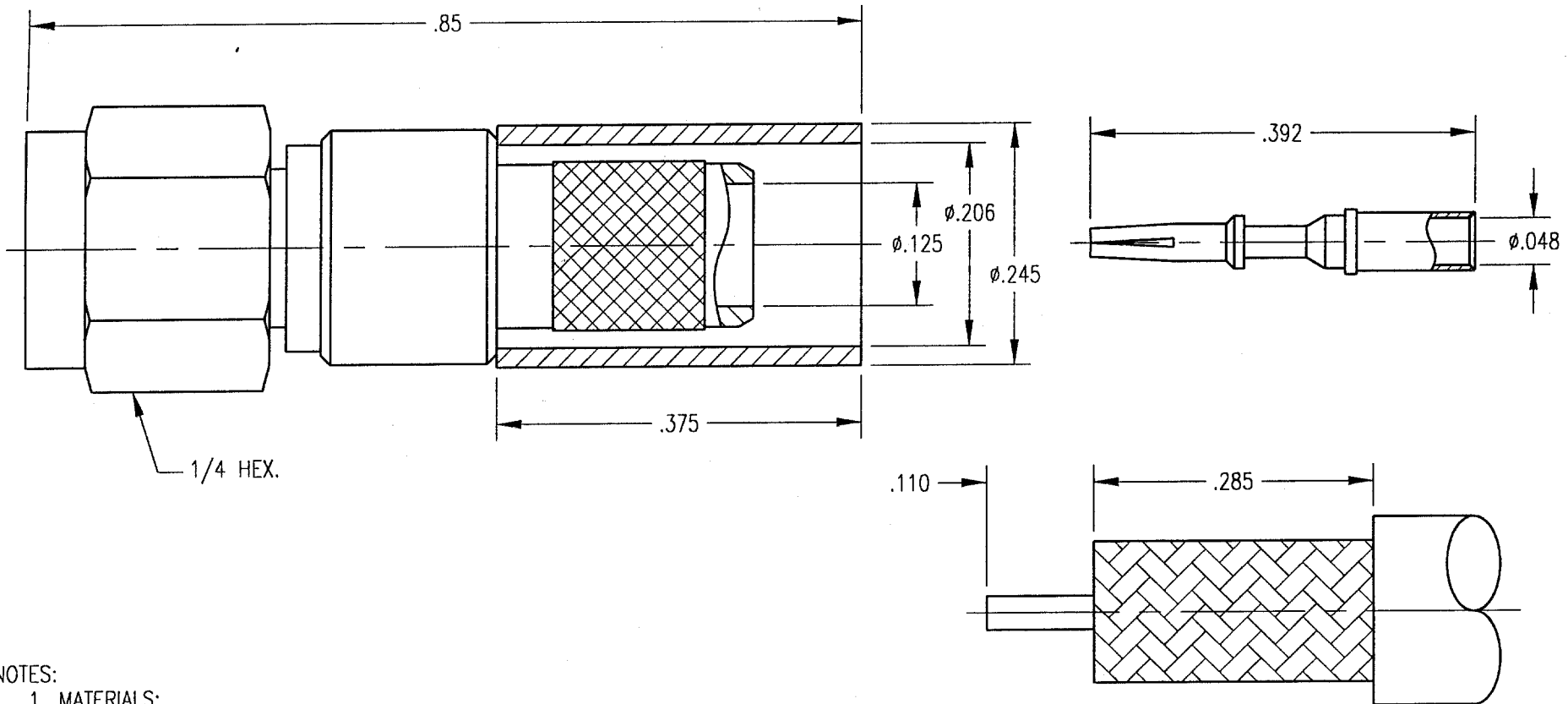

NOTES:

- MATERIALS:
 BODY AND COUPLING NUT: BRASS PER ASTM B16
 CONTACT: BERYLLIUM COPPER PER ASTM B196
 FERRULE: BRASS PER ASTM B16
- FINISH:
 CONTACT: .000030 MIN. GOLD PER MIL-G-45204 OVER
 .000050 MIN. NICKEL PER QQ-N-290
 ALL OTHER METAL PARTS: .000100 MIN. NICKEL PER QQ-N-290
 OVER COPPER FLASH
- FOR USE WITH RG-58 OR EQUIVALENT CABLE.
- FOR ASSEMBLY USE CAP 9-15 WITH ABOVE CABLE TRIM DIMENSIONS.
- CRIMP WITH DANIELS Y-197 CRIMP DIE, .213 HEX.

CABLE TRIM DIMENSIONS

PER ASME Y14.5M-1994 UNLESS OTHERWISE SPECIFIED: DIMENSIONS ARE IN INCHES OR INCHES/MM TOLERANCES: .XX ± .01/0.254 .XXX ± .005/0.127 ANGLES ± 2° SCALE: 6:1		Litton Winchester Electronics/RETCONN 400 Park Road Wallingford, Connecticut 06795	
CUSTOMER DRAWING		TITLE CRIMP/CRIMP SMC PLUG	
DRAWN K/JT	DATE 12/17/99	CHECKED SP 12-20-99	DATE 12/20/99
APPROVED [Signature]	DATE 12/20/99	APPROVED [Signature]	DATE 12/20/99
500-900-1160N		SHT. 1	OF 1
		REV. A	