

SPECIFICATION CONTROL DRAWING

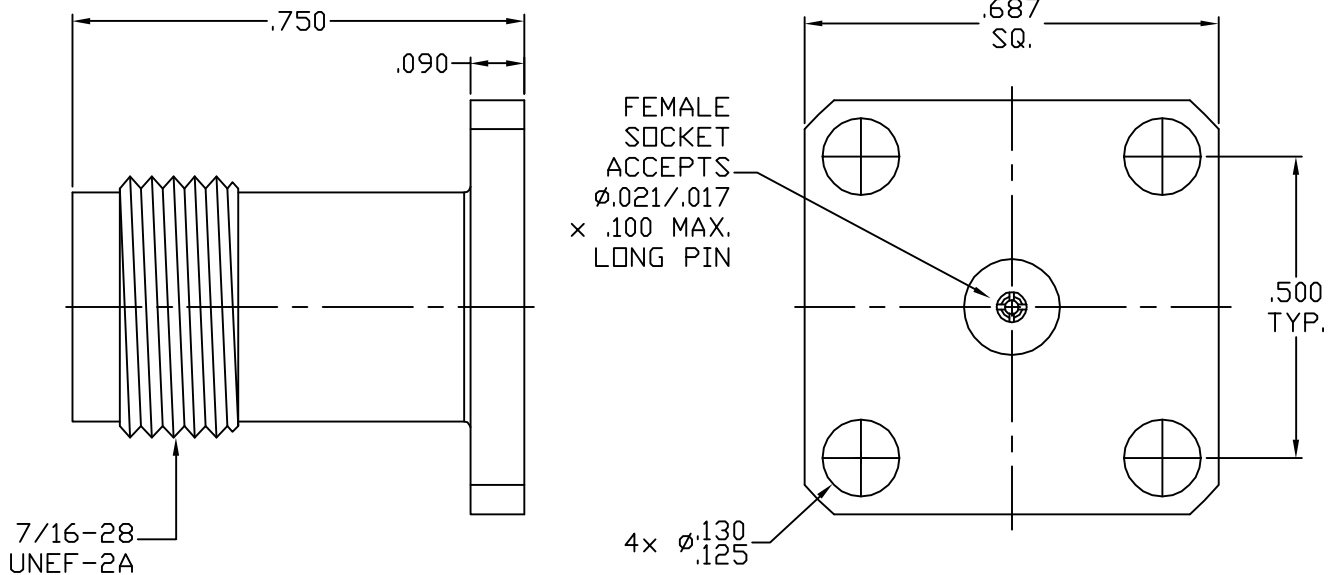

1. MATING INTERFACE DIMENSIONS PER MIL-STD-348 Fig. 313.2 (TNC JACK)

2. ELECTRICAL

FREQUENCY RANGE GHz	_____	D.C. TO 18.0 GHz.
VSWR (MAX.) *	_____	1.05 + .007 x FGHz.
INSERTION LOSS (dB MAX.) *	_____	.04 dB x $\sqrt{\text{FGHz}}$.
NOMINAL IMPEDANCE (OHMS)	_____	50
VOLTAGE RATING (MAX. VRMS)	_____	500
RF LEAKAGE (MIN. dB DOWN)	_____	-100 dB - FGHz.
TEMPERATURE RATING (DEGREES CENTIGRADE)	_____	-65 ° c TO +165 ° c
DIELECTRIC WITHSTANDING VOLTAGE (MAX. VRMS)	_____	1500
INSULATION RESISTANCE (MIN. MEGOHMS)	_____	5,000
CONTACT RESISTANCE		
• CENTER CONTACT (MAX. MILLIOHMS)	_____	4.5
• OUTER CONTACT (MAX. MILLIOHMS)	_____	2.0

* TERMINATED IN A 50 OHM LOAD

REV.	DCN NO.	DATE	APP.	DIMENSIONS ARE IN INCHES TOLERANCES			HAVERHILL, MA. 01835
-	265	1/87	CM	DECIMALS	FRACTIONAL	ANGULAR	
AA	07-1119	2/1/07	DC	.X ± .030 .XX ± .010 .XXX ± .005	±/64	X ° +1° 0' X ° X ± 15'	
				SURFACE ROUGHNESS 63 $\sqrt{\text{MIL-STD 10}}$.			
				DRAWN CDM	DATE 1/87	TITLE KTNC, JACK 4 HOLE FLANGE FIELD REPLACEABLE	
				APPROVED TS	DATE 1/87		
				CODE IDENT. 2J899	SHEET 1 OF 2		DWG. NO. 8554-0081-6220

SPECIFICATION CONTROL DRAWING

3. MECHANICAL

CAPTIVATION-CENTER CONTACT

- MAX AXIAL FORCE _____ 6.0 LBS.
- MAX RADIAL TORQUE _____ N/A

CENTER CONTACT AXIAL FORCE

- INSERTION (MAX OUNCES) _____ INTERFACE 32.0 ; REAR 32.0
- WITHDRAWAL (MIN. OUNCES) _____ INTERFACE 2.0 ; REAR 1.0

CONNECTOR ENGAGEMENT/DISENGAGEMENT (MAX LBS.) _____ 2.0

CONNECTOR DURABILITY (MIN. CYCLES) _____ 500

RECOMMENDED MATING TORQUE _____ 30 TO 35 INCH LBS.

4. ENVIRONMENTAL

- TEMPERATURE CYCLING _____ MIL-STD-202, METHOD 102, COND. C (-65 ° c TO + 165 ° c)
- SHOCK _____ MIL-STD-202, METHOD 213, COND. I (100 G's)
- VIBRATION _____ MIL-STD-202, METHOD 204, COND. D (20 G's)
- MOISTURE RESISTANCE _____ MIL-STD-202, METHOD 106, LESS STEP 7b
- CORROSION _____ MIL-STD-202, METHOD 101, COND. B (48 HOURS)
- BAROMETRIC PRESSURE (ALTITUDE) _____ MIL-STD-202, METHOD 105, COND. C (70,000 FT.) (375 VRMS)

5. MATERIAL

- BODY _____ STAINLESS STEEL PER ASTM-A-581, TYPE 303, COND. A.
- CONTACT _____ BERYLLIUM COPPER PER ASTM-B-190. COPPER ALLOY UNS 17300 TD04
- INSULATOR _____ TEFLON PER ASTM-D-1710

6. FINISH

- BODY _____ PASSIVATE PER QQ-P-35A, TYPE I.
- CONTACT _____ GOLD PER ATSM-B-488, TYPE I, CODE C, CLASS 2.5
(.000100 MIN.THK.) OVER NICKEL PER QQ-N-290,
(.000050 MIN. THK.) OVER COPPER PER MIL-C-14550
(.000010 MIN. THK.).
- INSULATOR _____ N/A