

MATERIAL AND FINISH

Insulator (top & bottom): PBT glass fiber, UL-94V-0 rated, color (see ordering code)  
 Shell (top): SPCC, 100µ" Tin plated  
 Shell (bottom): SPCC, Tin plated  
 Contact: Brass, Gold (see chart) over Nickel plated on mating end, and Tin-Lead over Nickel plated on termination end

ELECTRICAL SPECIFICATIONS:

Insulation resistance: 100 Mohm min. @ 630 VDC  
 Dielectric withstanding voltage: 750 VAC for one minute

MECHANICAL:

Recommended wire gauge: 26 ~ 28 AWG

ENVIRONMENTAL:

Temperature rating: -55°C to +85°C

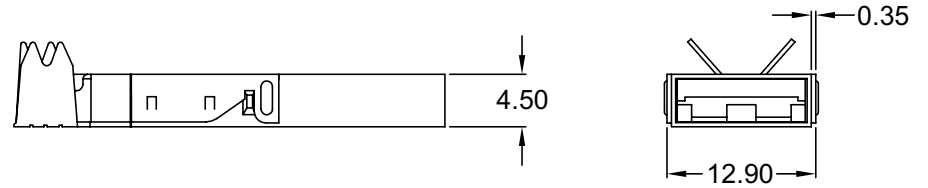
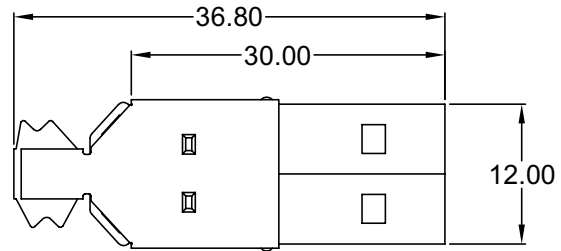

ORDERING CODE:

USB-MA1SS       
                  1 2

- 1) INSULATOR COLOR  
 1 = BEIGE  
 2 = BLACK  
 3 = WHITE

- 2) PLATING  
 SEE CHART

NOTE: SEE SHEET 2 FOR ASSEMBLY

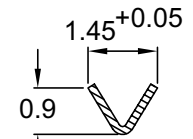
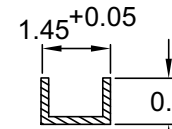
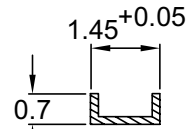
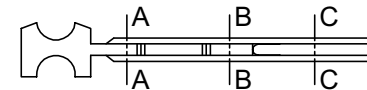
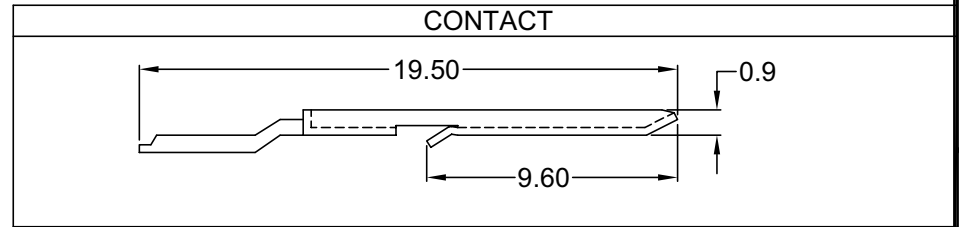

SECTION A-A

SECTION B-B

SECTION C-C

TOLERANCE  
UNLESS OTHERWISE SPECIFIED

X ± 1  
 X.X ± 0.4  
 X.XX ± 0.20

**Power Dynamics, Inc.**

Phone: 973 560-0019 Whippany, New Jersey Fax: 973 560-0076

PART: USB CONNECTOR TYPE "A" MALE  
SOLDER TYPE

P/N	PLATING
USB-MA1SSX1	GOLD FLASH
USB-MA1SSX2	10µ"
USB-MA1SSX3	15µ"
USB-MA1SSX4	30µ"

DRAWN BY	GQ	DATE:	06/26/02
CHECK BY	TD	DATE:	06/27/02
APPR BY	PB	DATE:	06/27/02

PART #:		USB-MA1SSXX	SHEET
SIZE:		A	1 of 2
SCALE:		NTS	REV:

ALL DIMENSIONS FOR REFERENCE ONLY  
DIMENSIONS ARE IN MILLIMETERS

REV	DATE	CHANGE	CHKG	CHKD	APPR

6

5

4

3

2

1

1

2

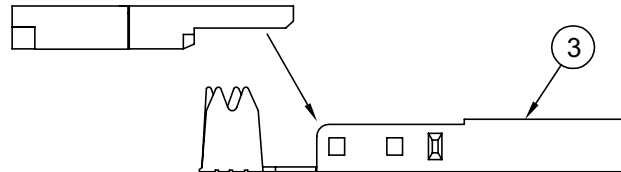
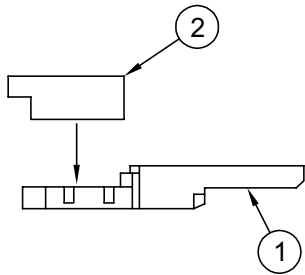

3

4

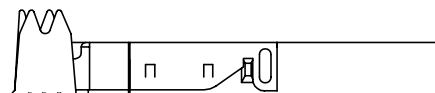
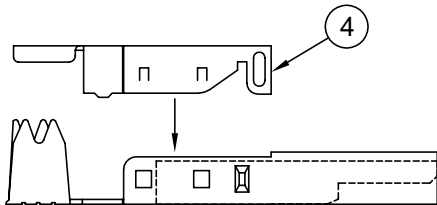

ITEM	DESCRIPTION
1	BOTTOM INSULATOR W/ CONTACT
2	TOP INSULATOR
3	BOTTOM SHELL
4	TOP SHELL

REVISIONS

SEE SHEET 1 OF 2 FOR LATEST REVISIONS

TOLERANCE UNLESS OTHERWISE SPECIFIED		
X	±	1
X.X	±	0.4
X.XX	±	0.20
DRAWN BY	GQ	DATE: 06/26/02
CHECK BY	TD	DATE: 06/27/02
APPR BY	PB	DATE: 06/27/02

**Power Dynamics, Inc.**

Phone: 973 560-0019 Whippany, New Jersey Fax: 973 560-0076

PART: USB CONNECTOR TYPE "A" MALE  
SOLDER TYPE

PART #: <b>USB-MA1SSXX</b>		SHEET 2 of 2
SIZE: A	ALL DIMENSIONS FOR REFERENCE ONLY DIMENSIONS ARE IN MILLIMETERS	
SCALE: NTS		REV:

6

5

4

3

2

1