

Electrical

(REV. 01)

ELECTRICAL SPECIFICATIONS

OPERATING TEMPERATURE RANGE:	: -40°C TO +85°C
URNS RATIO :	
(12-10):(1-2-3)	: 1 : 1.15CT ±3%
(4-5-6):(9-8-7)	: 1CT : 2CT ±3%
INDUCTANCE :	
(12-10) = (4-6)	: 1.5 mH MIN. @ 0.1Vrms 10KHz @25°C
	: 600 uH MIN. @ 0.1Vrms 10KHz @-40°C
LEAKAGE INDUCTANCE:	
1-3 WITH (12,11,10) SHORT)	: 0.5 uH MAX. @ 1 MHz
4-6 WITH (9,8,7) SHORT)	: 0.5 uH MAX. @ 1 MHz
INTERWINDING CAPACITANCE:	
(12,10) TO (1,2,3)	: 40 pf MAX.
(4,5,6) TO (9,8,7)	: 40 pf MAX.
D.C. RESISTANCE:	
1-2 = 2-3	: 1.0 OHMS MAX.
12-10 = 9-8 = 10-9	: 0.7 OHMS MAX.
4-5 = 5-6	: 0.35 OHMS MAX.
DIELECTRIC VOLTAGE WITHSTAND:	
(1,2,3) TO (12,10)	: 1500VAC
(4,5,6) TO (10,9,8)	: 1500VAC

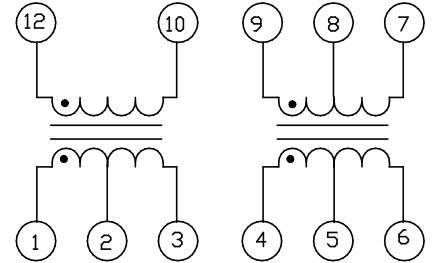

Mechanical

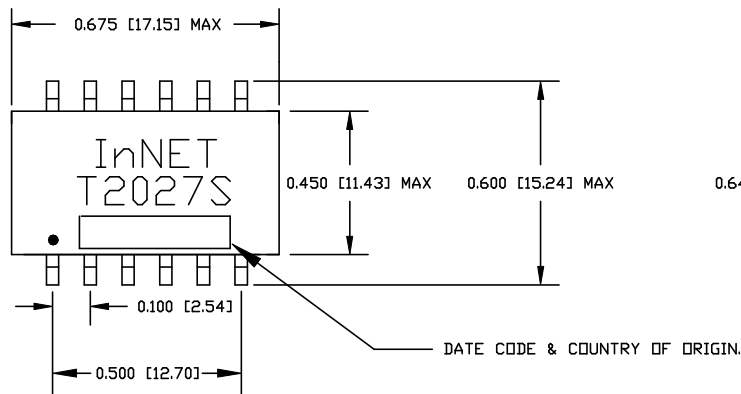

SUGGESTED PAD LAYOUT

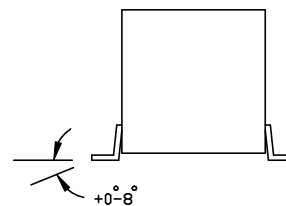
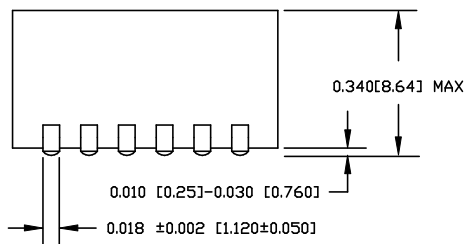
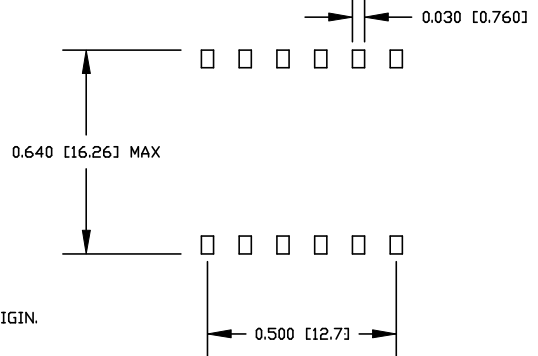

NOTES:

- 1.0 LEADS MEET THE SOLDERABILITY REQUIREMENTS TO MIL-STD-202 METHOD 208.
- 2.0 COPLANARITY OF PINS IS .004 [0.102] MAX.
- 3.0 THE CASE IS UL 94 V-0 BLACK PLASTIC.