

PLEASE CHECK WWW.MOLEX.COM FOR LATEST PART INFORMATION

Part Number: [0191930152](#)
Status: **Active**
Overview: [VersaKrimp Terminals and Splices](#)
Description: [VersaKrimp Ring Tongue Terminal for 8 AWG Wire, Stud Size 1/4" \(M6\)](#)

Documents:

[Drawing \(PDF\)](#) [Product Specification PS-19902-013-001 \(PDF\)](#)
[Product Specification PS-19902-011-001 \(PDF\)](#) [RoHS Certificate of Compliance \(PDF\)](#)

Agency Certification

CSA LR18689
 UL E32244

General

Product Family Ring and Spade Terminals
 Series [19193](#)
 Crimp Quality Equipment Yes
 Overview [VersaKrimp Terminals and Splices](#)
 Product Name VersaKrimp
 Taxonomy Ring and Spade Terminals
 Type Ring
 UPC 800755049992

Physical

Barrel Type Closed - Brazed
 Insulation None
 Material - Plating Mating Tin
 Net Weight 2.939/g
 Packaging Type Bag
 Plating min - Mating 2.540µm
 Plating min - Termination 2.540µm
 Stud Size 1/4" (M6)
 Termination Interface: Style Crimp or Compression
 Wire Size AWG 8
 Wire Size mm² 6.60-10.50

Solder Process Data

Lead-freeProcess Capability N/A

Material Info

Engineering Number D-350-14

Reference - Drawing Numbers

Product Specification PS-19902-011-001, PS-19902-013-001
 Sales Drawing SD-19193-016-001

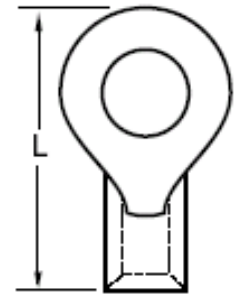

Series image - Reference only

EU ELV

Not Relevant

EU RoHS

Compliant

China RoHS

REACH SVHC

Not Contained per -
 D(2022)9120-DC (17
 Jan 2023)

Halogen-Free

Status

Low-Halogen

For more information, please visit [Contact US](#)

China ROHS

Green Image

ELV

Not Relevant

RoHS Phthalates

Not Contained

Search Parts in this Series

[19193 Series](#)

Application Tooling | FAQ

Tooling specifications and manuals are found by selecting the products below. Crimp Height Specifications are then contained in the Application Tooling Specification document.

Global

Description	Product #
Manual Putt Pump Hydraulic System, Die set required	192860117
Die Set (large) for the HHLS Hydraulic Crimper	192900001
Manual tool for Crimping non-insulated 8AWG thru 4/0 Terminals	192940008
Hydraulic Dieless Crimping Tool	638161700

PremiumGrade Hand	<u>640013900</u>
Crimp Tool for 2-8	
AWG Terminals	
RHT1080 Hand	<u>640034400</u>
Crimp Tool	
Square "DIN" style	<u>640037670</u>
dies for 8 AWG	
Crimp Head for the	<u>640074400</u>
AT-200 Pneumatic	
Hand Tool	

This document was generated on 03/07/2023

PLEASE CHECK WWW.MOLEX.COM FOR LATEST PART INFORMATION