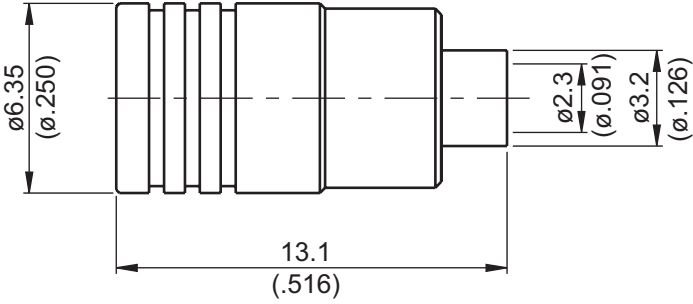

SMB3300-0085	<b>SMB Plug Solder For RG405; 2.8GHz VSWR 1.2</b>		<b>50Ω</b>															
																		
<table border="1"> <thead> <tr> <th>Parts</th> <th>Material</th> <th>Plating (Micro-inch)</th> </tr> </thead> <tbody> <tr> <td>Contact Pin</td> <td>Phosphor Bronze</td> <td>Gold 4 Over Nickel-Phosphorus Alloy 80 Over Copper 20</td> </tr> <tr> <td>Retainer Ring</td> <td>Beryllium Copper</td> <td>Tin-Zinc-Copper-Alloy 100 Over Copper 50</td> </tr> <tr> <td>Insulator</td> <td>Teflon</td> <td></td> </tr> <tr> <td>Body</td> <td>Brass</td> <td>Gold 4 Over Nickel-Phosphorus Alloy 80 Over Copper 20</td> </tr> </tbody> </table>	Parts	Material	Plating (Micro-inch)	Contact Pin	Phosphor Bronze	Gold 4 Over Nickel-Phosphorus Alloy 80 Over Copper 20	Retainer Ring	Beryllium Copper	Tin-Zinc-Copper-Alloy 100 Over Copper 50	Insulator	Teflon		Body	Brass	Gold 4 Over Nickel-Phosphorus Alloy 80 Over Copper 20			
Parts	Material	Plating (Micro-inch)																
Contact Pin	Phosphor Bronze	Gold 4 Over Nickel-Phosphorus Alloy 80 Over Copper 20																
Retainer Ring	Beryllium Copper	Tin-Zinc-Copper-Alloy 100 Over Copper 50																
Insulator	Teflon																	
Body	Brass	Gold 4 Over Nickel-Phosphorus Alloy 80 Over Copper 20																
<p>Weight: 1.7 g Suitable Cables: Semi-rigid.085</p>																		

This part number complies with RoHS.

Notice: JYEBAO reserves the right to make modifications deemed appropriate.

SMB	SMB3300-0085
<div data-bbox="169 344 568 389" style="border: 1px solid black; padding: 2px;">Interface</div> <p>MIL-STD-348B Mechanically compatible with <span style="float: right;">SMS</span></p>	
<div data-bbox="169 512 568 557" style="border: 1px solid black; padding: 2px;">Electrical Data</div> <p>Impedance <span style="float: right;">50Ω</span>            Frequency range <span style="float: right;">DC to 2.8GHz</span>            VSWR <span style="float: right;">≤ 1.2 (DC to 2.8GHz)</span>            Insertion loss <span style="float: right;">≤ 0.1 x √f(GHz) dB</span>            Insulation resistance <span style="float: right;">≥ 10000MΩ</span>            Contact resistance inner conductor <span style="float: right;">≤ 5mΩ</span>            Contact resistance outer conductor <span style="float: right;">≤ 2.5mΩ</span>            Dielectric withstanding voltage (at sea level) <span style="float: right;">1000 V rms</span>            Working Voltage (at sea level) <span style="float: right;">335 V rms</span></p>	
<div data-bbox="169 1099 568 1144" style="border: 1px solid black; padding: 2px;">Mechanical Data</div> <p>Disengagement force <span style="float: right;">1.8 to 14.2 lbs</span>            Engagement force <span style="float: right;">1.8 to 14.2 lbs</span>            Contact captivation-axial <span style="float: right;">≥ 4 lbs</span>            Durability (mating) <span style="float: right;">≥ 500</span></p>	
<div data-bbox="169 1458 568 1503" style="border: 1px solid black; padding: 2px;">Environmental Data</div> <p>Temperature range <span style="float: right;">-65°C to +165°C</span>            Thermal shock <span style="float: right;">MIL-STD-202, Method 107, Condition B</span>            Moisture resistance <span style="float: right;">MIL-STD-202, Method 106</span>            Corrosion <span style="float: right;">MIL-STD-202, Method 101, Condition B</span>            RoHS <span style="float: right;">Compliant</span></p>	
<div data-bbox="169 1809 568 1854" style="border: 1px solid black; padding: 2px;">Tooling</div> <p>Crimping tool <span style="float: right;">CRT-1 or CRT-2</span>            Crimp insert <span style="float: right;">INSERT-A</span>            Insert for .085semi-rigid cable <span style="float: right;">ST-009</span>            Locator tool <span style="float: right;">ST-011</span>            Soldering fixture <span style="float: right;">ST-008</span></p>	

Notice: JYEBAO reserves the right to make modifications deemed appropriate.

# JYE BAO CO., LTD.

## CABLE ASSEMBLY INSTRUCTION

SMB3300-0085	DATE	2017/06/12	REV	—
--------------	------	------------	-----	---

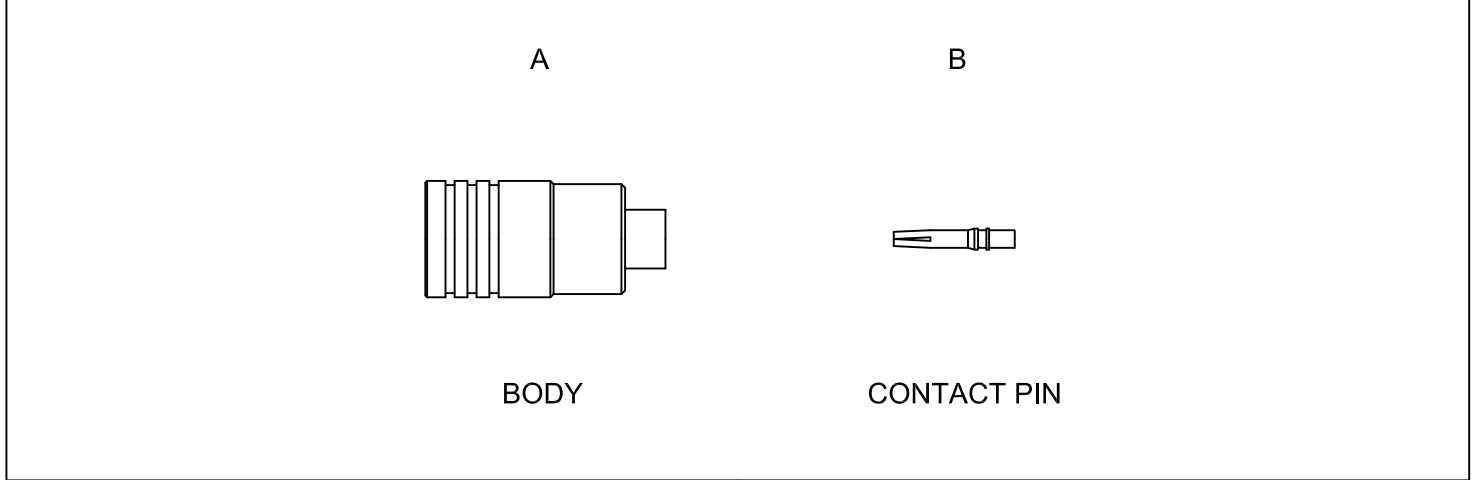
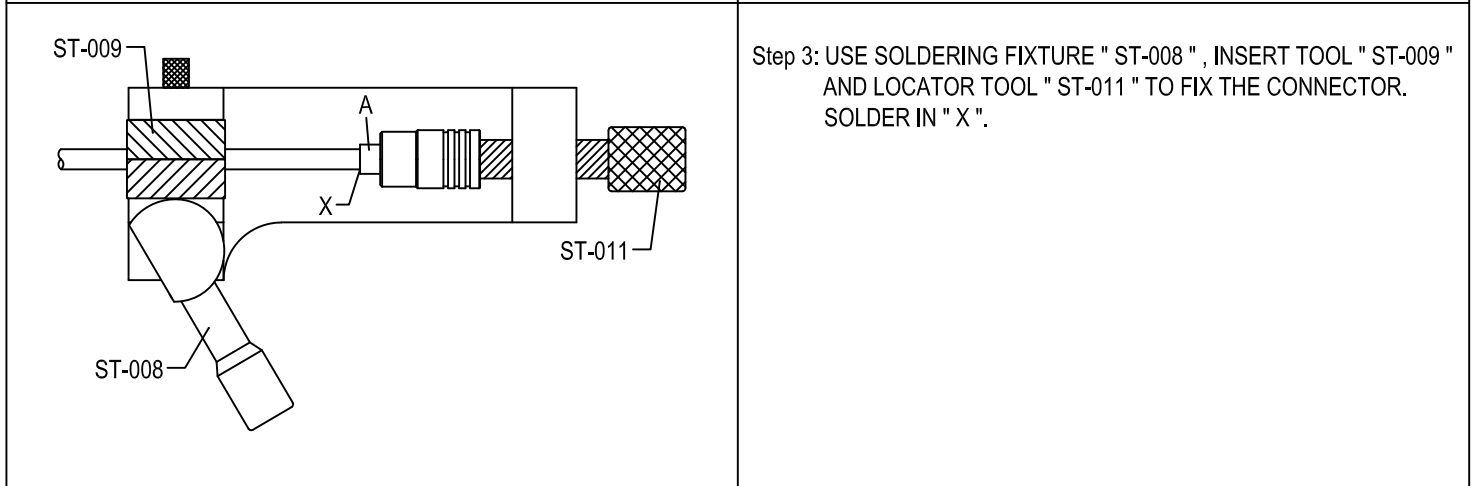
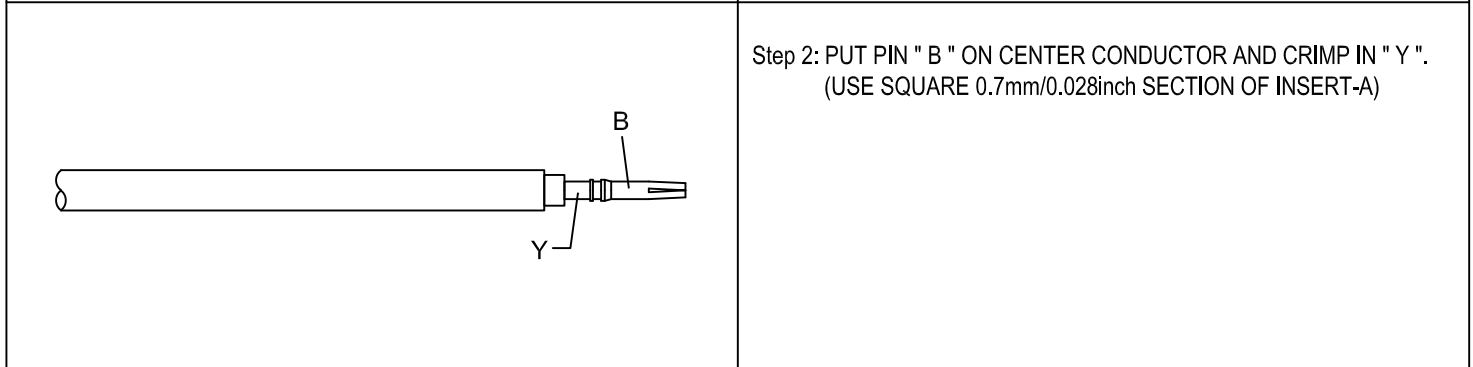
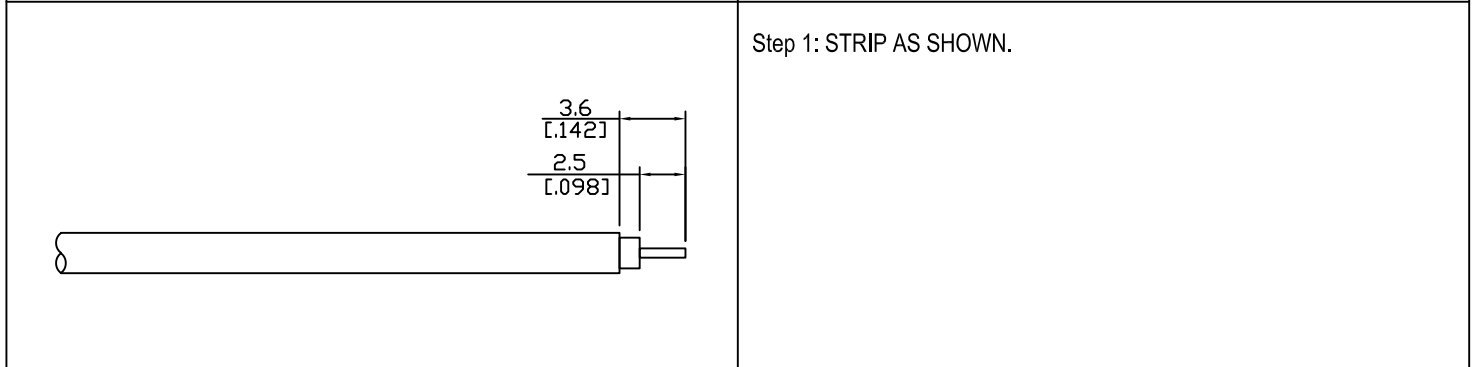

DIAGRAM	ASSEMBLY INSTRUCTION
---------	----------------------



This part number complies with RoHS.  
 Notice: JYEBAO reserves the right to make modifications deemed appropriate.

APPROVED	CHECKED	DRAWING
----------	---------	---------

*Albert*

# SMB3300-0085

S11

