

Bulkhead Jacks—For Flexible and Semi-Rigid Cable

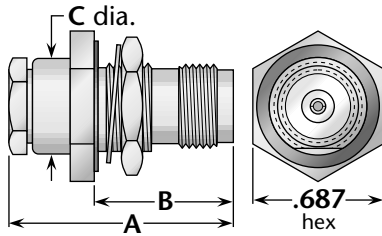

Figure 1
(Rear mount)

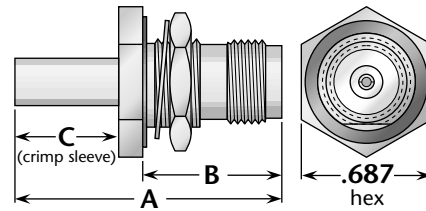
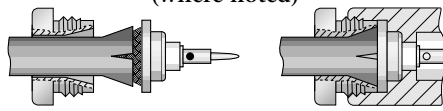

Figure 2
(Rear mount)

Heli-Grip® Cable Attachment (where noted)



These connectors have captivated contacts and allow rapid, easy assembly—simply trim the cable, slide into the cone/insulator/contact assembly (left), solder the center conductor to the contact, and screw body assembly (right) onto the cable assembly.

Military Clamp for Flexible Cable

Cable Group	Fig.	Dimensions			Mounting Figure	Max. Panel	Plating		Delta P/N	Assembly Procedure/Trim Code
		A	B	C			Body	Contact		
5, 6	1	1.16	.68	.50	59	.11	Nickel	Gold	1216-015-N590	A/17
5, 6	1	1.16	.68	.50	59	.11	Nickel	Gold (C)	1216-015-N591	A/17
5, 6	1	1.16	.81	.50	59	.24	Nickel	Gold (C)	1216-015-N59E	A/17
7	1	1.16	.68	.50	59	.11	Nickel	Gold	1216-021-N590-2	A/17
7	1	1.16	.68	.50	59	.11	Nickel	Gold (C)	1216-021-N591	A/17
7	1	1.16	.81	.50	59	.24	Nickel	Gold (C)	1216-021-N59E	A/17
9	1	1.16	.68	.50	59	.11	Nickel	Gold	1216-036-N590	A/17
9	1	1.16	.68	.50	59	.11	Nickel	Gold (C)	1216-036-N591-5	A/18
11	1	1.16	.68	.50	59	.11	Nickel	Gold	1216-038-N590-2	A/18
11	1	1.16	.68	.50	59	.11	Nickel	Gold (C)	1216-038-N591-1	A/18

Heli-Grip for Flexible Cable

5, 6 [§]	1	1.16	.81	.50	59	.24	Nickel	Silver (C)	1216-018-N595	E/03
RG-223	1	1.16	.81	.50	59	.24	Nickel	Silver (C)	1216-015-N595-1	E/03
7	1	1.16	.81	.50	59	.24	Nickel	Silver (C)	1216-019-N595	E/03
8A	1	1.16	.81	.50	59	.24	Nickel	Silver (C)	1216-029-N595	E/03
8B	1	1.16	.81	.50	59	.24	Nickel	Silver (C)	1216-043-N595	E/03
9	1	1.16	.81	.50	59	.24	Nickel	Silver (C)	1216-037-N595	E/03
10	1	1.16	.81	.50	59	.24	Nickel	Silver (C)	1216-100-N595-2	E/03
11	1	1.16	.81	.50	59	.24	Nickel	Silver (C)	1216-038-N595	E/03

Crimp Type for Flexible Cable

5	2	1.31	.68	.50	59	.11	Nickel	Gold	1219-017-N590	B/13
6	2	1.31	.68	.50	59	.11	Nickel	Gold	1219-013-N590-2	B/13
7	2	1.31	.68	.50	59	.11	Nickel	Gold	1219-020-N590	B/13

Solder-Clamp for Semi-Rigid Cable

13	1	1.16	.68	.50	59	.11	Nickel*	Gold	1216-031-N593	F/08
14	1	1.16	.68	.50	59	.11	Nickel*	Gold	1216-025-N593	F/07

[§]Except RG-223/U.

* Solder ferrule is gold plated.

(C) in contact plating column indicates captive contact.