

MCX Connectors (Continued)

Right Angle Cable Plug, Solder

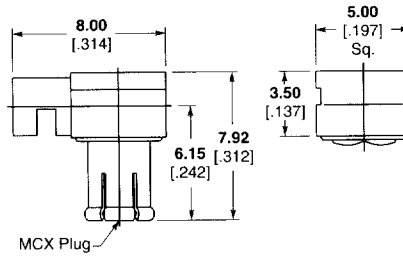
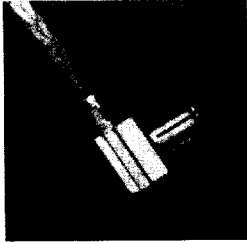

Cable	Plating	M/A-COM Model No.	Part No.
RG-174/U, 188/U, 316/U	Gold	5807-5001-09	1060788-1

Straight Cable Plug, Crimp

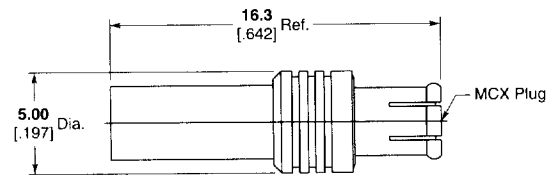
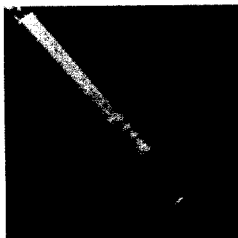

Cable	Plating	M/A-COM Model No.	Part No.
RG-178/U, 196/U	Nickel	5831-5002-10	1060869-1
	Gold	5831-5002-09	1060868-1
RG-174/U, 188/U, 316/U	Nickel	5831-5003-10	1060872-1
	Gold	5831-5003-09	1060871-1
RD-316	Nickel	5831-7316-10	1060875-1
	Gold	5831-7316-09	1060875-2

Note: For full crimp attachment consult AMP

Right Angle Cable Plug, Crimp

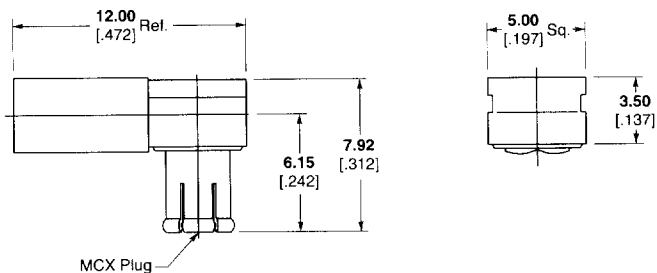
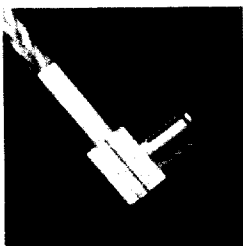

Cable	Plating	M/A-COM Model No.	Part No.
RG-178/U, 196/U	Nickel	5837-5030-10	1329293-1
	Gold	5837-5030-09	1329293-2
RG-188/U, 316/U	Nickel	5837-5025-10	1330723-1
RG-179/U, RG-187/U	Gold	5837-5025-09	1330723-3
RD-316	Nickel	5837-5031-10	1363301-1
	Gold	5837-5031-09	1363301-2