

# P-CN CONNECTORS

## Features:

- Low insertion loss
- Low back reflection loss
- Easy to handle
- Customer defined specifications
- Environmentally stable

## Applications:

- Telecommunications
- Local area network
- Fiber to the home
- Fiber optic sensors
- Testing instruments
- CATV



## Performance Specifications:

ITEM	Connector Parts	
	Singlemode	Multimode
Mode Type	Singlemode	Multimode
Typical Insertion Loss, dB	0.15	0.3
Typical Return Loss(*), dB	-50	—
Operating Temperature, °C	-40 ~ +75	
Storage Temperature, °C	-55 ~ +85	

Note : \* for convex polishing only

CONNECTORS

Mechanical Drawings:

Unit: mm

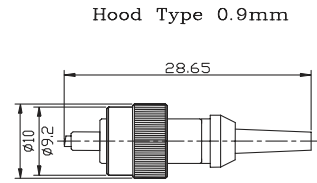
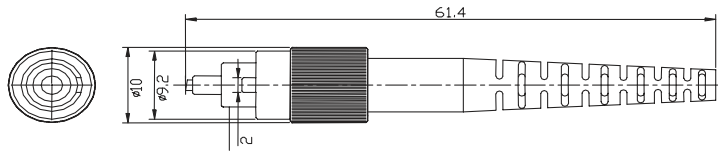

Hood Type 0.9mm

P-CN-AP-□□-□□□□-□□□□

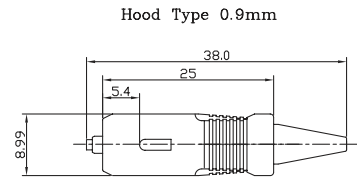
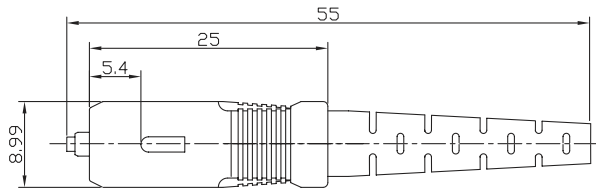
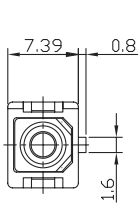

Hood Type 0.9mm

P-CN-AS-□□-□□□□-□□□□

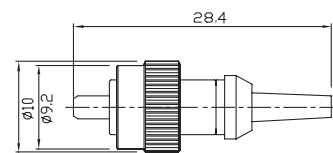
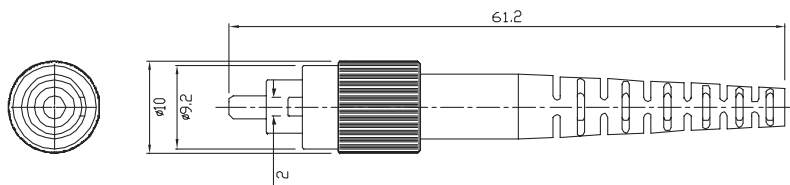

Hood Type 0.9mm

P-CN-FC-□□-□□□□-□□□□

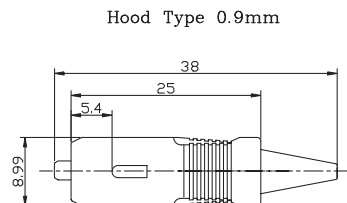
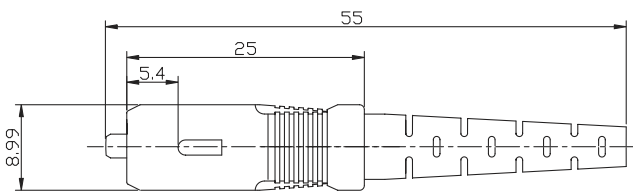
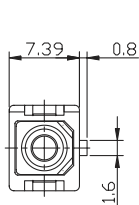

Hood Type 0.9mm

P-CN-SC-□□-□□□□-□□□□

# CONNECTORS

## Mechanical Drawings:

Unit: mm

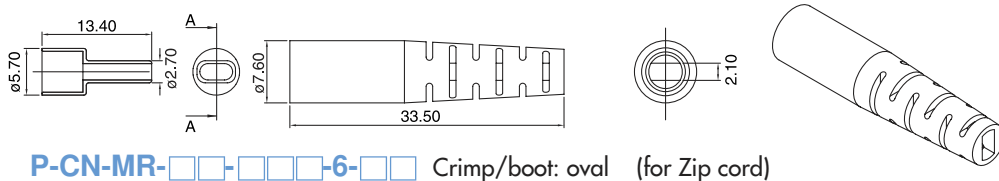
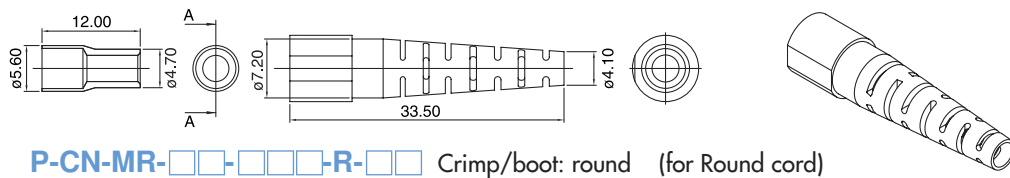
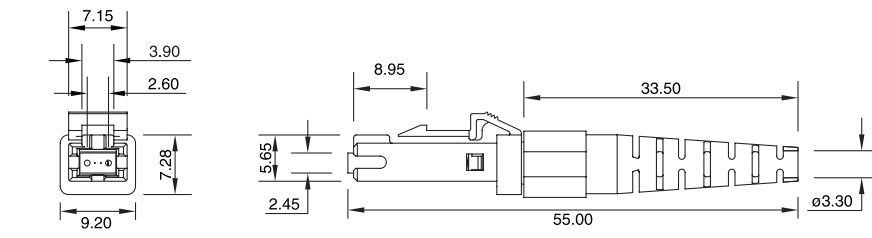
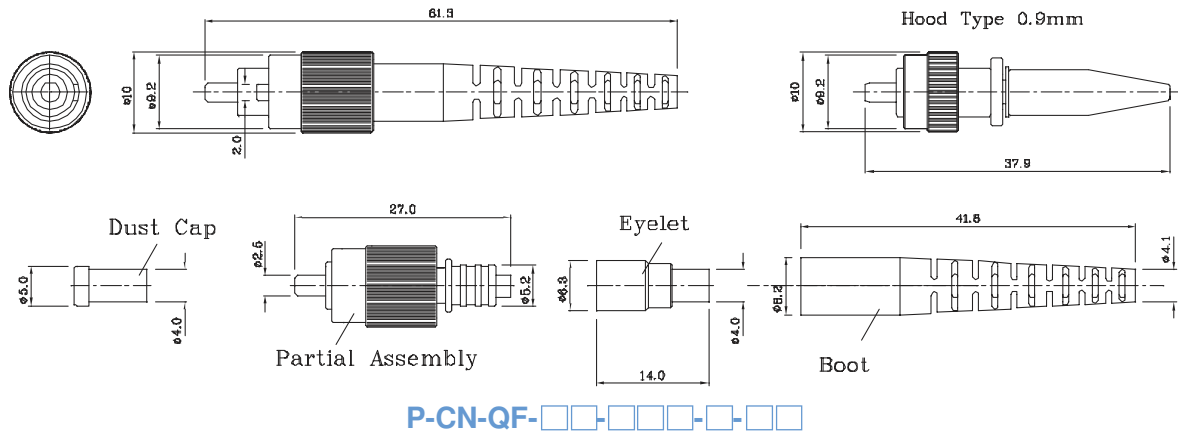
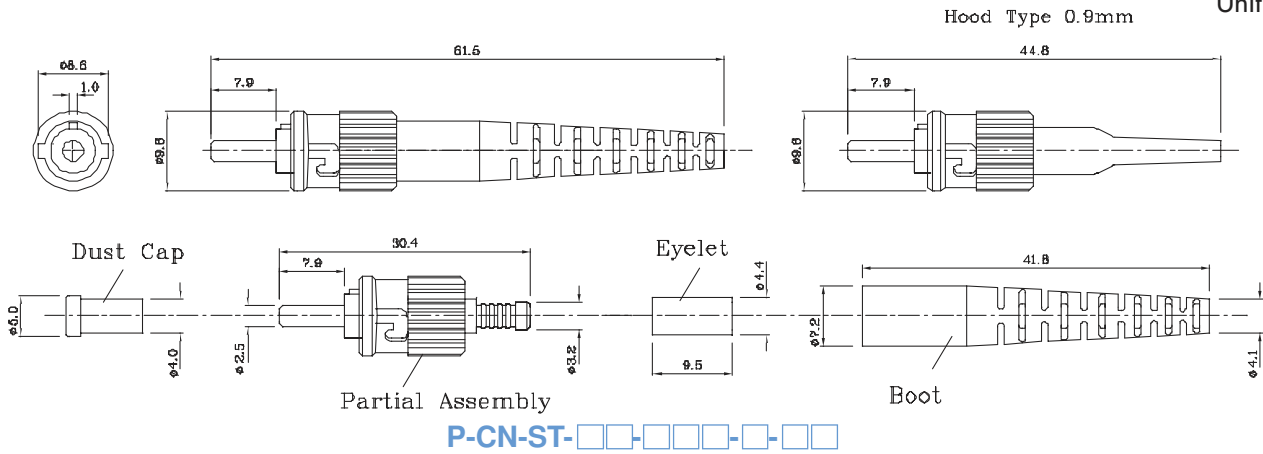

CONNECTORS

Mechanical Drawings:

Unit: mm

Hood Type 0.9mm

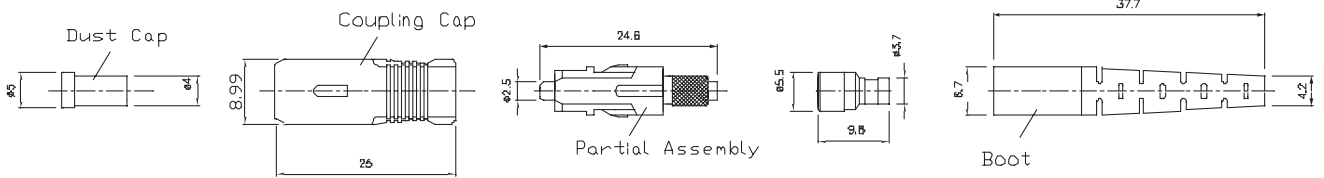
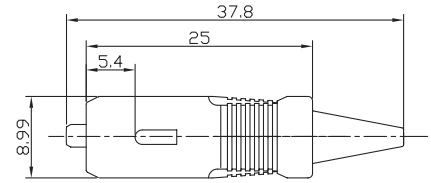
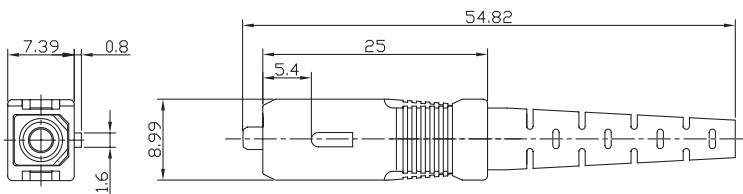

P-CN-QS-□□-□□□□-□-□□

Hood Type 0.9mm

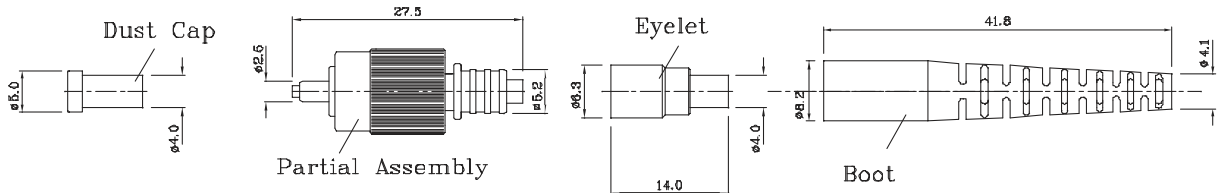
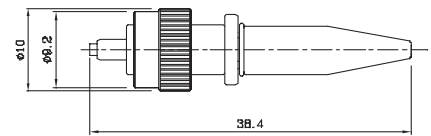
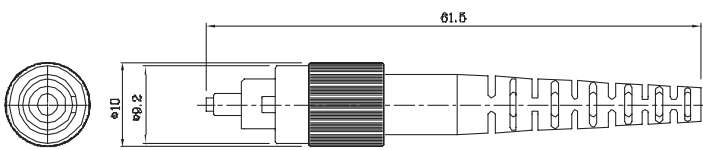

P-CN-QP-□□-□□□□-□-□□

# CONNECTORS

## Mechanical Drawings:

Unit: mm

Hood Type 0.9mm

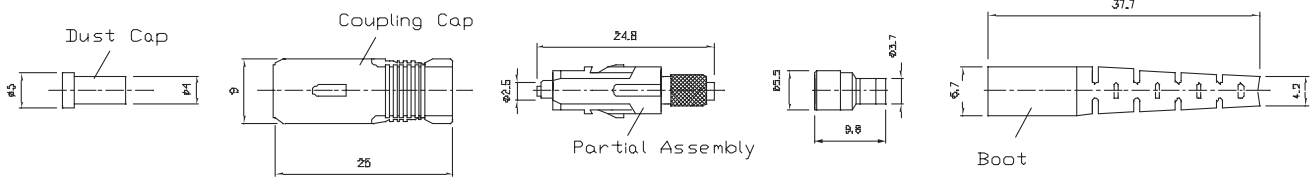
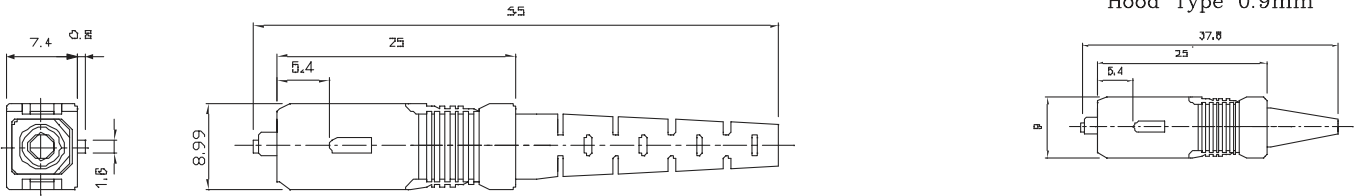

P-CN-QC-□□-□□□□-□□□□

Hood Type 0.9mm

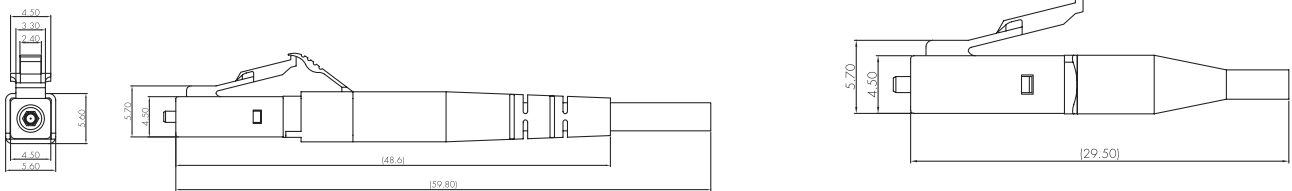

P-CN-QL-□□-□□□□-□□□□

Hood Type 0.9mm

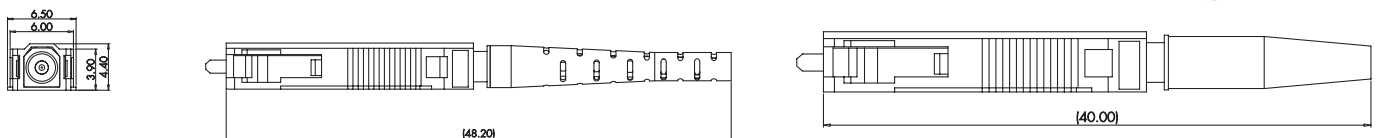

P-CN-MU-□□-□□□□-□□□□

# CONNECTORS

## Mechanical Drawings:

P - CN -  -  -  -  -

**Connector Type**

- AP FC/APC type (with non-pre-Angle,Step Ferrule)
- AS SC/APC type (with non-pre-Angle,Step Ferrule)
- FC FC type
- SC SC type
- S2 SC2 type
- QF Quick assembly FC type
- QS Quick assembly SC type
- QP Quick assembly FC/APC type (with non-pre-Angle Step Ferrule)
- QC Quick assembly SC/APC type (with non-pre-Angle Step Ferrule)
- QL Quick assembly LC type
- ST ST type
- LC LC simplex type
- DL duplex quick assembly LC type
- MU MU simplex type
- DM MU duplex type
- MR MTRJ Female
- MS MTRJ Male
- XX Others, please specify

**Ferrule Material**

- M Metal
- C Ceramic (Zirconia)
- P Plastic
- X Others, please specify

**Mode Type**

- S Singlemode
- M Multimode

**Ferrule Inner Diameter**

- 125 125µm
- 126 126µm
- 127 127µm
- 12h 125.5µm
- XXX Others, please specify

**Hood Type**

- |   |       |   |                            |   |                               |
|---|-------|---|----------------------------|---|-------------------------------|
| 1 | 0.9mm | 2 | 2.4mm                      | 6 | 3.0mm (MTRJ-oval crimp/boot)  |
| 3 | 3.0mm | 4 | 3.0mm (Strain relief boot) | R | 3.0mm (MTRJ-round crimp/boot) |
| 5 | 2.0mm |   |                            |   |                               |

**Hood Color**

- BL Black
- GN Green
- BU Blue
- RE Red
- BG Beige
- WH White
- XX Others, please specify