

REV.	DESCRIPTION	DATE
A	RELEASE	May 3, 2000
B	MATERIAL MODIFY	Jun. 1, 2001
C	DRAW MODIFY	May. 20, 2003
D	DRAW MODIFY	May .03 .2004

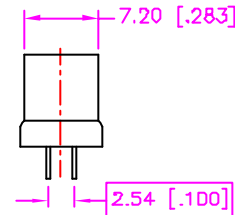
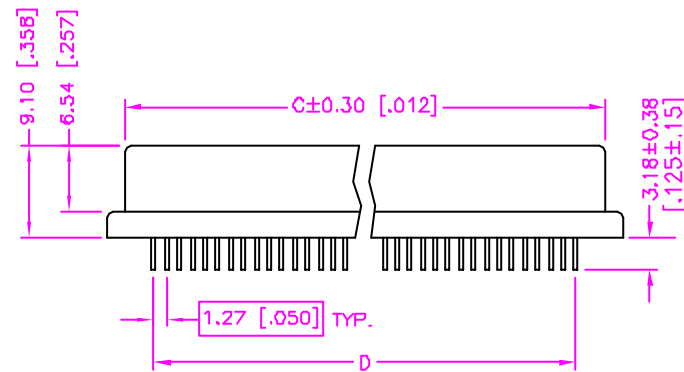
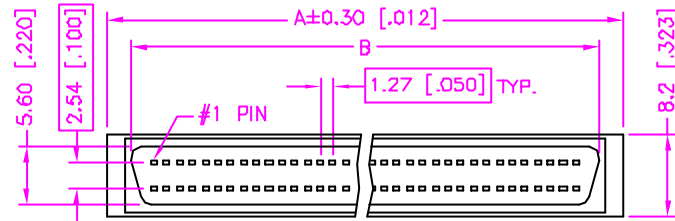

MATERIALS

1. HOUSING : THERMOPLASTIC (UL 94V-0), BLACK.
2. TERMINAL : COPPER ALLOY. (t=0.40mm)

SPECIFICATION

1. CURRENT RATING : 1 AMP. MAX.
2. DIELECTRIC WITHSTANDING VOLTAGE : 500V AC R.M.S. FOR ONE MINUTE.
3. INSULATION RESISTANCE : 1000M OHMS MIN. AT 500V DC.
4. OPERATING TEMPERATURE : -20°C TO +85°C.

ORDER INFORMATION :

10 - 01 0 - ** - * T

SERIES CODE | P.C.B. LAYOUT STYLE | NUMBER OF POSITION | TIN PLATING ON SOLDER TAIL | CONTACT PLATING OPTIONS

0 : DUAL ROWS

1 : GOLD FLASH
2 : .000010" GOLD
3 : .000015" GOLD
5 : .000030" GOLD

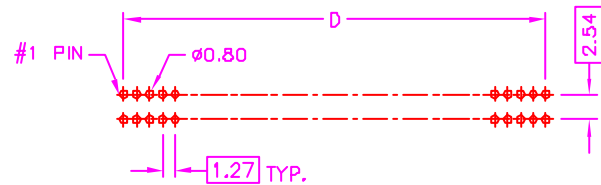

RECOMMEND P.C.B. LAYOUT
TOP VIEW

Number Of Position	DIMENSIONS			
	A	B	C	D
50	39.78[1.566]	34.65[1.372]	36.22[1.426]	30.48[1.200]
68	51.60[2.031]	46.50[1.831]	47.70[1.878]	41.91[1.650]
80	58.96[2.321]	53.90[2.122]	55.40[2.181]	49.53[1.950]

TOLERANCE D=±.30 [.012] .00=±.20 [.008] .000=±.XXX .0000=±. ANG.=±3°	DRAWER <i>Judy</i> CHECK <i>Eric</i> APP'D <i>Lion</i>	 Astron WWW.ASTRON.COM.TW NAME SCSI SERIES PIN TYPE, DUAL ROWS, MALE VERTICAL, ALL PLASTIC
UNITS : mm [inch]	PRODUCT SPEC. —	
SCALE NONE	SIZE A4	DRAW NO. C451-0001
SHEET 1 OF 1	REV. D	09006