

POWER DIVIDERS, RESISTIVE

SMA, up to 18 GHz, 1 Watt

SPECIFICATIONS:

Models: 6014-01, 6014-02 & 6014-03

RoHS
Compliant

Electrical:	
Frequency Range _____	See Below
Standard Freq. Values _____	6, 12.4 and 18 GHz
Input VSWR _____	See Below
Impedance _____	50 Ohms
Insertion Loss _____	See Below
Phase Tracking _____	See Below
Input Power _____	1 Watt Avg. @ 25°C
	Derated Linearly to 0 Watts @ +125°C
Operating Temp Range _____	-65°C to +125°C
Mechanical:	
SMA Connectors _____	Passivated Stainless Steel
	Mate IAW MIL-STD-348
Housing _____	Passivated Stainless Steel
Conductors _____	Gold Plated Beryllium Copper



Model Number: 6014-01

Frequency Range _____ DC - 12.4 GHz
 Input VSWR _____ 1.20:1 Max.
 Insertion Loss _____ 6dB Nominal
 Phase Tracking _____ $\pm 2^\circ$
 (between output ports)
 Amplitude Tracking _____ 0.4dB

Model Number: 6014-02

Frequency Range _____ DC - 18 GHz
 Input VSWR _____ 1.30:1 Max.
 Insertion Loss _____ 7.5dB Nominal
 Phase Tracking _____ $\pm 3^\circ$
 (between output ports)
 Amplitude Tracking _____ 0.5dB

Model Number: 6014-03

Frequency Range _____ DC - 6 GHz
 Input VSWR _____ 1.20:1 Max.
 Insertion Loss _____ 6dB Nominal
 Phase Tracking _____ $\pm 2^\circ$
 (between output ports)
 Amplitude Tracking _____ 0.4dB

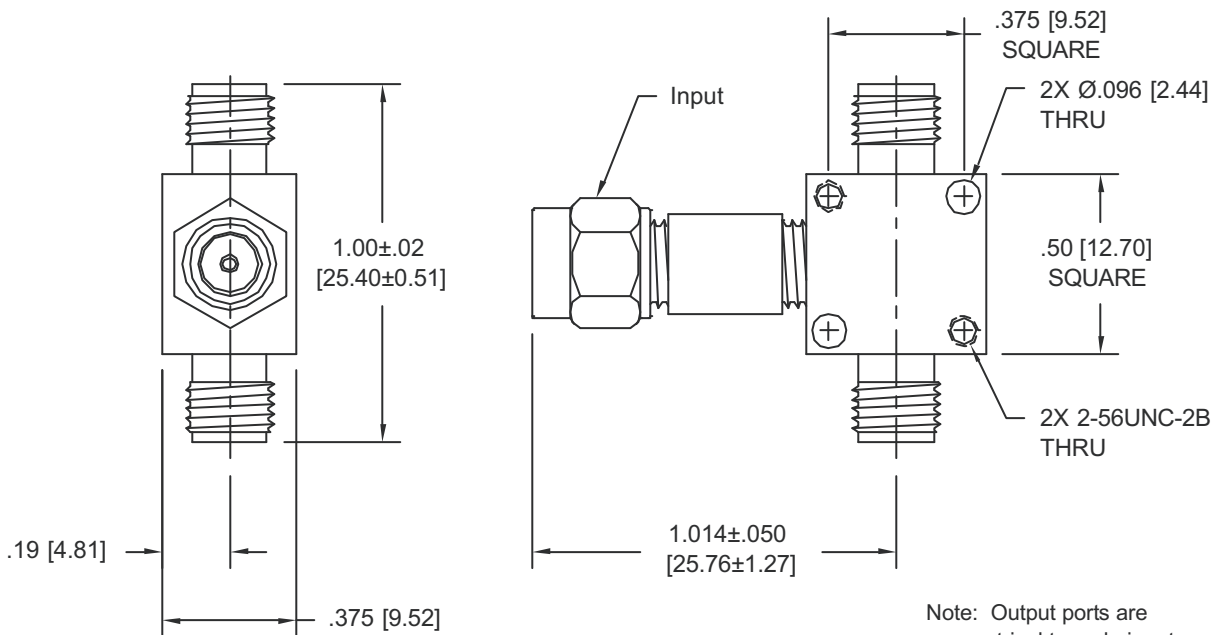

Note: Dimensions in Brackets are Expressed in Millimeters and are for Reference Only.
 Design specifications are subject to change without notice.
 Contact factory for technical specifications before purchasing or use.

6014: REV E



Aeroflex / Inmet, Inc. • 300 Dino Drive, Ann Arbor, MI 48103 • U.S.A.
 888-244-6638 or 734-426-5553 • FAX: 734-426-5557
 www.aeroflex.com/inmet • inmet-sales@eroflex.com