

DASH NO. M CODE MADE FROM

GSD

KH-59-78

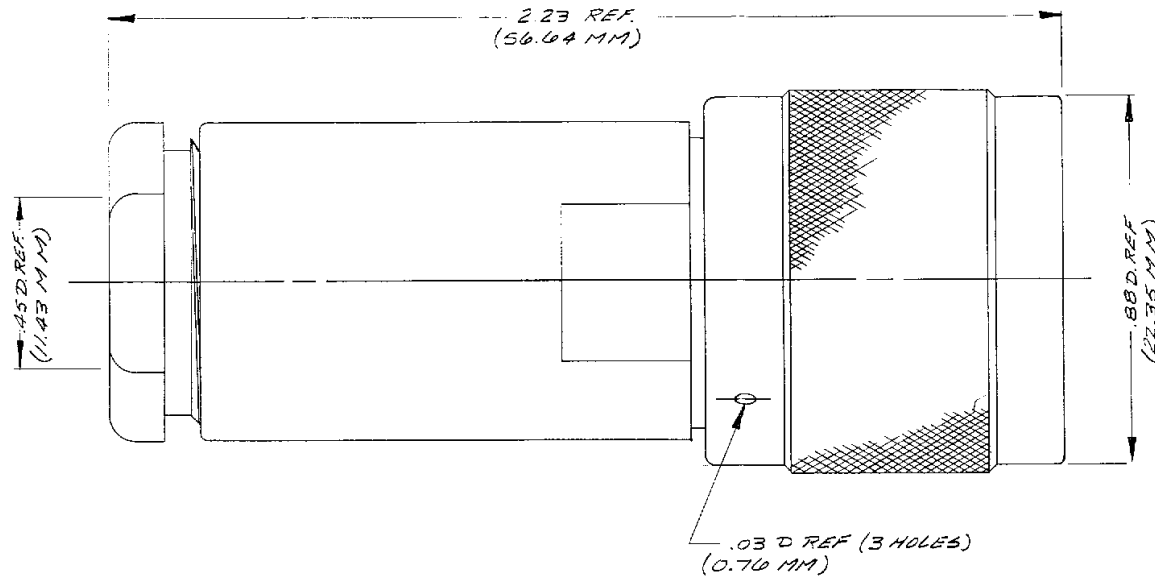

NOTES:

1. FOR USE WITH RG-9, 9A, 9B, 21A, 225 & 303/U CABLES.
2. FOR CABLING INSTRUCTIONS SEE CP-239A.
3. FOR CABLE TRIMMING USE KTJ-23 & KTD-82.
4. FOR CRIMPING USE CRIMP DIE SIZE 0A.
5. TO USE WITH RG-9, 21A & 225/U CABLE GROUPS OMIT K-BRIP SLEEVE GASKET.
6. MATERIALS:

INSULATOR — TEFLON, L-P-403.
 C-RING — PHOSPHOR BRONZE, QQ-B-750.
 OUTER CONTACT — BER. LOPPER, QQ-C-530.
 K-BRIP SLEEVE — COMMERCIAL BRONZE TUBE ALLOY 220.
 GASKETS — SILICONE RUBBER, ZZ-R-705.
 ALL OTHER METAL PARTS — BRASS, QQ-B-020.

7. FINISHES:

CENTER CONTACT — HARD GOLD PLT. PER MIL-B-45204.
 ALL OTHER METAL PARTS — SILVER PLT PER QR-S-305.

8. ELECTRICAL CHARACTERISTICS:

NOMINAL IMPEDANCE — 50Ω.
 FREQUENCY RANGE — DC TO 11GHz.
 WORKING VOLTAGE — 1000 VOLTS RMS.

UNLESS OTHERWISE SPECIFIED:

- | | |
|--|--|
| 1. TOLERANCES FRACTIONS & 2 PLACE DECIMALS ± .010 | 2. REMOVE ALL BURRS, BREAK SHARP EDGES .005 MAX. |
| 3 PLACE DECIMALS ± .004 | 3. NO FILLETS PERMITTED. |
| ANGLES ± 0°30' | 4. SURFACE ROUGHNESS 63 MICROINCHES RMS MAX. |
| T. I R CONCENTRICITY OF ANY 2 DIAMETERS MAY NOT EXCEED HALF THE SUM OF THEIR TOLERANCES. | 5. ALL DIMENSIONS PRIOR TO PLATING. |
| | 6. ALL PLATING IN ACCORDANCE WITH KER 10004. |

GSD

REVISIONS

ISSUE	CHANGES
2.	CN 25808A MB 14 MAR 84

GSD

SCALE 4:1

APPROX SURFACE AREA

USED ON

REF

MIN PLUG

DRAWN JF	DATE 22 NOV 85
APPR MJB	DATE 25 NOV 85
APPR	DATE

KINGS
ELECTRONICS CO., INC.
DURHAM, N.C. 27704

KH-59-78