

# PCB Terminal Strips, Series 256, Pin Spacings 5/5.08 mm / 0.2 in; 7.5/7.62 mm / 0.3 in; 10/10.16 mm / 0.4 in

CAGE CLAMP®

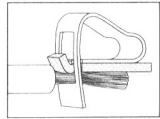

Front-entry

<p><b>Pin spacing 5/5.08 mm / 0.2 in</b> 0.08 – 2.5 mm<sup>2</sup>   AWG 28 – 12 250 V/4 kV/3, 16 A   300 V, 15 A 500 V/4 kV/2, 16 A   300/600 V, 15/5 A</p> <p> 5 – 6 mm / 0.22 in</p> <p>*   </p>	<p><b>Pin spacing 7.5/7.62 mm / 0.3 in</b> 0.08 – 2.5 mm<sup>2</sup>   AWG 28 – 12 400 V/6 kV/3, 16 A   300 V, 15 A 800 V/6 kV/2, 16 A   300/600 V, 15/5 A</p> <p> 5 – 6 mm / 0.22 in</p> <p>*   </p>	<p><b>Pin spacing 10/10.16 mm / 0.4 in</b> 0.08 – 2.5 mm<sup>2</sup>   AWG 28 – 12 500 V/6 kV/3, 16 A   300 V, 15 A 1000 V/6 kV/2, 16 A   300/600 V, 15/5 A</p> <p> 5 – 6 mm / 0.22 in</p> <p>*   </p>
---	---	--

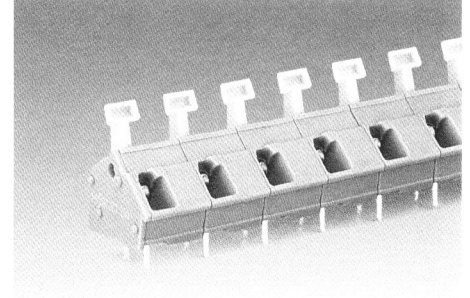
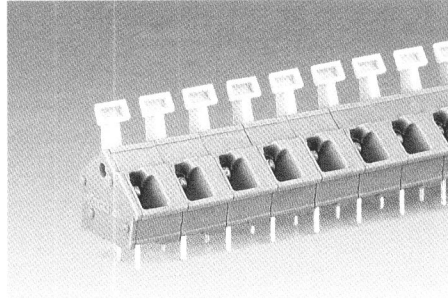
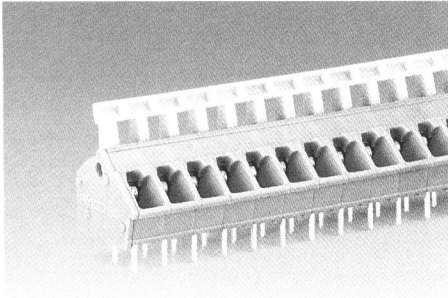

No. of poles	Item-No.	Pack.-unit pcs	No. of poles	Item-No.	Pack.-unit pcs	No. of poles	Item-No.	Pack.-unit pcs
<b>Terminal strips, grey, standard lengths, 2 solder pins/pole</b>			<b>Terminal strips, grey, standard lengths, 2 solder pins/pole</b>			<b>Terminal strips, grey, standard lengths, 2 solder pins/pole</b>		
2	256-402	400 (4 x 100)	2	256-502	280 (4 x 70)	2	256-602	200 (4 x 50)
3	256-403	280 (4 x 70)	3	256-503	180 (4 x 45)	3	256-603	140 (4 x 35)
4	256-404	200 (4 x 50)	4	256-504	140 (4 x 35)	4	256-604	100 (4 x 25)
5	256-405	160 (4 x 40)	5	256-505	120 (4 x 30)	5	256-605	80 (4 x 20)
6	256-406	140 (4 x 35)	6	256-506	100 (4 x 25)	6	256-606	60 (4 x 15)
7	256-407	120 (4 x 30)	7	256-507	80 (4 x 20)	7	256-607	60 (4 x 15)
8	256-408	100 (4 x 25)	8	256-508	60 (4 x 15)	8	256-608	60 (4 x 15)
9	256-409	100 (4 x 25)	9	256-509	60 (4 x 15)	9	256-609	40 (4 x 10)
10	256-410	80 (4 x 20)	10	256-510	60 (4 x 15)	10	256-610	40 (4 x 10)
12	256-412	60 (4 x 15)	12	256-512	40 (4 x 10)	12	256-612	40 (4 x 10)
16	256-416	60 (4 x 15)	16	256-516	40 (4 x 10)	16	256-616	20 (4 x 5)
24	256-424	40 (4 x 10)	24	256-524	20 (4 x 5)	24	256-624	20 (4 x 5)
36	256-436	20 (4 x 5)						
48	256-448	20 (4 x 5)						

Additional item-No. for terminal strips with 5.5 mm / 0.217 in in long solder pins  
.../332-000

For assemblies in other lengths and colors, please contact factory.  
Test adapters see page 2.17.

Additional item-No. for terminal strips with 5.5 mm / 0.217 in in long solder pins  
.../332-000

For assemblies in other lengths and colors, please contact factory.  
Test adapters see page 2.17.

Additional item-No. for terminal strips with 5.5 mm / 0.217 in in long solder pins  
.../332-000

For assemblies in other lengths and colors, please contact factory.  
Test adapters see page 2.17.

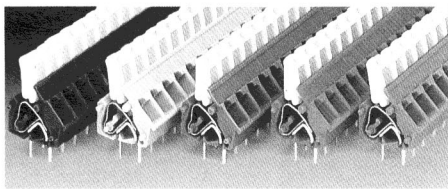

- Additional item-Nos. for colored terminal strips
- blue .../...-006 ①
  - dark grey .../...-008
  - light grey .../...-009
  - orange .../...-012
  - light green .../...-017

① With blue insulating housings suitable for EEx i applications (only suitable for pin spacings 7.5/7.62 mm / 0.3 in and 10/10.16 mm / 0.4 in)

- Ordering examples
- Terminal strip, pin spacing 5/5.08 mm / 0.2 in 8-pole, orange: **256-408/000-012**
  - Terminal strip with 5.5 mm / 0.217 in in long solder pins, pin spacing 7.5/7.62 mm / 0.3 in 12-pole, blue: **256-512/332-006**

**Dimensions (in mm)** (Adjustment of pin spacing is made by pulling on the end blocks so that they expand to satisfy the hole centers required.)

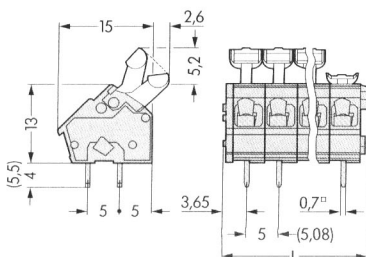

Diameter of drilled hole: 1.1<sup>+0.1</sup> mm  
L = (No. of poles x pin spacing) + 2.9 mm

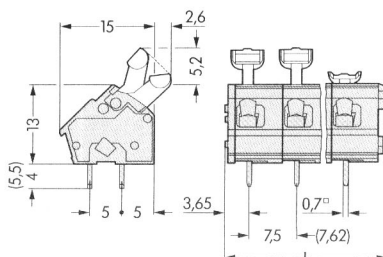

Diameter of drilled hole: 1.1<sup>+0.1</sup> mm  
L = (No. of poles x pin spacing) + 2.9 mm

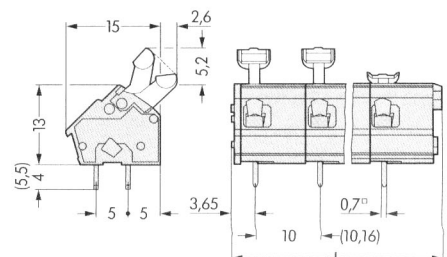

Diameter of drilled hole: 1.1<sup>+0.1</sup> mm  
L = (No. of poles x pin spacing) + 2.9 mm