

RED INDICATES ORIGINAL

DISK # KS	DWG SIZE C	DATA CONTAINED IN THIS DOCUMENT IS PROPRIETARY TO TROMPETER ELECTRONICS INC. AND SHALL NOT BE DISCLOSED, COPIED OR USED FOR PROCUREMENT OR MANUFACTURE WITHOUT EXPRESS WRITTEN PERMISSION.			REVISIONS			310-0038	SH 1
		REV	EO	DESCRIPTION	DWN	APPROVED	DATE		
		M	9322	-7, -23, -24A, -25A, -26, -32, -33, -42, -43, -56, -59, -60, -64, ASSEMBLE PER BLOCK WAS TAI-104; AND GENERAL UPDATE	DKC	B.M.		6-3-91	

DASH NO	CABLES ACCOMMODATED	A DIM	B DIM	C FLATS	D FLATS	E DIA	ASSEMBLE PER						
-7	TRC-50-2 TRC-75-2	1.110	.096	.438	.438	.500	TAI-189						
-8	8227, BELDEN	1.691	.130	.625	.688	.750	TAI-103						
-9	TWC-78-2 TWC-124-2	1.110	.096	.438	.438	.500	TAI-102						
-A9	BL782, TIMES BL982, TIMES BL1242, TIMES												
-10	RG-22 754E, AT&T												
-11	760A, AT&T	1.691	.130	.625	.688	.750	TAI-103						
-12	16 PEVL, AT&T VI-AL, GENERAL												
-13	TRF-59, TIMES												
-13A	8232, BELDEN												
-14	8233, BELDEN												
-23	250-3884, MICRODOT												
-24	202-3934, MICRODOT												
-24A	9530A5117, RAYCHEM												
-25	T-43M, GENERAL												
-25A	5021H5331, RAYCHEM												
-26	7028A5518, RAYCHEM												
-27	T19TPSJ2619EN, WOVEN 202-3927, MICRODOT 202-3942, MICRODOT							1.110	.096	.438	.438	.500	TAI-102
-29	TWC-78-1/TWC-124-1A												
-30	761A, AT&T 8441, BELDEN												
-32	TRC-50-1												
-33	TRC-75-1												
-42	21-204, ESSEX 4463, CONSOLIDATED												
-43	250-4044/250-4045 293-3930, MICRODOT												
-45	M27500-22TE2T14 1100-66F, STANDARD												
-46	9860, BELDEN	1.691	.130	.625	.688	.750	TAI-103						
-47	M17-176-00002												
-49	TWAC-78-1F2												
-54	89207, BELDEN												
-55	89272, BELDEN												
-56	6C8756C1, GRUMMAN												
-57	6C8756B1, GRUMMAN												
-58	6C875TM24H, GRUMMAN												
-59	6C875LN1, GRUMMAN												
-60	M17-177, THERMATICS 380-10045, BOEING							1.110	.096	.438	.438	.500	TAI-103
-64	7528A5314, RAYCHEM												

FIG 1 Δ
-9 SHOWN

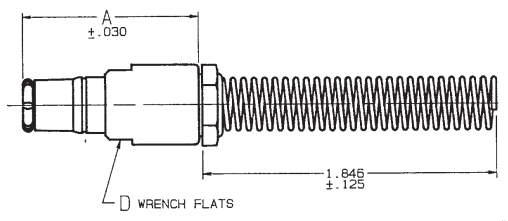
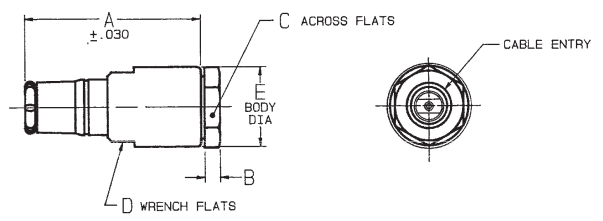

FIG 2
-9 SHOWN



INCH	MM	INCH	MM
.005	0.13	.323	8.20
.030	0.76	.345	8.76
.096	2.44	.347	8.81
.125	3.18	.352	8.94
.130	3.30	.362	9.19
.132	3.35	.438	11.13
.145	3.68	.455	11.56
.164	4.17	.475	12.07
.183	4.65	.485	12.32
.191	4.85	.490	12.45
.196	5.03	.500	12.70
.200	5.08	.625	15.88
.217	5.51	.688	17.48
.235	5.97	.750	19.05
.274	6.95	1.110	28.19
.285	7.24	1.691	42.95
.300	7.62	1.846	46.89

CABLE ENTRY DIA TABLE			
DASH NO	ENTRY DIA	DASH NO	ENTRY DIA
-7	.274	-30	.235
-8	.345	-32	.191
-9	.285	-33	.217
-A9	.285	-42	.300
-10	.455	-43	.200
-11	.347	-45	.183
-12	.485	-46	.475
-13	.362	-47	.164
-13A	.352	-49	.132
-14	.490	-54	.323
-23	.183	-55	.250
-24	.191	-56	.191
-24A	.200	-57	.191
-25	.285	-58	.198
-25A	.285	-59	.198
-26	.191	-60	.217
-27	.145	-64	.183
-29	.191		

MODEL NO	DASH NO/CABLE GROUP																
PL73 (TWINAX)	-8	-9	-A9	-10	-11	-12	-24	-25	-27	-29	-30	-45	-46	-47	-49	-54	-55
PL73 (TRIAx)	-7	-13	-13A	-14	-23	-24A	-25A	-26	-32	-33	-42	-43	-56	-57	-59	-60	-64
PL73 (QUADRAx)	-58																

Δ IF BEND RELIEF SPRING REQD (SEE FIG 1)
ADD SUFFIX "BR" TO MODEL NO (NOT AVAILABLE)
WITH CABLE GROUPS -8, -10, -11, -12, -13,
-13A, -14, -46 & -54)

- Δ CLAMP NUT OMITTED
- PUSH-ON CONCENTRIC TWINAX/TRIAx TRB CABLE PLUG
 - FINISH: TFS-1A (NICKEL)
 - ALL DIM ARE IN INCHES

QTY	DESCRIPTION	PART NUMBER	ITEM
TOL UNLESS SPECIFIED ..XX ± ..XXX ± .005 ..XXXX ANGLE±	TROMPETER ELECTRONICS, INC.	PL73/PL73BR	
DWN	DKC	S-23-91	DRAWING NO.
CHK	B.M.	S-24-91	14949
ENGR			310-0038
APPR			M

SCALE 2/1 DATE 10-18-79 SHEET 1 OF 2