

1N91
1N92
1N93

GERMANIUM RECTIFIERS



www.centrasemi.com

DESCRIPTION:

The CENTRAL SEMICONDUCTOR 1N91 series is a low-current germanium rectifier, mounted in an axial lead metal case, for applications requiring high efficiency and extremely low voltage drop.

MARKING: FULL PART NUMBER



DO-1 CASE

MAXIMUM RATINGS: ($T_A=25^\circ\text{C}$ unless otherwise noted)

	SYMBOL	1N91	1N92	1N93	UNITS
Peak Repetitive Reverse Voltage	V_{RRM}	100	200	300	V
DC Blocking Voltage	V_R	100	200	300	V
Average Forward Current ($T_A=55^\circ\text{C}$)	I_O		150		mA
Non-repetitive Peak Forward Surge Current	I_{FSM}		25		A
Operating Junction Temperature	T_J		-65 to +95		$^\circ\text{C}$
Storage Temperature	T_{stg}		-65 to +105		$^\circ\text{C}$

ELECTRICAL CHARACTERISTICS: ($T_A=25^\circ\text{C}$ unless otherwise noted)

SYMBOL	TEST CONDITIONS	MIN	MAX	UNITS
I_R	$V_R=\text{Rated } V_{RRM}$		220	μA
V_F	$I_F=150\text{mA}$		450	mV

1N91
1N92
1N93

GERMANIUM RECTIFIERS



DO-1 CASE - MECHANICAL OUTLINE

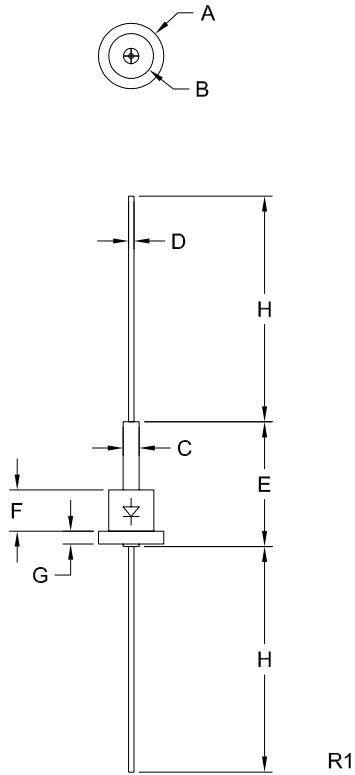

SYMBOL	INCHES		MILLIMETERS	
	MIN	MAX	MIN	MAX
A (DIA)	0.360	0.400	9.14	10.16
B (DIA)	0.245	0.280	6.22	7.11
C (DIA)	-	0.125	-	3.18
D (DIA)	0.027	0.035	0.69	0.89
E	-	0.725	-	18.42
F	0.220	0.260	5.59	6.60
G	-	0.075	-	1.91
H	1.000	1.625	25.40	41.28

DO-1 (REV: R1)

R1 (30-April 2014)