

REV.	DESCRIPTION	DATE
—	RELEASE	May 1, 2000
1	MATERIAL MODIFY	Jun. 1, 2001
2		

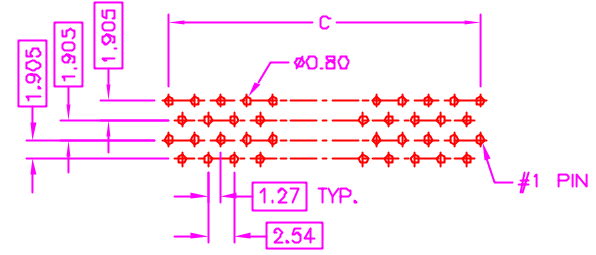

RECOMMEND P.C.B. LAYOUT (50 PINS)
BOTTOM VIEW

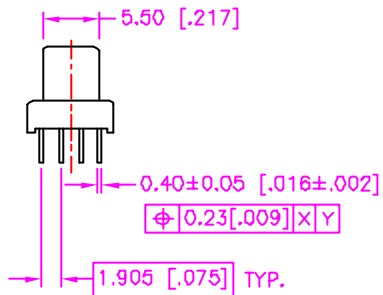
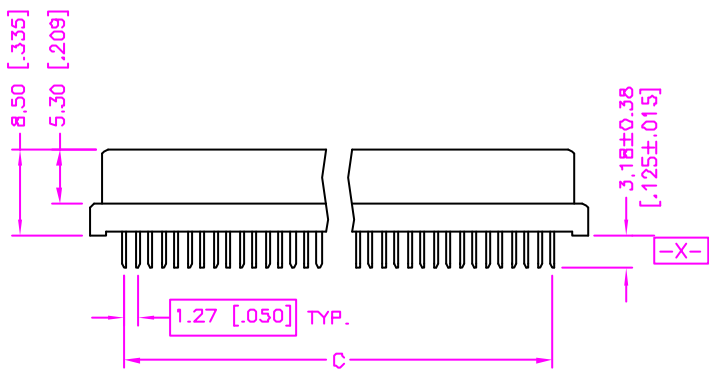
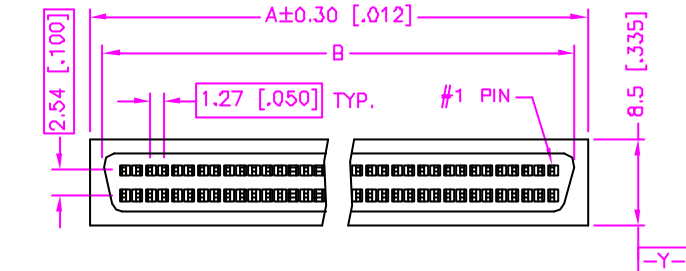
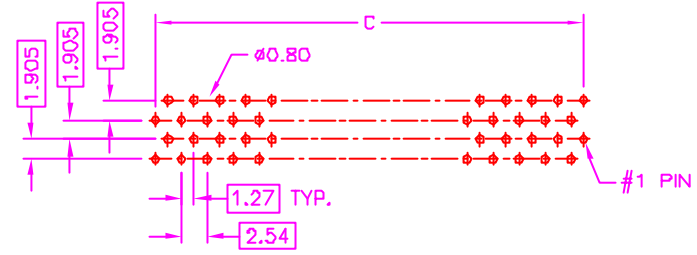

RECOMMEND P.C.B. LAYOUT (68, 80 PINS)
BOTTOM VIEW

MATERIALS

- HOUSING : THERMOPLASTIC (UL 94V-0), BLACK.
- TERMINAL : COPPER ALLOY. (t=0.40mm)

SPECIFICATION

- CURRENT RATING : 1 AMP. MAX.
- DIELECTRIC WITHSTANDING VOLTAGE : 500V AC R.M.S. FOR ONE MINUTE.
- INSULATION RESISTANCE : 1000M OHMS MIN. AT 500V DC. AT 500V DC.
- CONTACT RESISTANCE : 30m OHMS MAX.
- OPERATING TEMPERATURE : -20°C TO +85°C.
- DURABILITY : 500 CYCLES.

ORDER INFORMATION :

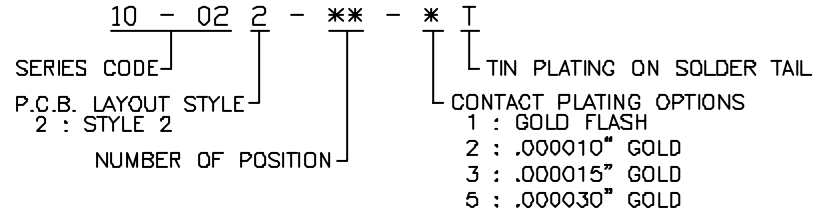

Number Of Position	DIMENSIONS		
	A	B	C
50	37.30 [1.469]	34.70 [1.366]	30.48 [1.200]
68	48.60 [1.913]	46.13 [1.816]	41.91 [1.650]
80	56.28 [2.216]	53.75 [2.116]	49.53 [1.950]

TOLERANCE .0±.30 [.012] .00±.20 [.008] .000±.XXX .0000±. ANG.±3°	DRAWER <i>Kathelin</i> CHECK <i>Jue</i> APP'D <i>Windy</i>	 ASTRON TECHNOLOGY CORP. SCSI SERIES PIN TYPE, STYLE 2, FEMALE VERTICAL, ALL PLASTIC
UNITS : mm [inch]	PRODUCT SPEC. 303-0005 303-0009	
SCALE NONE	SIZE A4	DRAW NO. C451-0004
SHEET 1 OF 1	REV. B	09006