

Quartz Crystal Units AT-Cut, 5 - 300 MHz

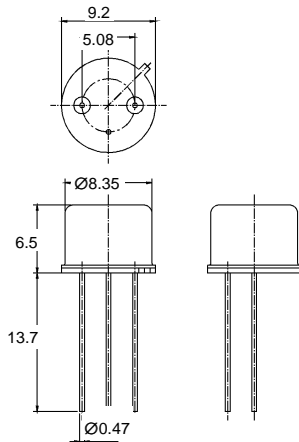

All dimensions in mm (max)

DIN 45110: T1A
 IEC 122-3: CK
 NFC 93-601: n° 12A
 MIL-H-10056: HC-35/U
 Welded metal enclosure
 (inert atmosphere)
 with wire leads

| HC-35/U | | | Temperature Stability in the Temperature Range | | | | | | Nom. Temp. ± 5°C ¹⁾ |
|----------|-----------------|---------|--|---------|---------------|---------|--------|--------|-----------------------------------|
| | | | -55°C...+105°C | | -20°C...+70°C | | | | |
| Overtone | Frequency [MHz] | Type | ± 50ppm | ± 25ppm | ± 20ppm | ± 10ppm | ± 7ppm | ± 5ppm | ± 2ppm |
| 1.OT | 5...10 | TO 71xx | 01 | 02 | 03 | 04 | 06 | ----- | 05 |
| | 10...30 | TO 71xx | 01 | 02 | 03 | 04 | 06 | 07 | 05 |
| 3.OT | 25...90 | TO 71xx | 11 | 12 | 13 | 14 | 16 | 17 | 15 |
| 5.OT | 60...150 | TO 71xx | 21 | 22 | 23 | 24 | 26 | 27 | 25 |
| 7.OT | 110...210 | TO 71xx | 31 | 32 | 33 | 34 | 36 | 37 | 35 |
| 9.OT | 150...300 | TO 71xx | 41 | 42 | 43 | 44 | 46 | 47 | 45 |

Calibration tolerance: ± 10 ppm

¹⁾ Nom. Temp. = Nominal temperature for oven application to be given with the order.

Motional Resistance R1

| Overtone | Frequency [MHz] | R1max [Ω] |
|----------|-----------------|-----------|
| 1. OT | 5...10 | 80 |
| 1. OT | 10...15 | 50 |
| 1. OT | 15...20 | 40 |
| 1. OT | 20...35 | 30 |
| 3. OT | 25...50 | 100 |
| 3. OT | 50...100 | 90 |
| 5. OT | 60...80 | 150 |
| 5. OT | 80...160 | 100 |
| 7. OT | 110...210 | 150 |
| 9. OT | 150...300 | 200 |

Standard resonance for fundamental crystals: load resonance with $C_L = 30 \pm 0.5\text{pF}$
 Overtone crystals: series mode
 Shunt capacitance: 5...10MHz: $C_0 = 2.2\text{pF} \pm 0.8\text{pF}$
 10...300MHz: $C_0 = 3.0\text{pF} \pm 1.0\text{pF}$

Crystal units with different tolerances or additional data upon request.



VECTRON
 INTERNATIONAL
 A DOVER TECHNOLOGIES COMPANY

166 Glover Avenue
 Norwalk, CT 06856

Tel: 1-88-VECTRON-1
 Fax: 1-888-FAX-VECTRON
 www.vectron.com