

SPRING & BUTTON CONTACTS

- Economical and reliable contacts are ideal for molded cases with self-contained battery compartments
- "Solder Tab" design for either wire lead or PC mounting
- Unique spring contacts adjust to variations in battery lengths
- Reliable spring contacts assure low contact resistance and a dependable connection
- Space saving, economical, excellent mechanical construction



MATERIAL:

Plate: .020 (.51) Steel, Nickel Plate **Spring:** Spring Steel, Nickel Plate

Refer to page 42 for Battery Contact Layout & Mounting Details

"AAA" · "AAAA" · "N" · "A23" · "A27"

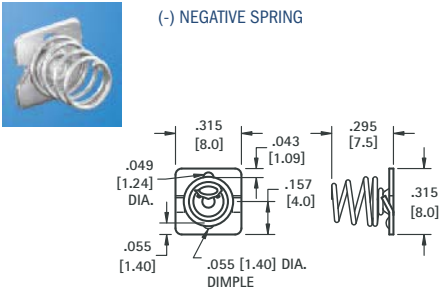

CAT. NO. 5203

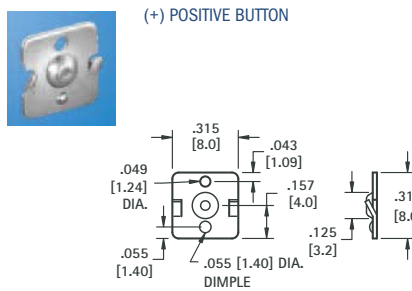

CAT. NO. 5225

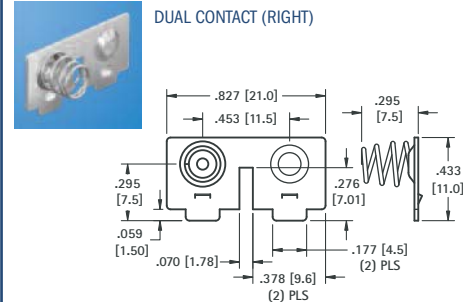

CAT. NO. 5213

(-) NEGATIVE SPRING WITH TAB

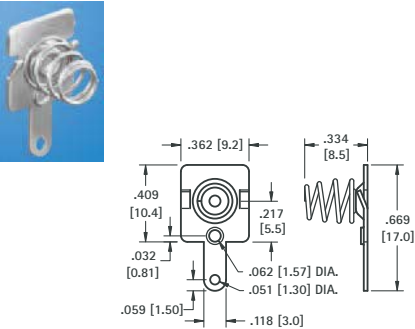

CAT. NO. 5204

(+) POSITIVE BUTTON WITH TAB

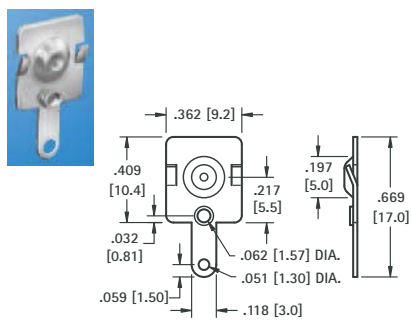

CAT. NO. 5226

DUAL CONTACT (LEFT)

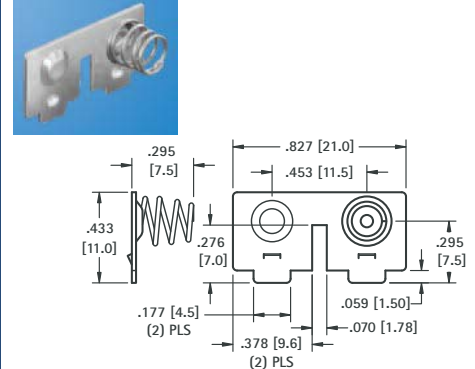

CAT. NO. 5214

"AA" · "CR2" · "A" · "17500" · "18350" · "18650"

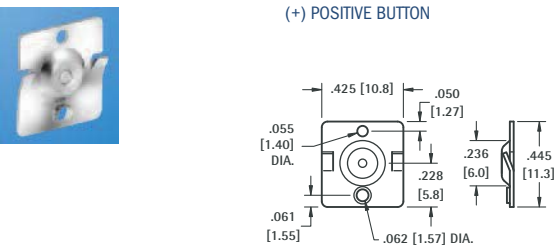

CAT. NO. 5224

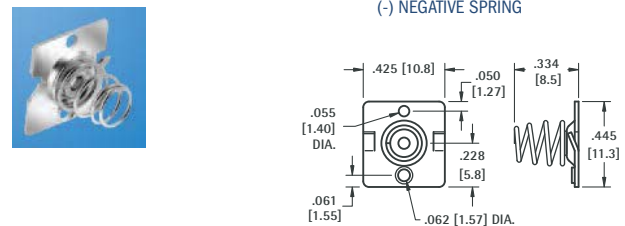

CAT. NO. 5202

"AA"

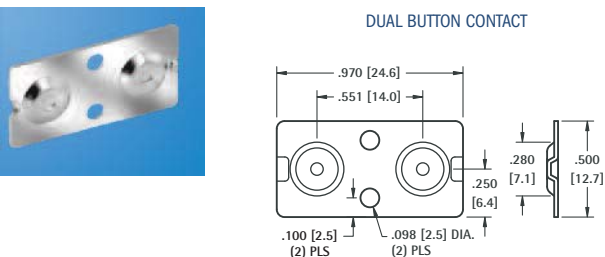

CAT. NO. 5227

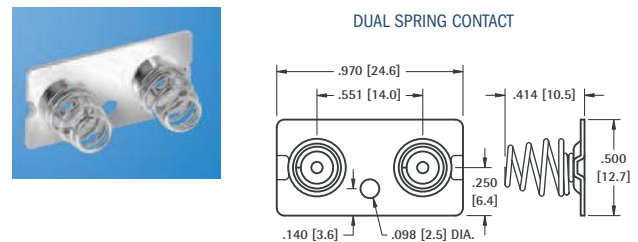

CAT. NO. 5228