

The connector interface meets MIL-STD-348.

Environmental

Temperature range -65°C ~ +165°C

Electrical characteristics:

Characteristic impedance : 50Ω

Working voltage : 250V max

Frequency range : 0-4GHz

Dielectric withstanding voltage : 750V

Contact resistance :

Center contact : ≤6mΩ

Outer contact : ≤1mΩ

Insulation resistance : ≥1000MΩ

Note:

Packaging: Tape & Reel.

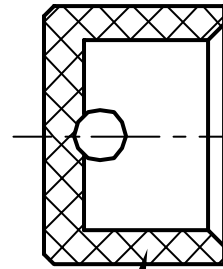

Adsorbable cap

|     |                 |          |        |     |        |
|-----|-----------------|----------|--------|-----|--------|
| 4   | Adsorbable cap  | PTFE     |        | 1   |        |
| 3   | Body            | Brass    | Gold   | 1   |        |
| 2   | Insulators      | PTFE     |        | 1   |        |
| 1   | Center contacts | Brass    | Gold   | 1   |        |
| NO. | Title/Name      | Material | Finish | QTY | Remark |

|  |         |                   |            |                     |           |  |
|--|---------|-------------------|------------|---------------------|-----------|--|
| Customer Code.<br>E  |         | Customer part NO. |            | <b>Amphenol CNT</b> |           |  |
| Unless otherwise specified tolerance   |         | Designed          | Date       |                     |           |  |
| X.XX±0.1   | X±0.3   | J-1118            | 2109.11.26 | SMB-JHD5-1          |           |  |
| X.X±0.2  | Ang.±1° | Checked           | Date       | Drawing NO.         |           |  |
| Notice:<br>This document is the property of Amphenol CNT, reproduction or disclosure is forbidden unless authorized by Amphenol CNT. |         | J-0006            | 2119.11.27 | SMB.1115032/R/1     |           |  |
|  |         |                   |            | Scale               | Sheet 1/1 |  |
|  |         |                   |            | Rev. V1.0           |           |  |