

NOTES:

1. MATERIALS AND FINISHES:
 BODY, COUPLING NUT, SLEEVE,
 BRAID CLAMP, GLAND & CLAMP NUT - BRASS, NICKEL PLATING
 CONTACT - BRASS, SILVER PLATING
 INSULATORS - CROSS LINKED POLYSTYRENE
 GASKETS - SILICONE RUBBER, RED
 RETAINING RING - PHOSPHOR BRONZE
2. MECHANICAL:
 A. DURABILITY: 500 CYCLES MIN.
 B. TEMPERATURE RANGE: -65° C TO +165° C
3. PACKAGING:
 A. QUANTITY: SINGLE PACK
 B. MARKING: BAG TO BE MARKED
 "AMPHENOL RF, 82-320-1004 , AND DATE CODE"

4. CABLE ASSEMBLY INSTRUCTIONS:
 A. TRIM CABLE AS SHOWN.
 B. CLAMP NUT, GLAND, GASKET, BRAID CLAMP, SLEEVE & INSULATOR ARE ASSEMBLED ONTO THE CABLE PRIOR TO SOLDERING OF CONTACT.
 C. SOFT SOLDER CONTACT TO CENTER CONDUCTOR OF CABLE AS SHOWN. USE HIGH TEMP. SOFT SOLDER.
 D. INSERT THE PRE-ASSEMBLED CABLE TERMINATION ASSEMBLY INTO PLUG BODY, SECURE BY TIGHTENING CLAMP NUT.

5> SHOWS CABLE ENTRY DIMENSIONS.

THIRD ANGLE PROJ.

REVISIONS				
REV	DESCRIPTION	DATE	ECO	APPR
A	WIRE HOLE Ø WAS 0.028; I-WAS 0.014±0.002		29815	KD
B	RE-RELEASE	12-Dec-05	48727	--
D	REDRAWN IN PRO-E AND COD SHEET ADDED	--	49872	CL

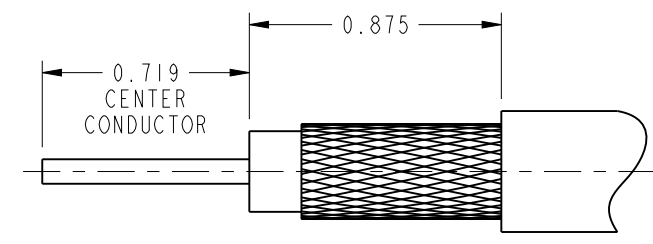

RECOMMENDED CABLE STRIPPING DIMENSIONS

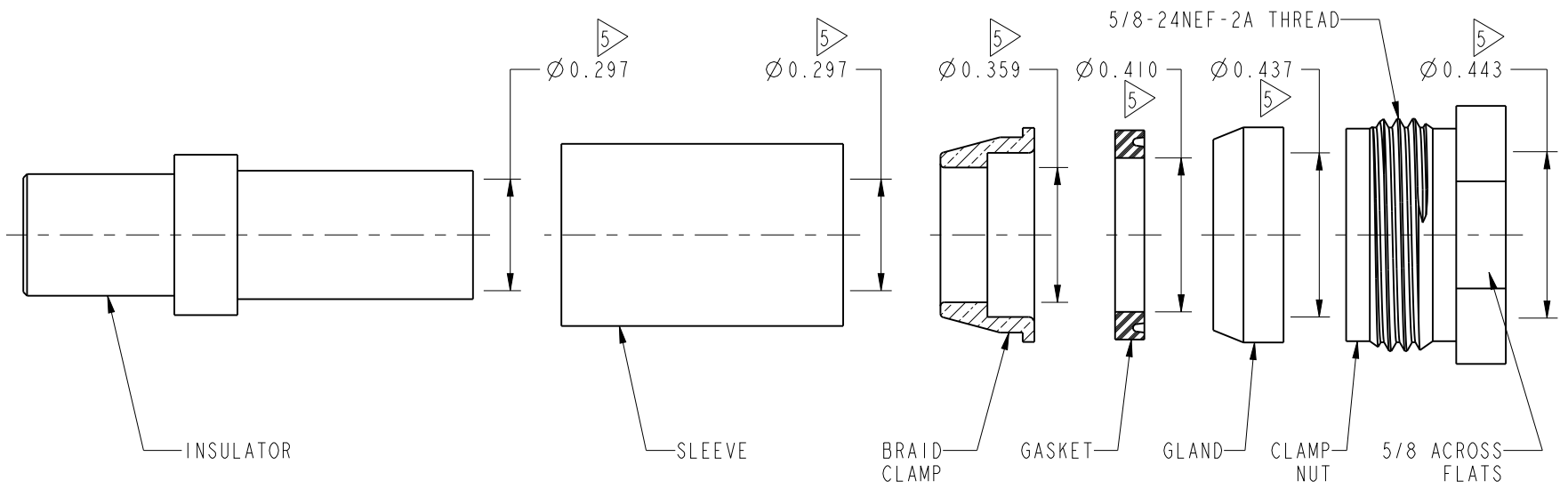
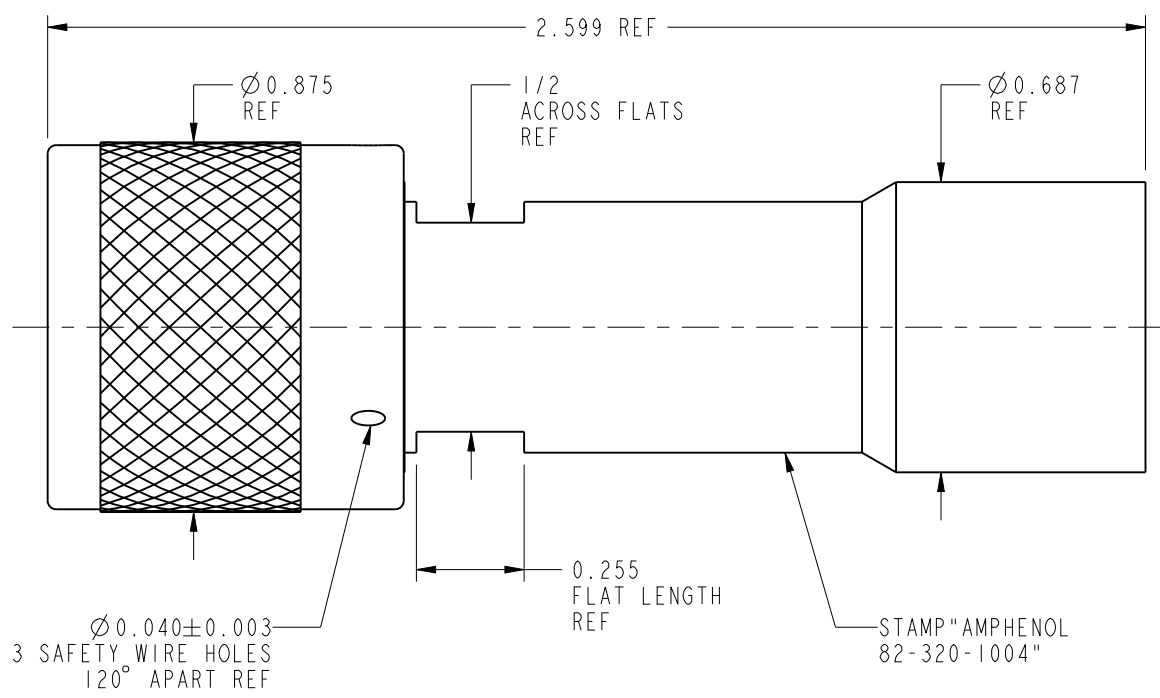
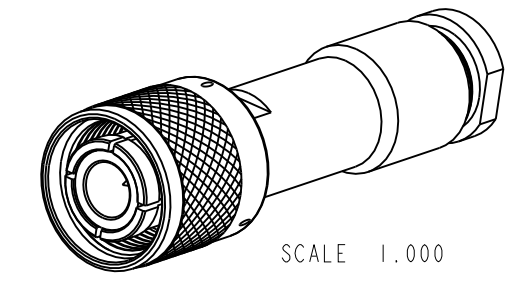

PRELIMINARY ISSUE

CUSTOMER OUTLINE DRAWING
 ALL OTHER SHEETS ARE FOR INTERNAL USE ONLY

UNLESS OTHERWISE SPECIFIED, DIMENSIONS ARE IN INCHES AND TOLERANCES ARE: 2 PLACE DECIMAL ±.015 (0,381 mm) 3 PLACE DECIMAL ±.005 (0,127 mm) ANGLES ± 1°	MATERIAL	DRAWN	DATE	TITLE HN PLUG SERIES FOR RG 8/U & RG-9/U CABLE		Amphenol RF www.amphenolrf.com	
	SEE NOTES	CLEMENT	12-Feb-14				
NOTICE - These drawings, specifications, or other data (1) are, and remain the property of Amphenol corp. (2) must be returned upon request; and (3) are confidential and not to be disclosed to any person other than those to whom they are given by Amphenol Corp. the furnishing of these drawings, specifications, or other data by Amphenol Corp., or to any other person to anyone for any purpose is not to be regarded by implication or otherwise in any manner licensing, granting rights to permitting such holder or any other person to manufacture, use or sell any product, process or design, patented or otherwise, that may in any way be related to or disclosed by said drawings, specifications, or other data.	REFERENCE	ENGINEER	DATE	SCALE: 2.2:1.0 SHEET 2 OF 2		DRAWING NO.82-320-1004 ITEM NO.82-320-1004	
	REFERENCE: 311444-51	K.CAPOZZI	12-Feb-14				
	CONFIGURATION LEVEL: In Work	APPROVED	CAD FILE	DATE	DWG SIZE	REV	PART NO.82-320-1004
FINISH		B	D				