

| REV. | DATE     | DESCRIPTION               |
|------|----------|---------------------------|
| A    | 01/08/99 | MODIFY PART / ADD NOTE 1. |
| B    | 04/11/06 | UPDATE DRAWING FORMAT     |

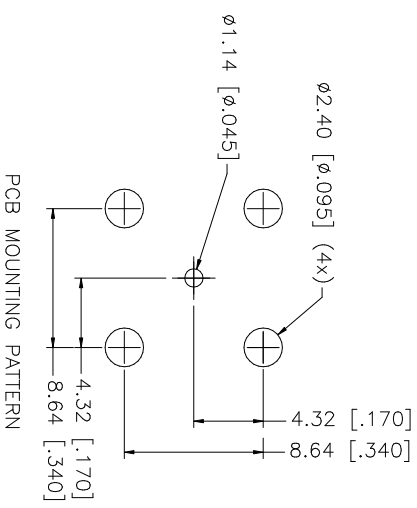
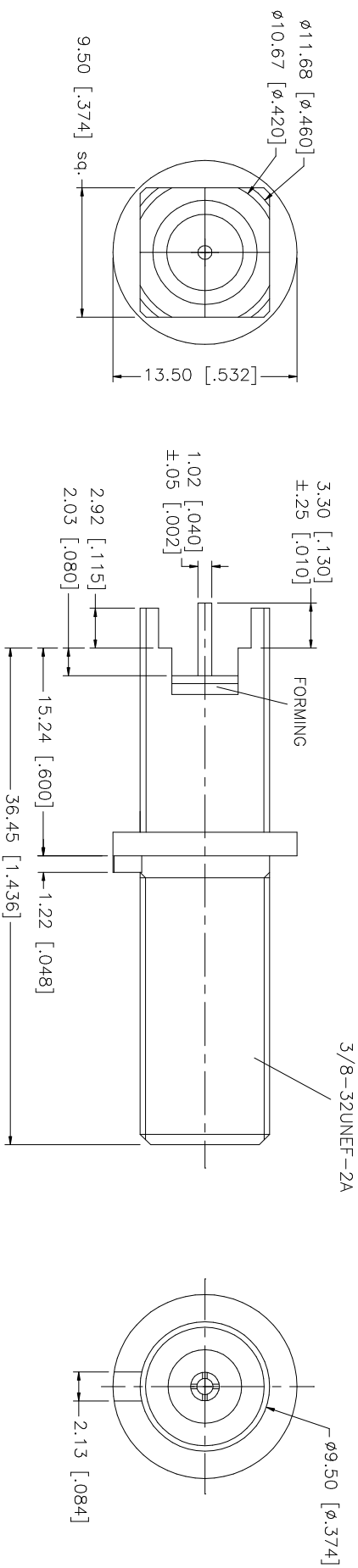

NOTE:  
 1. REF: TELLABS P.N. 51.0873  
 2. TIN-LEAD (90/100) PL. 100 MIN. THICK  
 OVER NICKEL PL. 50 MIN.

| NO. | DESCRIPTION | MATERIAL     | FINISH   | QTY | DO NOT SCALE DRAWING | APPROVALS | DATE | PART DESCRIPTION | PART NO. | DWG. NO. | REV. | SIZE | SCALE |
|-----|-------------|--------------|----------|-----|----------------------|-----------|------|------------------|----------|----------|------|------|-------|
| 8   |             |              |          |     |                      |           |      |                  |          |          |      |      |       |
| 7   |             |              |          |     |                      |           |      |                  |          |          |      |      |       |
| 6   |             |              |          |     |                      |           |      |                  |          |          |      |      |       |
| 5   |             |              |          |     |                      |           |      |                  |          |          |      |      |       |
| 4   |             |              |          |     |                      |           |      |                  |          |          |      |      |       |
| 3   | CONTACT PIN | PHOS. BRONZE | TIN LEAD | 1   |                      |           |      |                  |          |          |      |      |       |
| 2   | INSULATOR   | TEFLON       | NATURAL  | 1   |                      |           |      |                  |          |          |      |      |       |
| 1   | BODY        | BRASS        | TIN LEAD | 1   |                      |           |      |                  |          |          |      |      |       |
|     | DESCRIPTION | MATERIAL     | FINISH   | QTY |                      |           |      |                  |          |          |      |      |       |

UNLESS OTHERWISE SPECIFIED DIMENSIONS ARE IN MILLIMETERS. DIMENSIONS IN [ ] ARE IN INCHES AND FOR CUSTOMER REFERENCE ONLY.  
 TOLERANCES FOR MILLIMETERS ARE:  
 0.5 - 8mm ± 0.20mm  
 8 - 30mm ± 0.40mm  
 30 - 120mm ± 0.50mm  
 UNLESS OTHERWISE SPECIFIED TOLERANCES FOR INCHES ARE:  
 .020 - .315 = ± 0.007"  
 .315 - 1.180 = ± 0.015"  
 1.180 - 4.724 = ± 0.020"

CAO FILE C:/222/222142.DWG

DWG. NO. 222142.DWG

REV. B

SIZE A

SCALE NA

APPROVALS G.R.S. DATE 04/11/06

CHECKED

ISSUED

SHEET 1 OF 1

PART DESCRIPTION F P.C.B. RECEPTACLE

PART NO. 222142

**Amphenol Connex**