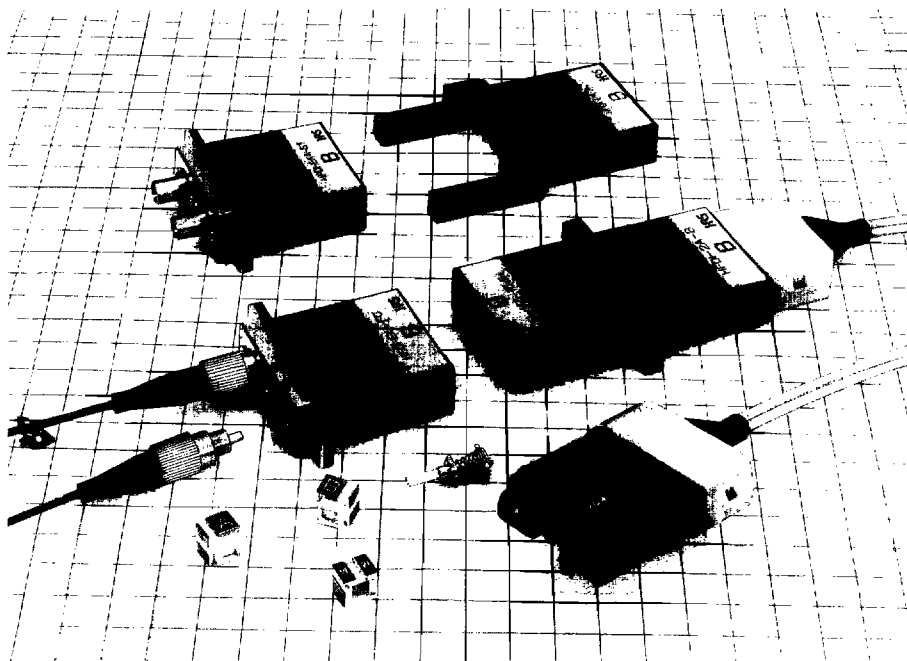

HFDI**Series****OF OPTICAL FIBER CONNECTOR****HFDI SERIES OPTICAL FIBRE CONNECTOR****SCOPE:**

The HFDI series optical fibre connector is FDDI spec. connector. It is available in multi mode type dual optic connectors applicable to LAN, etc.

Technical features of the HFDI included "push-pull" locking, a Zirconia ferrule, plastic housing and positive clamping of the optic cable, which offers excellent operation, high performance while achieving an economical cost.

Assemblies from Hirose are available with either flat polishing or with convex polishing type for low reflection, and ultra low insertion loss.

**FEATURES:**

- (1) Hirose original "Slide Cover Locking" mechanism offers easy operation of mating and unmating at its any position.
- (2) As lock lever is not exposed, there is no chance to be unlocked just by accident.
- (3) 4 kinds each of plug and receptacle with different key position are available.
- (4) Ferrule floating construction and spring butting-joint mechanism offer high performance and reliability.
- (5) Allows the guide key to be replaced on the site, thus facilitating LAN construction (HFDI-2P-EX).

APPLICATIONS:

LAN, Computer Transmitting System, etc.

OF OPTICAL FIBER CONNECTOR

SPECIFICATIONS:

- (1) Insertion Loss
(Conditions required)
SGI-50/125 PC Polishing: 0.3dB or less. (Light Source 1.3 μ m LED)
Flat Polishing: 0.7dB or less. (Light Source 1.3 μ m LED)
- (2) Reflection Loss
(Conditions required)
SGI-50/125 PC Polishing: 22dB or more (Light Source 1.3 μ m LD)
- (3) Applicable Fibre Cord
SGI-62.5/125, SGI-50/125 optical fibre cord
- (4) Life
500 times, Deviation of insertion loss : Max. 0.2dB
- (5) Temperature Cycle
-25°C ~70°C, 10 cycles
Deviation of insertion loss: Max. 0.2dB
- (6) Vibration
10~55Hz, Amplitude: 1.5 mm, Deviation of insertion loss: Max. 0.2dB
- (7) Shock
981m/s², Deviation of insertion loss: Max. 0.2dB

MATERIAL:

Item	Material
Plug Housing	Polybutylene-terephthalate
Coil Spring	Stainless Steel
Ferrule	Zirconia Ceramics
Adaptor	Polybutylene-terephthalate
Split Sleeve	Copper Alloy
Receptacle Housing	Polyphenylene-sulfite

VARIETY:

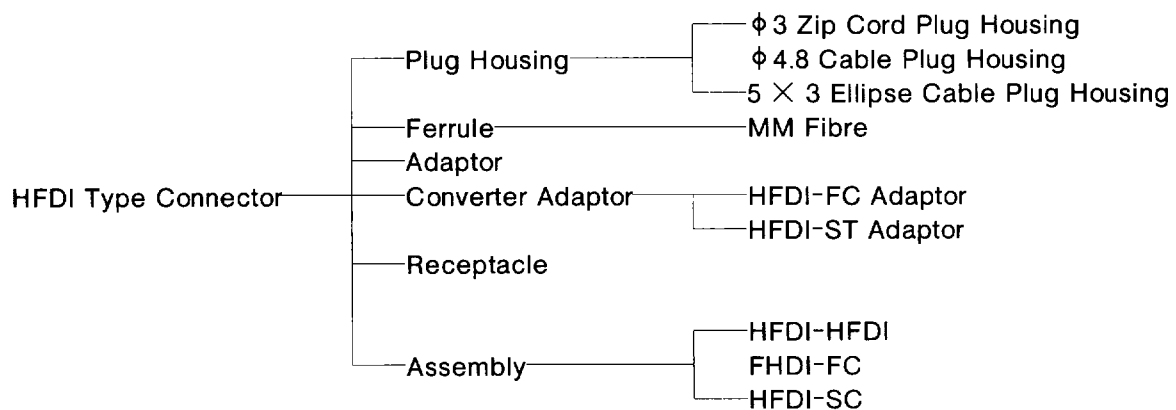

OF OPTICAL FIBER CONNECTOR

1. 2. 3. 4. 5. 6. 7. 8. 9. 10. 11. 12. 13. 14. 15. 16. 17. 18. 19. 20. 21. 22. 23. 24. 25. 26. 27. 28. 29. 30. 31. 32. 33. 34. 35. 36. 37. 38. 39. 40. 41. 42. 43. 44. 45. 46. 47. 48. 49. 50. 51. 52. 53. 54. 55. 56. 57. 58. 59. 60. 61. 62. 63. 64. 65. 66. 67. 68. 69. 70. 71. 72. 73. 74. 75. 76. 77. 78. 79. 80. 81. 82. 83. 84. 85. 86. 87. 88. 89. 90. 91. 92. 93. 94. 95. 96. 97. 98. 99. 100.

● HFDI TYPE FUNCTION CHART

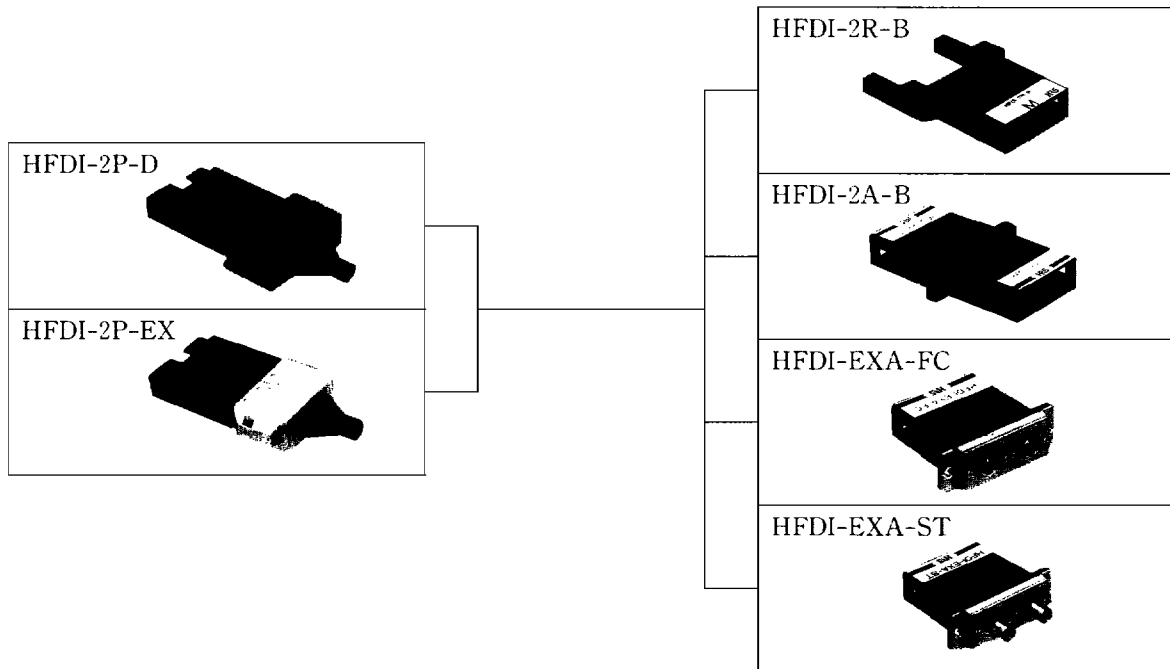

OF OPTICAL FIBER CONNECTOR

● HOW TO USE FDDI (HFDI)

The HFDI connectors are used for backbone LANs, front-end LANs, and back-end LANs.

(1) Backbone (trunk line LAN)

Used to interconnect branch LANs. A system for communication between stations is called a "backbone LAN."

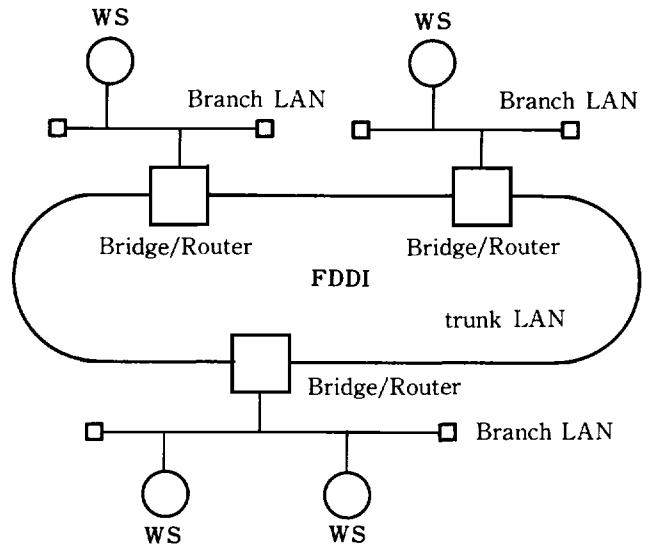
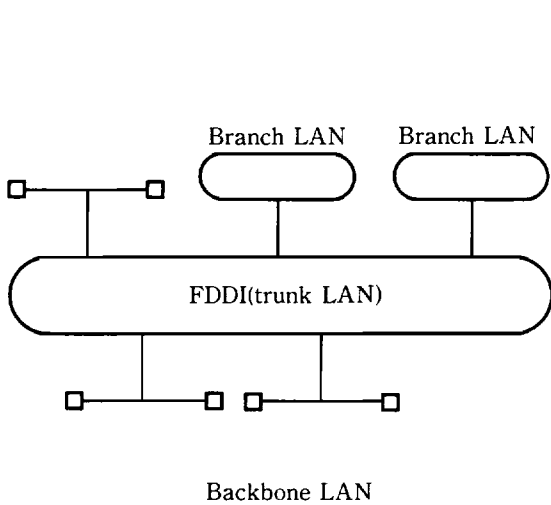

- The bridge and router control the information(packet) route.
- WS : Workstation

System of backbone LAN

(2) Front-end, back-end

A system for direct connection of equipment such as a computer to the FDDI link is called a "front-end LAN" and "back-end LAN."

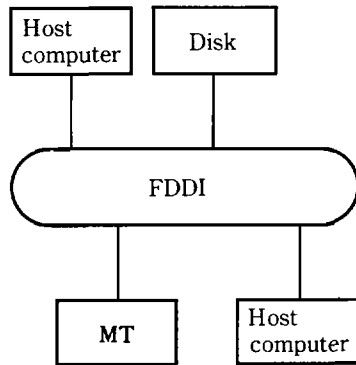

Back-end LAN
(connecting host-host,
host-disk by LAN)

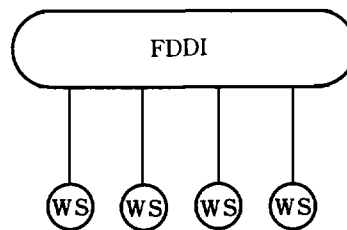

Group of high-speed workstations

Front-end LAN
(connecting high-speed
WS by LAN)

OF OPTICAL FIBER CONNECTOR

● GUIDE KEY ALIGNMENT

HFDI connector have 4 kinds of Guide Key Alignment as below.

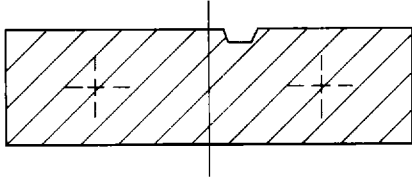
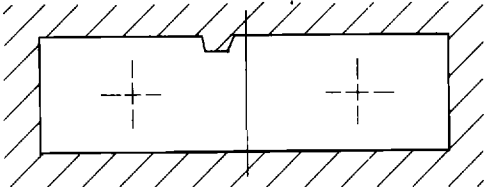
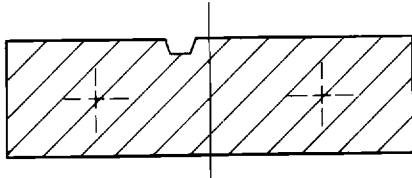
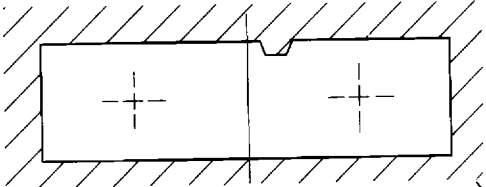
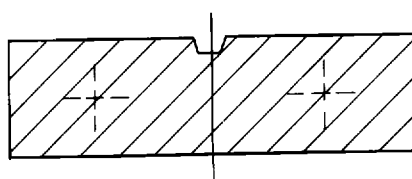
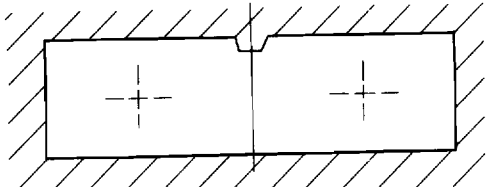
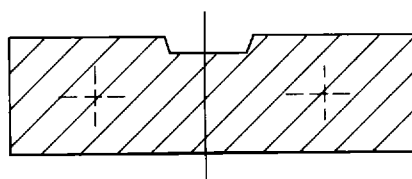
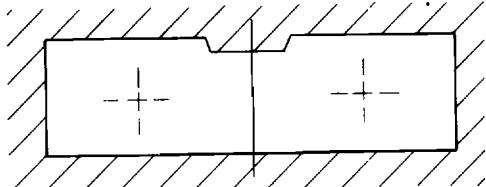
| Model | Guide key arrangement (Front View) | |
|-------|---|--|
| | Plug | Adapter, receptacle |
| A |  |  |
| B |  |  |
| M |  |  |
| S |  |  |

OF OPTICAL FIBER CONNECTOR

● CONNECTION PATTERN

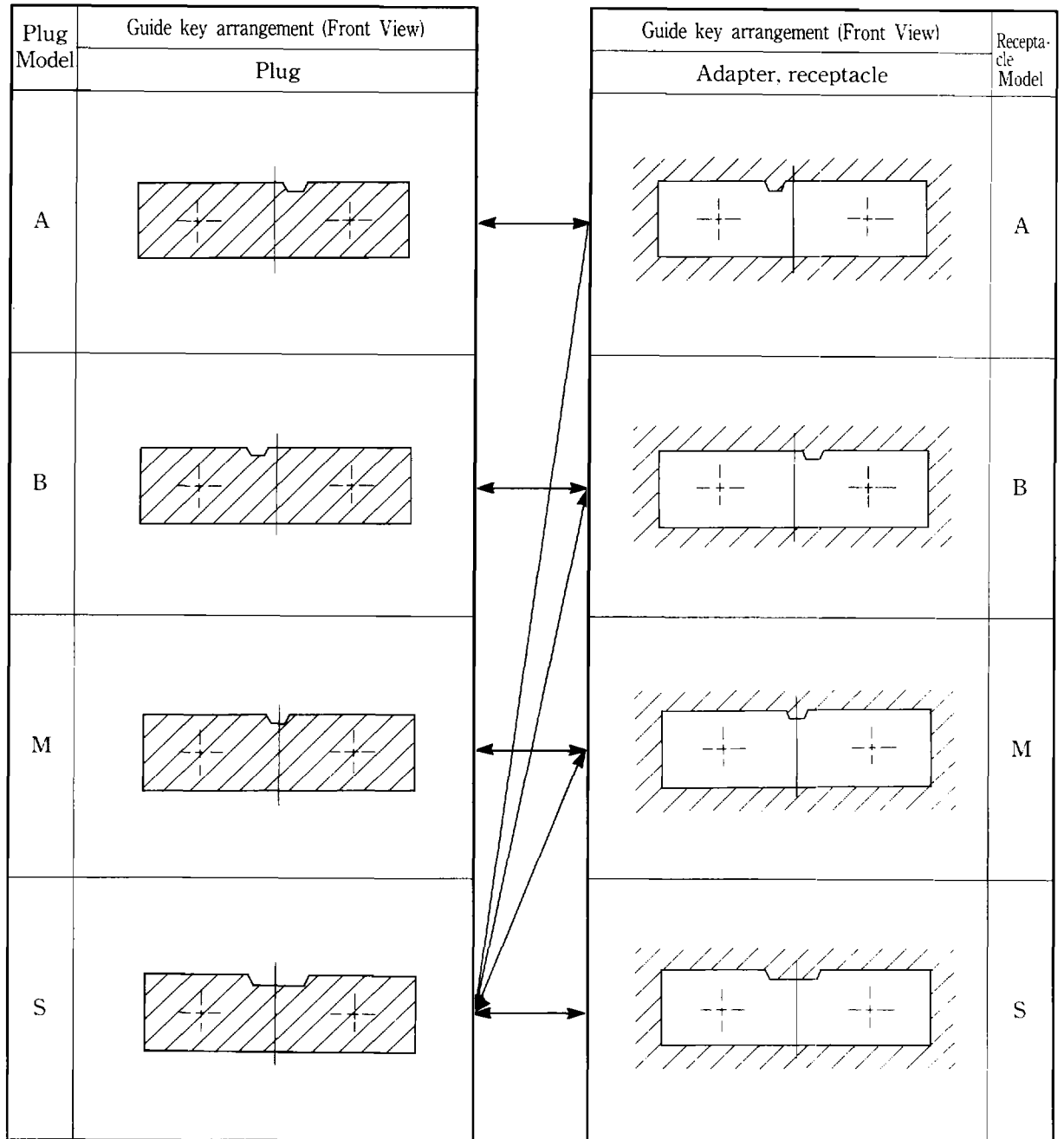

* The model S plug housing fits every type of adapter and receptacle, irrespective of the guide key.

OF OPTICAL FIBER CONNECTOR

● PLUG HOUSING

● GENERAL TYPE

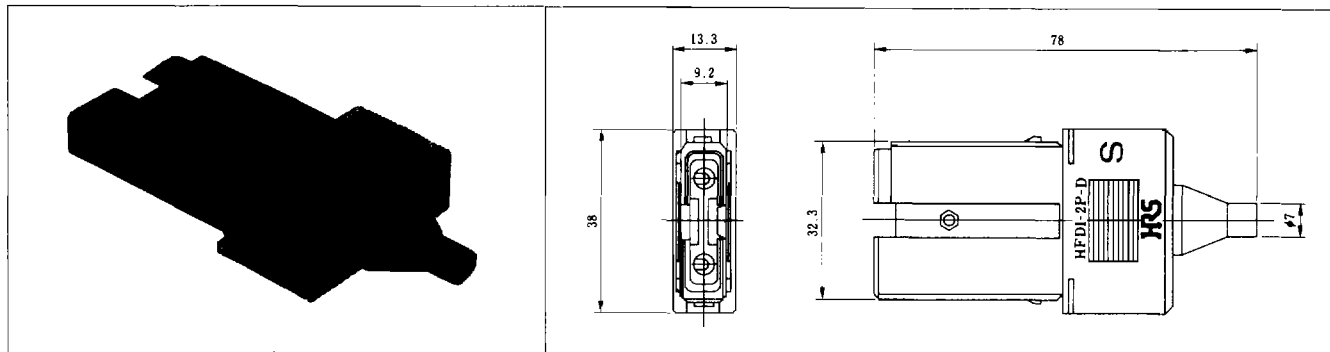

| HRS No. | Part No. | Applicable Cord | Guide Key Type |
|-----------------|------------------|---------------------|----------------|
| CL705-0049-9 | HFDI-2P-D(A) | φ 3 Zip Cord | A |
| CL705-0050-8 | HFDI-2P-D(B) | | B |
| CL705-0051-0 | HFDI-2P-D(M) | | M |
| CL705-0052-3 | HFDI-2P-D(S) | | S |
| CL705-0049-9-01 | HFDI-2P-D(A)(01) | φ 4.8 Cable | A |
| CL705-0050-8-01 | HFDI-2P-D(B)(01) | | B |
| CL705-0051-0-01 | HFDI-2P-D(M)(01) | | M |
| CL705-0052-3-01 | HFDI-2P-D(S)(01) | | S |
| CL705-0049-9-04 | HFDI-2P-D(A)(04) | 5 × 3 Ellipse Cable | A |
| CL705-0050-8-04 | HFDI-2P-D(B)(04) | | B |
| CL705-0051-0-04 | HFDI-2P-D(M)(04) | | M |
| CL705-0052-3-04 | HFDI-2P-D(S)(04) | | S |

Note: Above plug housing should be used along with 2 ferrules.

● KEY CHANGEABLE TYPE

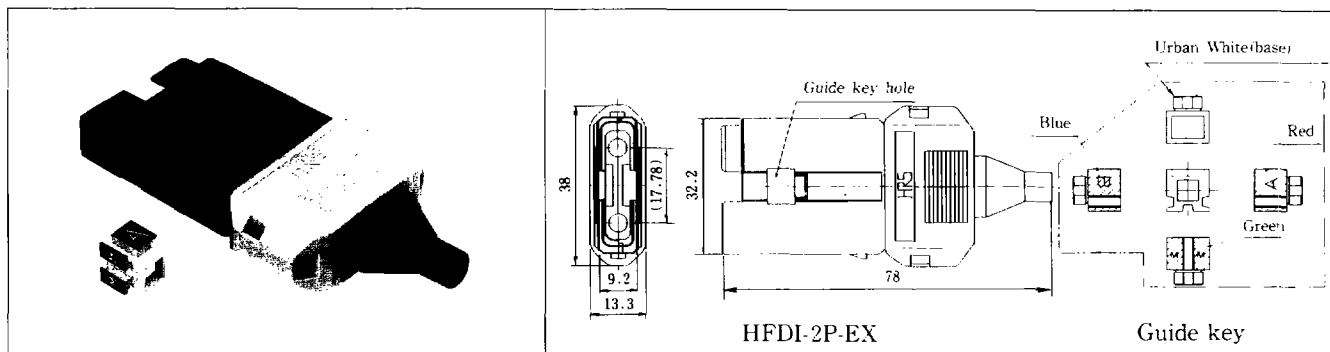

| HRS No. | Part No. | Applicable code |
|-----------------|----------------|---------------------|
| CL705-0057-7 | HFDI-2P-EX | φ 3 zip code |
| CL705-0057-7-01 | HFDI-2P-EX(01) | φ 4.8 cable |
| CL705-0057-7-02 | HFDI-2P-EX(02) | 5 × 3 ellipse cable |

Note: When using the housing with the guide key, remove the key from the housing.

OF OPTICAL FIBER CONNECTOR

● FERRULE

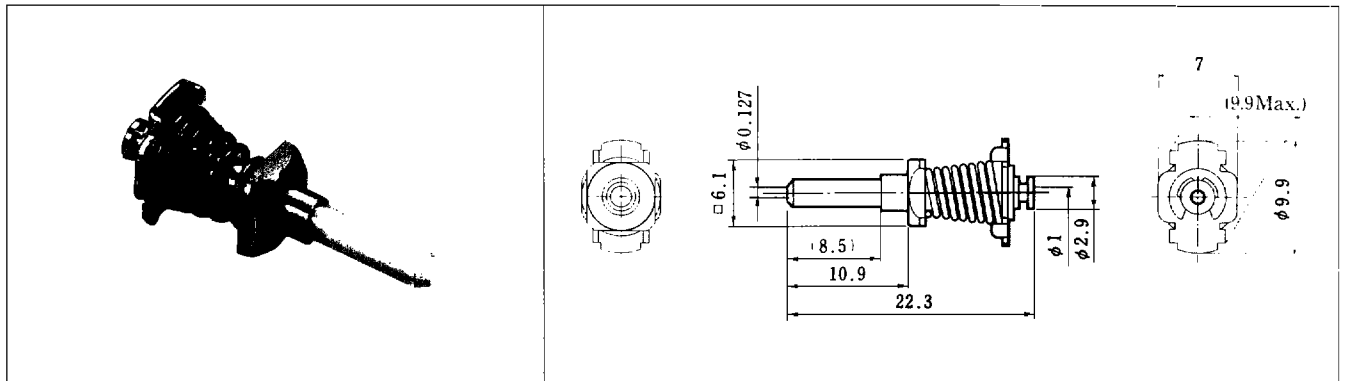

| HRS No. | Part No. | Applicable Optical Fibre |
|-----------------|---------------|--------------------------|
| CL705-0043-2-01 | HFDI-F36-B127 | SGI-50/125, SGI-62.5/125 |

● ADAPTOR

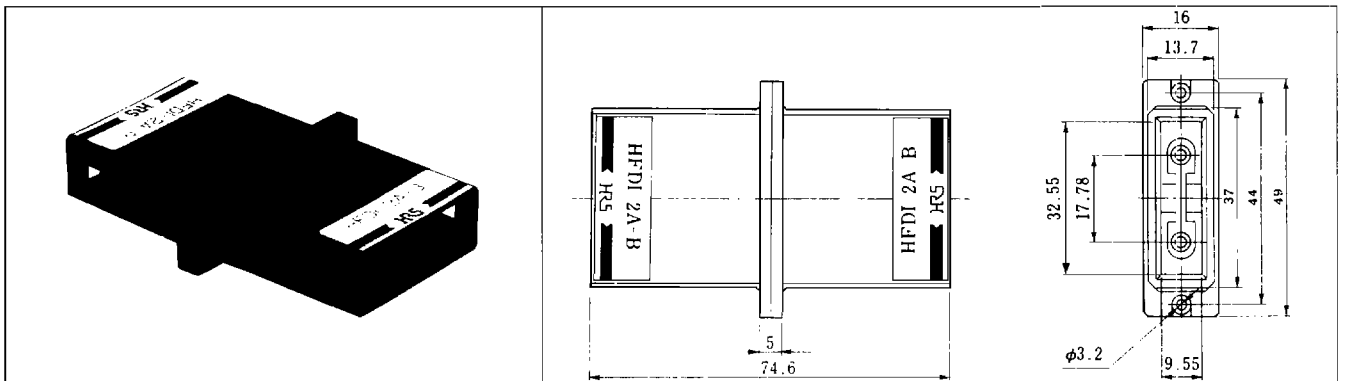

| HRS No. | Part No. | Guide Key Type |
|--------------|--------------|----------------|
| CL705-0025-0 | HFDI-2A-B(A) | A |
| CL705-0026-3 | HFDI-2A-B(B) | B |
| CL705-0027-6 | HFDI-2A-B(M) | M |
| CL705-0028-9 | HFDI-2A-B(S) | S |
| CL705-0024-8 | HFDI-2A-B | — |

OF OPTICAL FIBER CONNECTOR

● RECEPTACLE

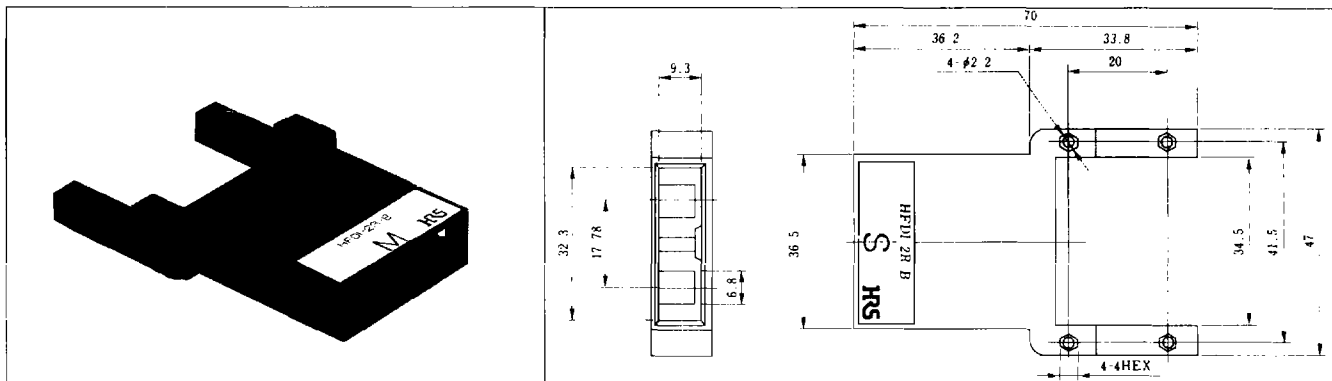

| HRS No. | Part No. | Guide Key Type |
|--------------|--------------|----------------|
| CL705-0002-5 | HFDI-2R-B(A) | A |
| CL705-0003-8 | HFDI-2R-B(B) | B |
| CL705-0004-0 | HFDI-2R-B(M) | M |
| CL705-0005-3 | HFDI-2R-B(S) | S |

● CONVERTER ADAPTOR

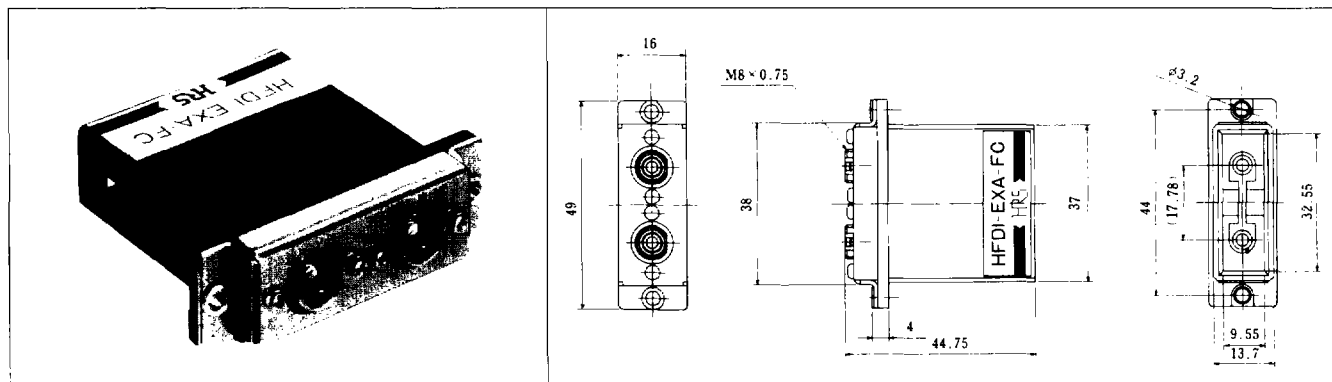

| HRS No. | Part No. | Guide Key Type | Remark |
|--------------|----------------|----------------|---------------------------|
| CL705-0016-0 | HFDI-EXA-FC | — | FDDI-FC Adaptor Converter |
| CL705-0017-2 | HFDI-EXA-FC(A) | A | |
| CL705-0018-5 | HFDI-EXA-FC(B) | B | |
| CL705-0019-8 | HFDI-EXA-FC(M) | M | |
| CL705-0020-7 | HFDI-EXA-FC(S) | S | |

OF OPTICAL FIBER CONNECTOR

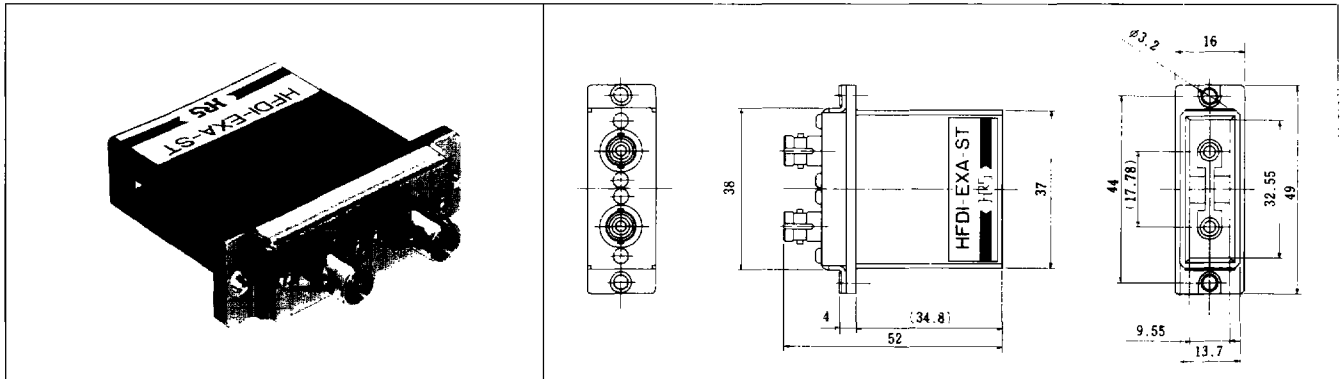

| HRS No. | Part No. | Guide Key Type | Remark |
|--------------|----------------|----------------|---------------------------|
| CL705-0029-1 | HFDI-EXA-ST | — | FDDI-ST Adaptor Converter |
| CL705-0030-0 | HFDI-EXA-ST(A) | A | |
| CL705-0031-3 | HFDI-EXA-ST(B) | B | |
| CL705-0032-6 | HFDI-EXA-ST(M) | M | |
| CL705-0033-9 | HFDI-EXA-ST(S) | S | |

OF OPTICAL FIBER CONNECTOR

● CONNECTOR WITH CABLE

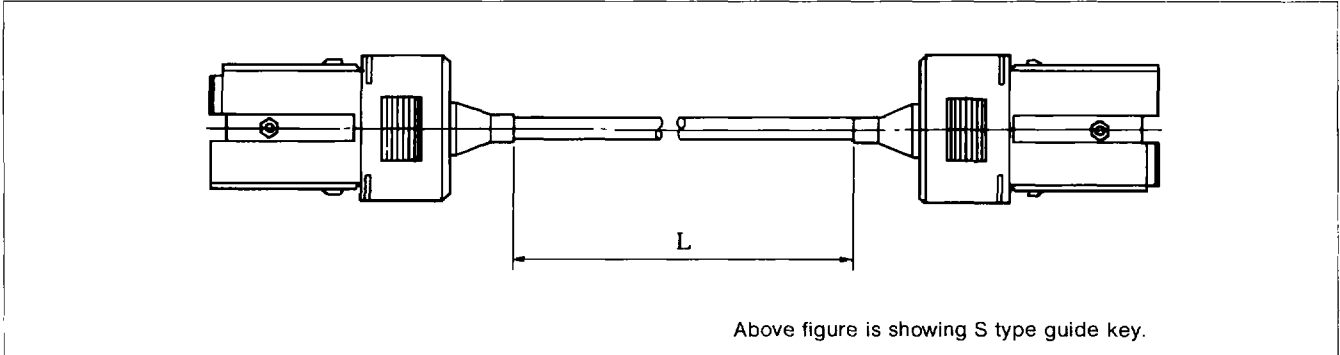

[HFDI-2P-D]

| HRS No. | Mounting Side of Connector | Applicable Optical Fibre | Polishing Type |
|-------------------|----------------------------|------------------------------|----------------|
| HFDI-FP* -F3BW-L | One end | SGI-50/125
φ 3 Jip Code | Flat |
| HFDI-FP* *-F3BW-L | Both Ends | | |
| HFDI-FP* -F3CW-L | One end | SGI-62.5/125
φ 3 Jip Code | |
| HFDI-FP* *-F3CW-L | Both Ends | | |
| HFDI-SP* -F3BW-L | One end | SGI-50/125
φ 3 Jip Code | Convex |
| HFDI-SP* *-F3BW-L | Both Ends | | |
| HFDI-SP* -F3CW-L | One end | SGI-62.5/125
φ 3 Jip Code | |
| HFDI-SP* *-F3CW-L | Both Ends | | |

Note: For Guide Key type please indicate type in the * * of Part No. Please indicate One alphabet letter in the Part No. for one end assembly and Two alphabet letters in the Part No. for both ends assembly as below:

One End Assembly:

A: A Type B: B Type M: M Type S: S Type

Both Ends Assembly:

AB: A Type for one end, B Type for other end, MS: M Type for one end, S Type for other end, SS S Type for both ends.

[HFDI-2P-EX]

| HRS No. | Mounting Side of Connector | Applicable Optical Fibre | Polishing Type |
|-----------------|----------------------------|------------------------------|----------------|
| HFDI-FP1-F3BW-L | One end | SGI-50/125
φ 3 Jip Code | Flat |
| HFDI-FP2-F3BW-L | Both Ends | | |
| HFDI-FP1-F3CW-L | One end | SGI-62.5/125
φ 3 Jip Code | |
| HFDI-FP2-F3CW-L | Both Ends | | |
| HFDI-SP1-F3BW-L | One end | SGI-50/125
φ 3 Jip Code | Convex |
| HFDI-SP2-F3BW-L | Both Ends | | |
| HFDI-SP1-F3CW-L | One end | SGI-62.5/125
φ 3 Jip Code | |
| HFDI-SP2-F3CW-L | Both Ends | | |

* Parts of Guide keys are attached.

* "L" in the Part No. is cord length in meters. Indicate length in the Part No.

OF OPTICAL FIBER CONNECTOR

MODEL NAME: HFDI-2P-D

● ASSEMBLY (CONVERTER CORD)

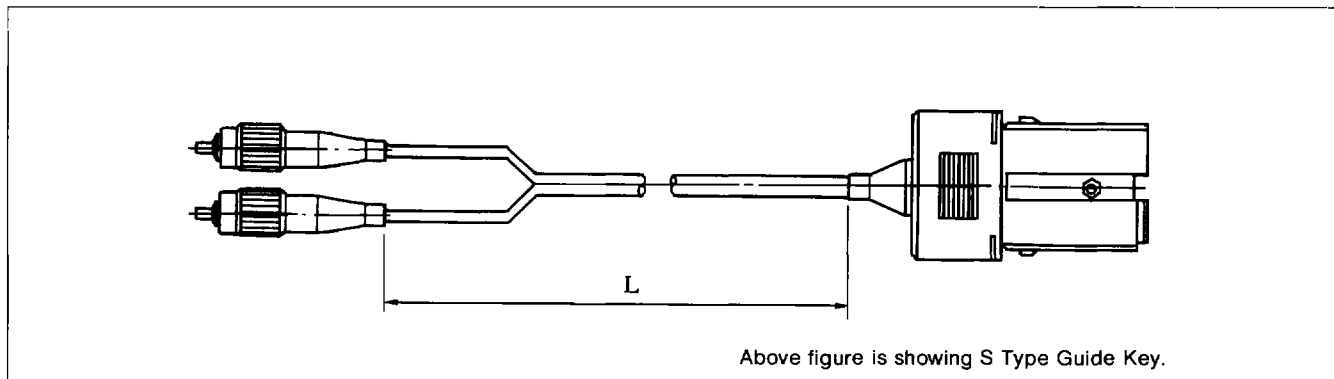

[HFDI-2P-D]

| HRS No. | Applicable Optical Fibre | Polishing Type | Remark |
|------------------|--------------------------|----------------|------------------------|
| CA011051 *-FBW-L | SGI-50/125 | Flat | FDDI-FC Converter Cord |
| CA011051 *-FCW-L | SGI-62.5/125 | | |
| CA011051 *-SBW-L | SGI-50/125 | Convex | |
| CA011051 *-SCW-L | SGI-62.5/125 | | |

Note: For Guide Key Type please indicate type in the * of Part No. by selecting the below one alphabet letter:

A: A Type B: B Type M: M Type S: S Type

[HFDI-2P-EX]

| HRS No. | Applicable Optical Fibre | Polishing Type | Remark |
|----------------|--------------------------|----------------|------------------------|
| CA011055-FBW-L | SGI-50/125 | Flat | FDDI-FC Converter Cord |
| CA011055-FCW-L | SGI-62.5/125 | | |
| CA011055-SBW-L | SGI-50/125 | Convex | |
| CA011055-SCW-L | SGI-62.5/125 | | |

* Parts of Guide keys are attached.

* "L" in the Part No. is cord length in meters. Indicate length in the Part No.

OF OPTICAL FIBER CONNECTOR

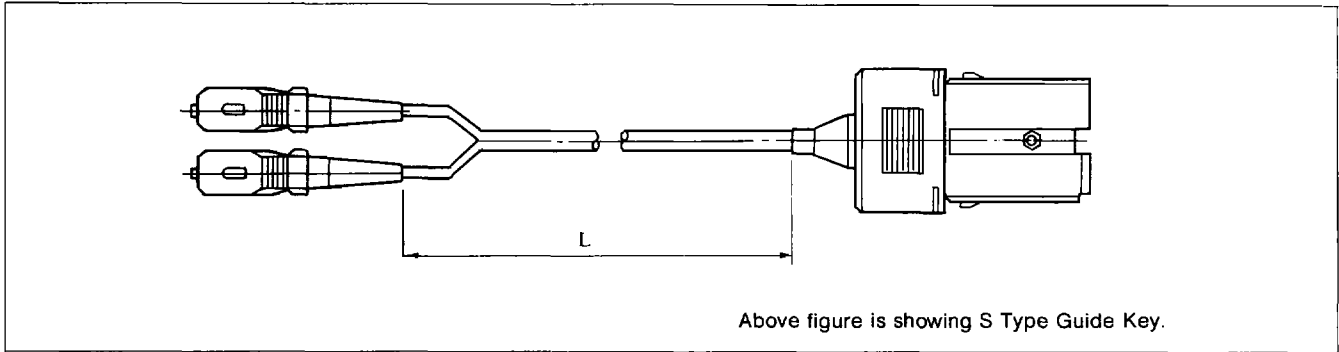

[HFDI-2P-D]

| HRS No. | Applicable Optical Fibre | Polishing Type | Remark |
|------------------|--------------------------|----------------|------------------------|
| CA041051 *-FBW-L | SGI-50/125 | Flat | FDDI-SC Converter Cord |
| CA041051 *-FCW-L | SGI-62.5/125 | | |
| CA041051 *-SBW-L | SGI-50/125 | Convex | |
| CA041051 *-SCW-L | SGI-62.5/125 | | |

Note: For Guide Key Type please indicate type in the * of Part No. by selecting the below one alphabet letter:

A: A Type B: B Type M: M Type S: S Type

[HFDI-2P-EX]

| HRS No. | Applicable Optical Fibre | Polishing Type | Remark |
|----------------|--------------------------|----------------|------------------------|
| CA041055-FBW-L | SGI-50/125 | Flat | FDDI-SC Converter Cord |
| CA041055-FCW-L | SGI-62.5/125 | | |
| CA041055-SBW-L | SGI-50/125 | Convex | |
| CA041055-SCW-L | SGI-62.5/125 | | |

※ Parts of Guide keys are attached.

※ "L" in the Part No. is cord length in meters. Indicate length in the Part No..

● HAND CRIMP TOOL

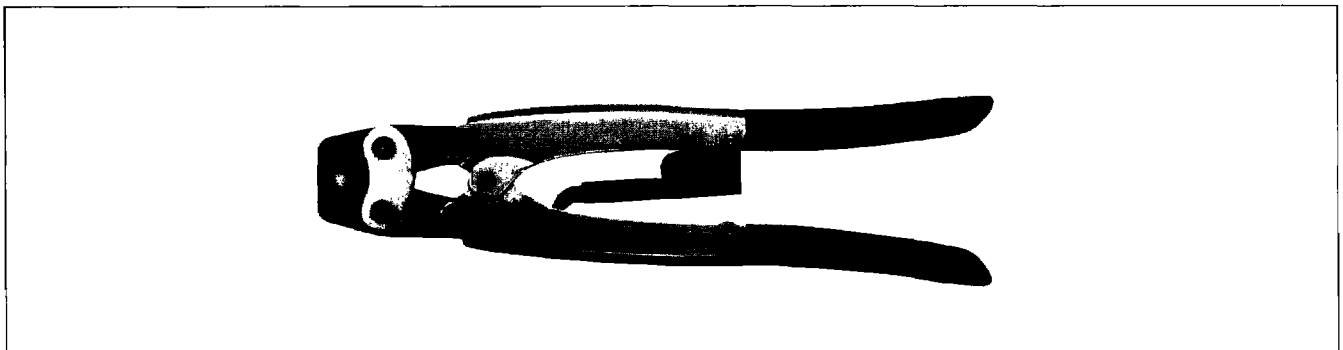

| HRS No. | Applicable Product |
|---------|-------------------------|
| FHDI-T1 | HFDI-2P-D
HFDI-2P-EX |