

Tous droits strictement réservés. Reproduction ou communication à des tiers interdite sous quelque forme que ce soit sans autorisation écrite du propriétaire. Propriété de c FCI. Droits de reproduction FCI.

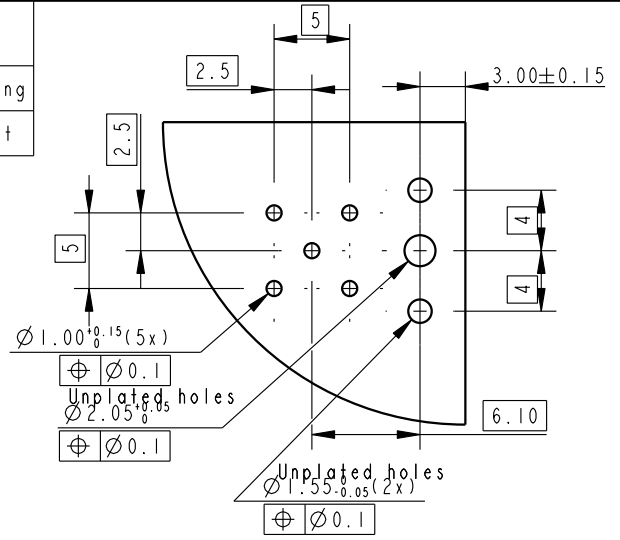

All rights strictly reserved. Reproduction or issue to third parties in any form whatever is not permitted without written authority from the proprietor. Property of FCI. Copyright FCI.

Product number	Performance class Acc. to DIN 41626-2	Note
72622-301	PLI	Customized marking
72622-311	PLI	Standard product

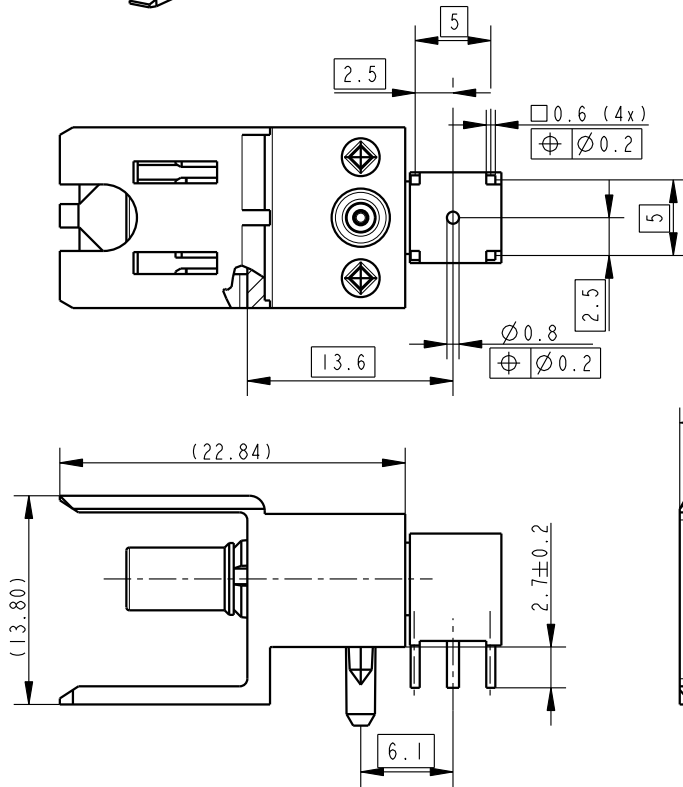
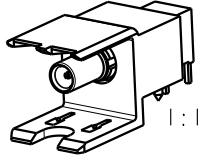

NOTE:  
 1 BODY MATL :Liquid Crystal Polymer 30% glass  
 flame retardant acc. to UL 94-V0  
 2 CONTACT MATL :BeCu  
 3 BODY MATL: CuZn39Pb2  
 4 INSULATOR MATL: PFTE  
 5 CLIP MATL: BeCu  
 6 PLATING SOLDERTAILS: Ni under Sn/Pb (min 2%Pb) and/or max 1 m Au  
 7 PRODUKT MARKING:Part number, manufact. date and factory code

lfr	ecn no	dr	date
B	B20112	ES	020630
-	-	-	-
-	-	-	-
-	-	-	-
-	-	-	-
-	-	-	-
-	-	-	-

CONVERSION ACCORDING GS-STANDARDS

Characteristic impedance	50Ω
Standing wave ratio (WSVR)	max 1:1,15 at 1.5GHz
Rated voltage	250Vrms
Insulation resistans	1000MΩ min.
Climatic category	PLI: 55/125/56
PCB thickness	1,4-2,4mm

www.fciconnect.com		ISO 1302 ✓		tolerance ISO 406 ISO 1101	projection 	mm 
Dr	Stroeykens	30/06/02	Product family		size	Scale
Eng	G.Nys	30/06/02	Spec ref		A4	2:1
Chr	W.Panis	30/06/02	Material	SEE NOTES	ECN	B20112
Appr	W.Panis	30/06/02				
title				dwg no		Rev.
				72622_C		B
catalog no				CUSTOMER COPY		sheet 1 of 1