

# E5213 Series Single-circuit disconnectable crimp terminal

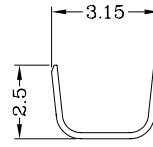

Features:

- \* Current rating: 5A AC/DC
- \* Suitable pin diameter: 2.36mm

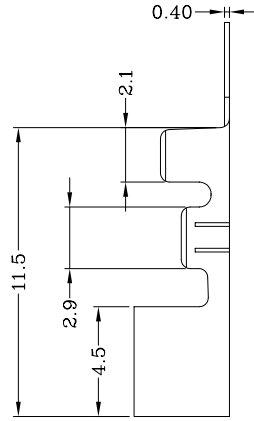
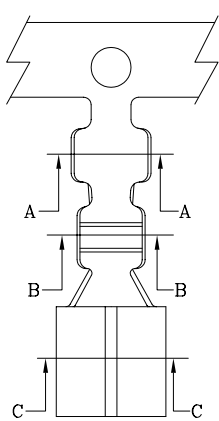

Section A-A

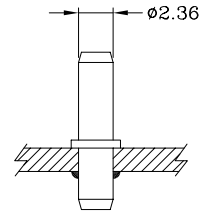

P.C.B LAUOUT

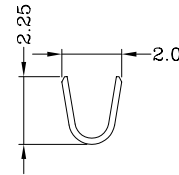

Section B-B

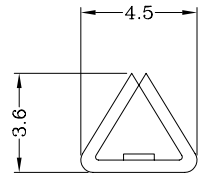

Section C-C

Specifications & Ordering Information:

Part No	Wire Range	Insulation O.D.	Material	Finish	Qty/reel
E5213TOB-00	AWG #22~#26	2.60mm (max)	Brass	Gold-flash	5,000 PCS
E5213TOB-2	AWG #22~#26	2.60mm (max)	Brass	Tin-plated	5,000 PCS

# E5214 Series Single-circuit disconnectable crimp terminal

Features:

- \* Current rating: 5A AC/DC
- \* Suitable pin diameter: 2.00mm

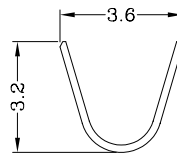
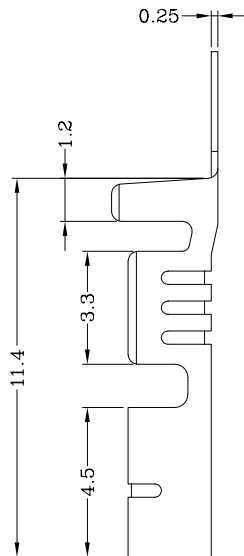
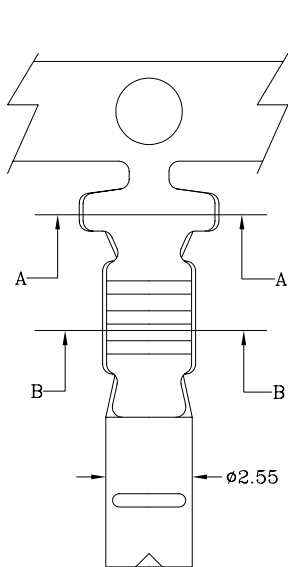

Section A-A

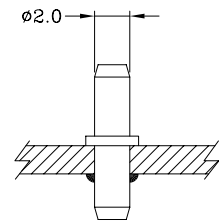

P.C.B LAUOUT

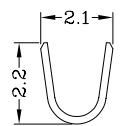

Section B-B

Specifications & Ordering Information:

Part No	Wire Range	Insulation O.D.	Material	Finish	Qty/reel
E5214TOB-2	AWG #20~#24	2.60mm (max)	Brass	Tin-plated	8,000 PCS