

## SERIES 58M - FULLY SEALED METAL PUSHBUTTON WITH WIRE LEADS

Built on the proven series 48 platform these rugged switches come in stainless steel or aluminum housings, electro-mechanical with either momentary or maintained action and lighted or unlighted versions. The variety of options in this compact package size make the 58M ideal for many applications: transportation, outdoor controls, security products, food processing and medical products.

### APPLICATIONS:

- Outdoor Controls
- Kiosks
- Security Equipment
- Medical Equipment
- Food Processing Equipment
- Military Equipment
- Industrial Machinery
- Transportation: Mass-Transit, Lift Trucks



### KEY FEATURES:

- Momentary or Maintained Action
- Stainless Steel or Aluminum Housing
- Non Lit or Ring Illumination
- Variety of LED colors
- Electro-Mechanical
- Panel Sealed to IP67
- ROHS Compliant
- Gold Plated Contacts

### ORDERING INFORMATION:

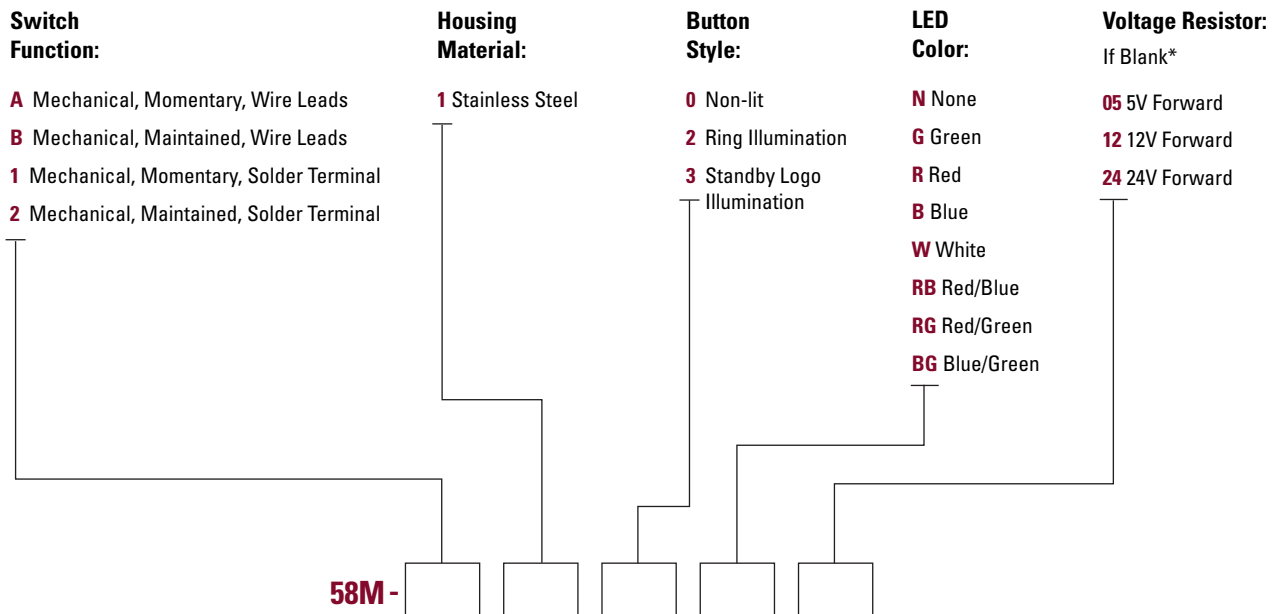

\* Current limiting resistor is required to limit LED forward current to 20 mA (not included).

PRODUCT DRAWINGS

NON-ILLUMINATION

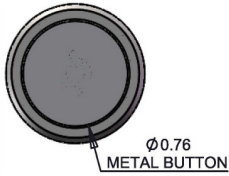

ILLUMINATION

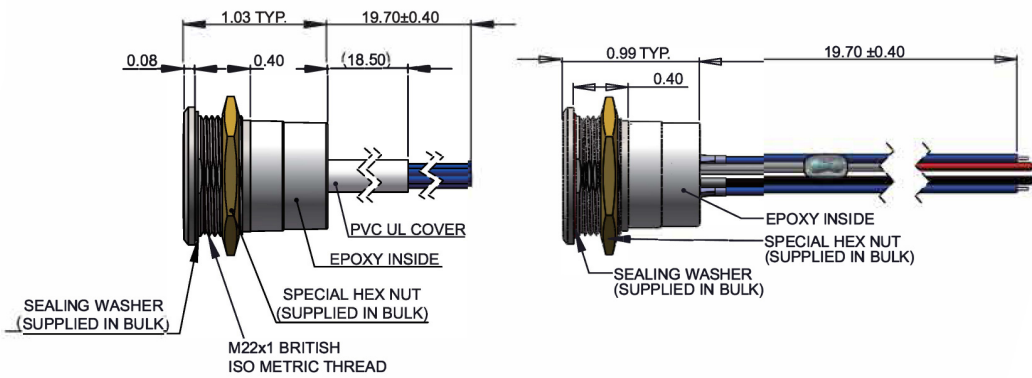
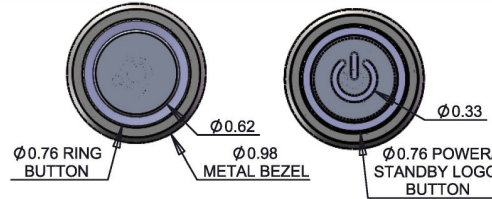

RECOMMENDED PANEL CUTOUT

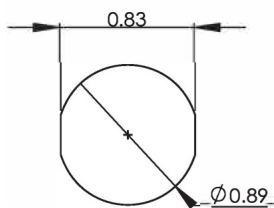

Wireleads Type	Wireleads Specification	SW Terminal		LED	
		/	0	+	-
Illumination	AWG26/UL1007	Blue	Blue	Red	Black
Non-Illumination		Blue	Blue	—	—

PANEL MOUNTING AND CONSTRUCTION INFORMATION

The series 58M mounts easily into panels of minimum 0.50" (1.3 mm) and maximum 0.150" (3.8 mm) thickness. Front panel sealing to IP67 is achieved by a sealing a-ring fitted to the body of the switch before it is inserted into the panel hole cut-out. It is held onto the panel by means of a metal hex nut tightened down to a torque of 10 inch pounds to achieve the correct sealing pressure.

MECHANICAL / ELECTRICAL CHARACTERISTICS:

- Circuit:** SPST-NO-DB (Form X)
- Button travel(nominal):** 0.09 inches/ 2.3 mm
- Operating force(nominal):** 3N / 306 grams
- Contact bounce (nominal):** 1 ms
- Panel thickness:** .020 - .177inches / 0.5 - 4.5mm
- Temperature index:** -40°F to + 185°F / -40°C to +85°C
- Torque (max):** 10 lb-in/ 11.5 kgf-cm
- LED operating temperature:** -13°F to + 185°F / -25°C to +85°C
- Current Rating (resistive):**
  - 58M (Momentary)**
    - 250mA @ 12VDC, 100K cycles
    - 150mA @ 28VDC, 150K cycles
    - 100mA @ 48VDC, 100K cycles
    - 10mA @ 12VDC, 1 million cycles
  - 58M (Maintained)**
    - 50,000 Cycles Nominal

ELECTRICAL SPECIFICATIONS

- Dielectric strength:** 1,000 VAC
- Insulation resistance:** 1GΩ
- Contact resistance:** 50mΩ max (initial)

