



Type: **END11**

Part No.: **For short wavelength**

ENQD11106A (Transmitter)

ENQD112A6A (Receiver)

For long wavelength

ENQD11110 (Transmitter)

ENQD112B2 (Receiver)

Features

- Data transmission rate : 3 Mbps
- Small in size due to IC circuit
- With type JIS F01 (FC) receptacle
- With auto threshold control circuit

Recommended Applications

- FA LAN
- OA LAN
- Measurement System

Specifications

■ Dimensions in mm (not to scale)

● END56 (One-way Transmitter)

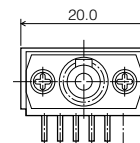
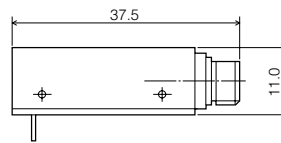

● END56 (One-way Receiver)

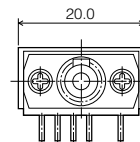
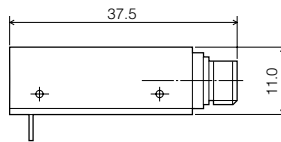

Items	Specifications
1. Transmission Distance	0 to 4 km, 0 to 10 km
2. Input / Output Interface	TTL
3. Optical Detector	Infrared LED
4. Optical Source	PIN • PD
5. Applicable Fiber	Silica glass GI 50 / 125

■ Ratings

Items	Ratings	Notes
1. Operating Voltage Range	5 ± 0.25 V	—
2. Operating Current	Transmitter 60 mA max.	V _{CC} = 5 V 1.5 MHz duty 50 % output open
	Receiver 50 mA max.	
3. Operating Temperature Range	0 to 60 °C	—

■ Characteristics

Items	Characteristics		Conditions
	Mid / Short distance	Long distance	
1. Transmission Speed	DC to 3 Mbps	DC to 3 Mbps	NRZ
2. Peak Emission Wavelength	860 nm typ.	1300 nm typ.	—
3. Output Optical Power	-18 dBm min.	-21 dBm min.	V _{CC} = 5.0 V V _{IH} = 5.0 V
4. Min. Detectable Level	-30 dBm max.	-31 dBm max.	V _{CC} = 5.0 V 1.5 MHz duty 50 % Pulse breadth variation ± 20 % with in (B.E.R = 10 ⁻⁹ typ.)
5. Max. Detectable Level	-15 dBm min.	-18 dBm min.	

Design, Specifications are subject to change without notice. Ask factory for technical specifications before purchase and/or use.
Whenever a doubt about safety arises from this product, please inform us immediately for technical consultation without fail.