

Ultra Rapid Semiconductor Protection Fuse

BS 88 Round Body Type Fuses – 690V

**British Standard
Voltage Rating to 690V
Current Ratings from 5A to 160A
gR Characteristics
Sizes 10x51, 17x49, 2x17x49**

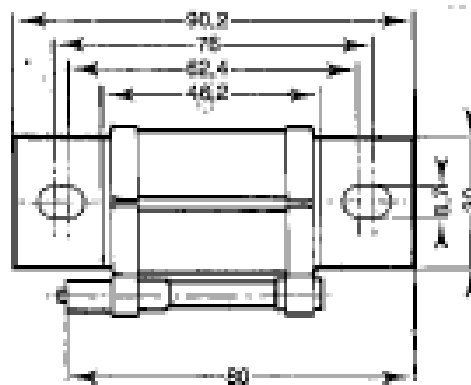

Key Features:

- ❖ Extremely high interrupting rating fuses for the protection of power semiconductors in accordance with IEC Standard 60269.1 and 4.
- ❖ 690V voltage rating complying with IEC 33
- ❖ Non Magnetic construction
- ❖ gR Characteristics (current ratings from 5 to 160A) according to VDE 636-23 and EC 60269.4
- ❖ Models are available with or without separate trip indicator
- ❖ Microswitch MC 6,3 GR 2-5N for fuses with separate trip indicator
- ❖ 17x49 gR fuses are UL recognised

Main Characteristics:

CW : 10x51 Without trip indicator

Size	Voltage U _N (V)	Ref:	Micro Switch	Current rating I _N (A)	Pre-arcing I ² t @ 1 ms I ² t _p (A ² s)	Total Clearing I ² t @ U _N (A ² s)		Power Losses @		Tested Interrupting rating
						I _p ≤ 50 I _n	I _p > 50 I _n	0.8 I _n	I _n	
10x51	690	5CW	N	5	1.3	10	15	1.05	2	200kA @ 690V
		6CW	N	6	1.3	13.5	20.5	1.3	2.5	
		10CW	N	10	3.3	25	35	2.2	4.1	
		12CW	N	12	5.5	40	58	2.3	4.3	
		15CW	N	15	9.7	70	100	2.4	4.4	
		20CW	N	20	19.4	120	200	3.1	5.8	

EEW : 2x17x49 Without trip indicator

Size	Voltage U _N (V)	Ref:	Micro Switch	Current rating I _N (A)	Pre-arcing I ² t @ 1 ms I ² t _p (A ² s)	Total Clearing I ² t @ U _N (A ² s)		Power Losses @		Tested Interrupting rating
						I _p ≤ 50 I _n	I _p > 50 I _n	0.8 I _n	I _n	
2x17x49	690	65EEW	N	65	210	1590	2270	9.5	17.4	200kA @ 690V
		75EEW	N	75	310	2300	3280	10.9	20	
		85EEW	N	85	430	3050	4350	11.9	21.9	
		90EEW	N	90	525	3600	5130	12.4	22.8	
		110EEW	N	110	850	5500	7840	13.8	26.5	
		140EEW	N	140	1730	11000	15700	15.5	28.5	
		150EEW	N	150	2090	13400	18500	15.6	28.7	
		160EEW	N	160	2500	15600	22800	16.9	31.5	

EEWI : 2x17x49 With separated trip indicator

Size	Voltage U _N (V)	Ref:	Micro Switch	Current rating I _N (A)	Pre-arcing I ² t @ 1 ms I ² t _p (A ² s)	Total Clearing I ² t @ U _N (A ² s)		Power Losses @		Tested Interrupting rating
						I _p ≤ 50 I _n	I _p > 50 I _n	0.8 I _n	I _n	
2x17x49	690	65EEWI	Y	65	210	1590	2270	9.5	17.4	200kA @ 690V
		75EEWI	Y	75	310	2300	3280	10.9	20	
		85EEWI	Y	85	430	3050	4350	11.9	21.9	
		90EEWI	Y	90	525	3600	5130	12.4	22.8	
		110EEWI	Y	110	850	5500	7840	13.8	26.5	
		140EEWI	Y	140	1730	11000	15700	15.5	28.5	
		150EEWI	Y	150	2090	13400	18500	15.6	28.7	
		160EEWI	Y	160	2500	15600	22800	16.9	31.5	

Notes: Minimum operating voltage for integrated trip indicator = 20V.

Microswitch reference : MS 6.3 GR 2-5N

Electrical Characteristics:

Times vs current characteristics

These curves indicate, for each rated current, the pre-arcing time vs. the RMS pre-arcing current.

Tolerance for the mean pre-arcing current $\pm 10\%$

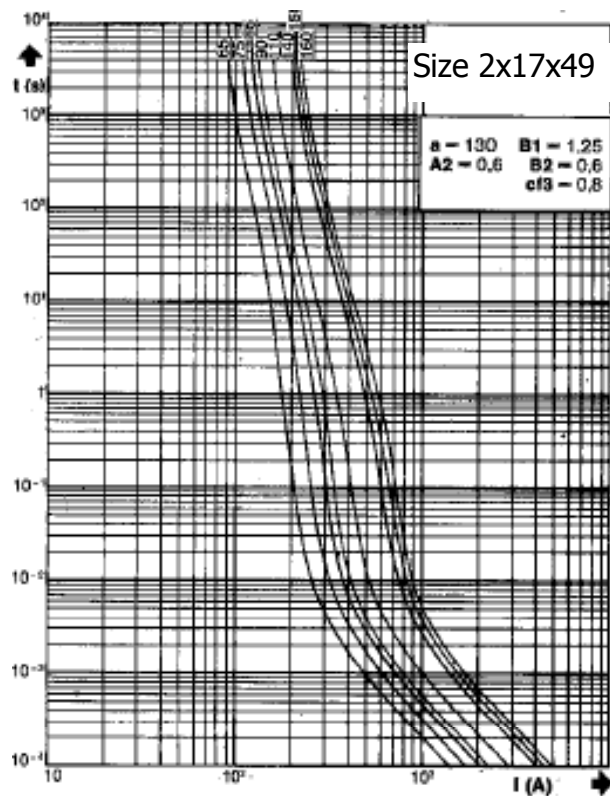
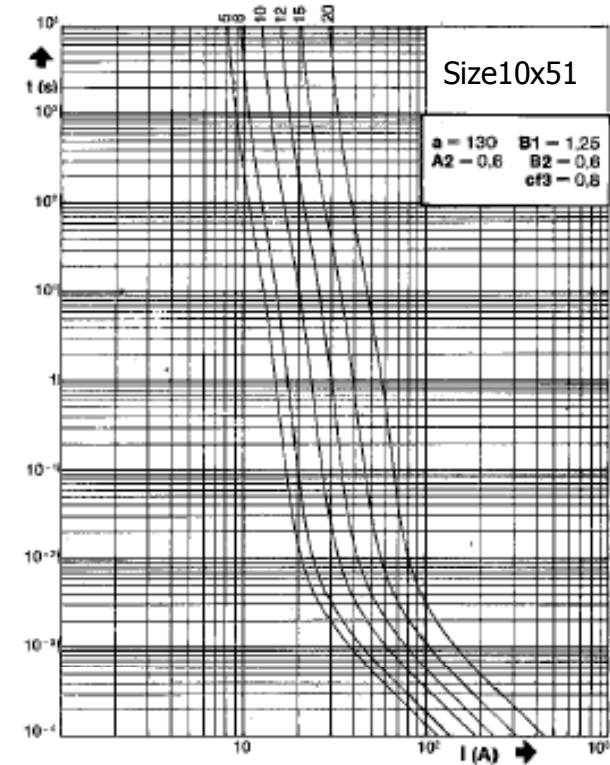

Corrective Factor

The mean curves show the variation of the total clearing time (I^2t_c) and the total clearing duration t_c as a function of operating voltage U.

CW – Size 10x51

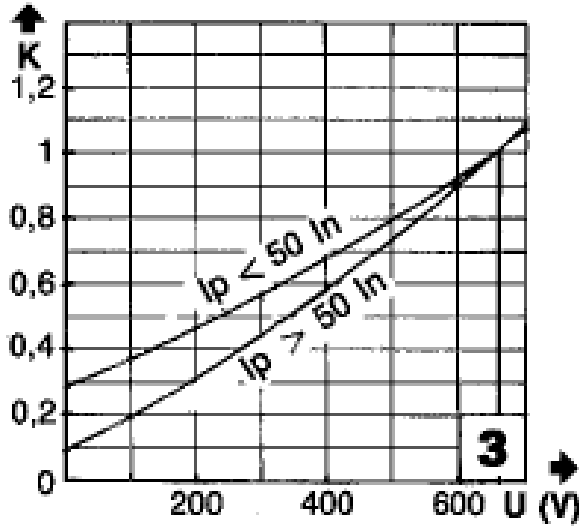

EEW & EEWI – Size 2x17x49

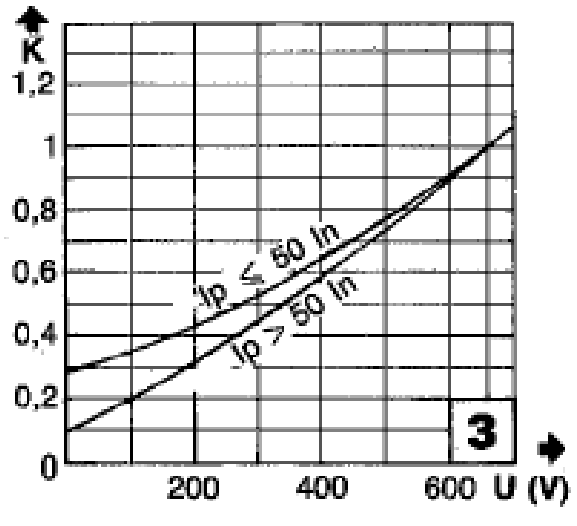

Peak Arc Voltage

This curve shows the peak value U_m of the arc voltage which appears across the fuse link as a function of the operating voltage U @ $\cos \varphi = 0.15$.

CW – Size 10x51

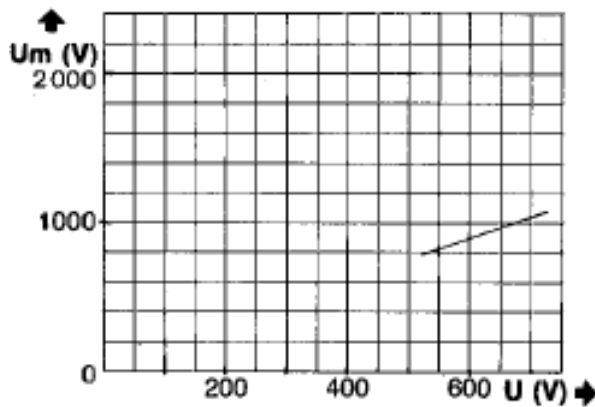

EEW & EEWI – Size 2x17x49

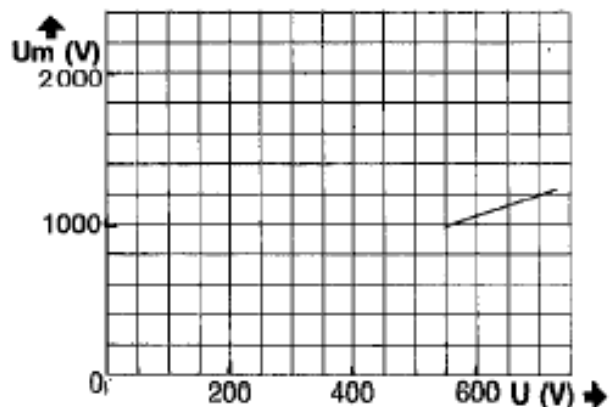

Outline Drawing & Ordering Information

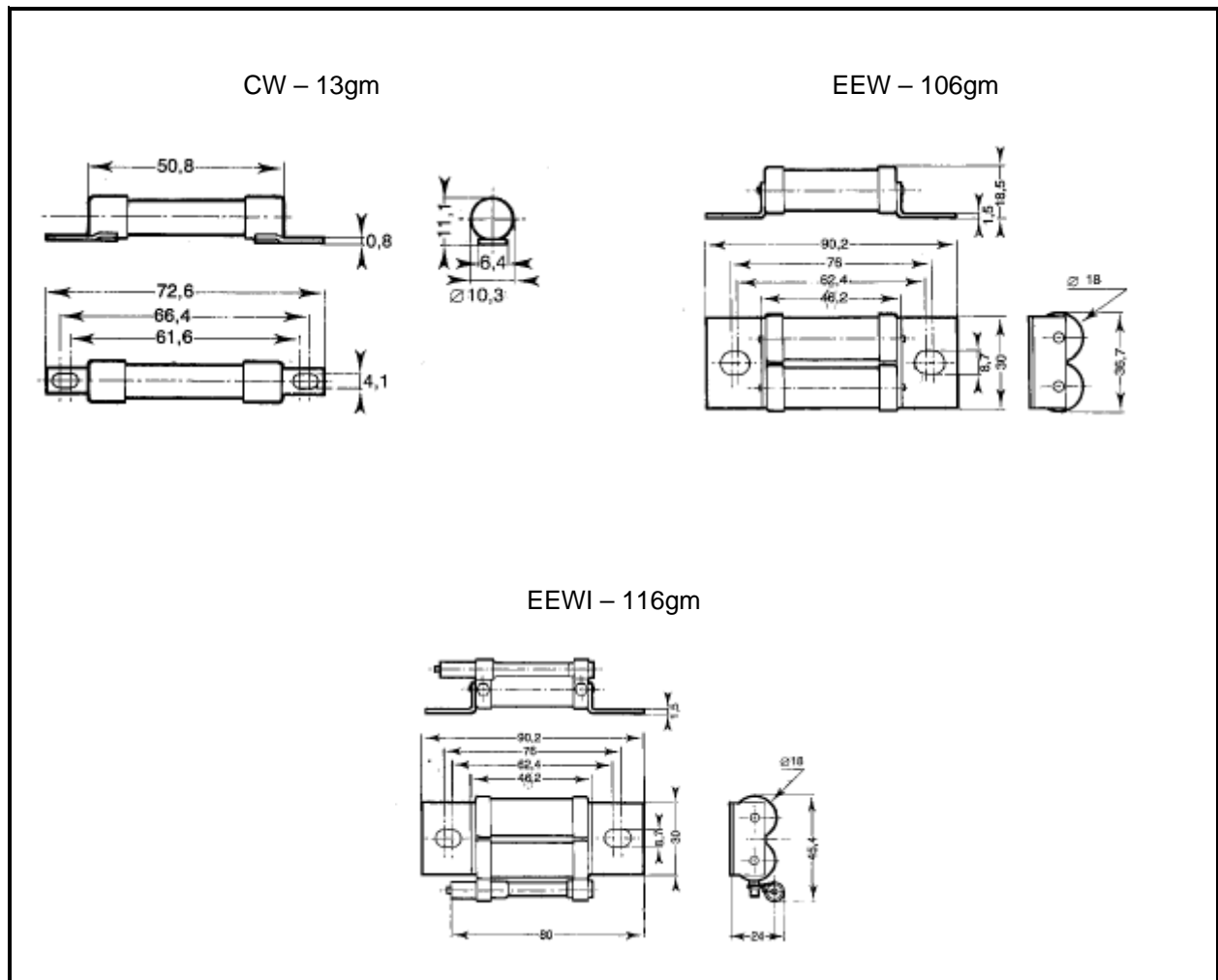

ORDERING INFORMATION

(Please quote code as below)

Style	Voltage	Current Rating (A)	Type	Trip Indicator
BS 88 Round Body	690V	5 to 160	CW or EEW	I

Order code: e.g. **65EEWI** = BS 88 Round Body – 65amp fuse with Trip indicator

IXYS Semiconductor GmbH
 Edisonstraße 15
 D-68623 Lampertheim
 Tel: +49 6206 503-0
 Fax: +49 6206 503-627
 E-mail: marcom@ixys.de

WESTCODE

An IXYS Company

Westcode Semiconductors Ltd
 Langley Park Way Langley Park
 Chippenham Wiltshire SN15 1GE
 Tel: +44 (0)1249 444524
 Fax: +44 (0)1249 659448
 E-mail: WSL.sales@westcode.com

IXYS Corporation
 3540 Bassett Street
 Santa Clara CA 95054 USA
 Tel: +1 (408) 982 0700
 Fax: +1 (408) 496 0670
 E-mail: sales@ixys.com

www.westcode.com

www.ixys.com

Westcode Semiconductors Inc
 3270 Cherry Avenue
 Long Beach CA 90807 USA
 Tel: +1 (562) 595 6971
 Fax: +1 (562) 595 8182
 E-mail: WSI.sales@westcode.com

The information contained herein is confidential and is protected by Copyright. The information may not be used or disclosed except with the written permission of and in the manner permitted by the proprietors Westcode Semiconductors Ltd.

© Westcode Semiconductors Ltd.

In the interest of product improvement, Westcode reserves the right to change specifications at any time without prior notice.