

DWG. NO. 361-100-0002G

REV	DESCRIPTION	BY DATE	APPD
A	RELEASED PER NPR 2375	10/15/01	[Signature]

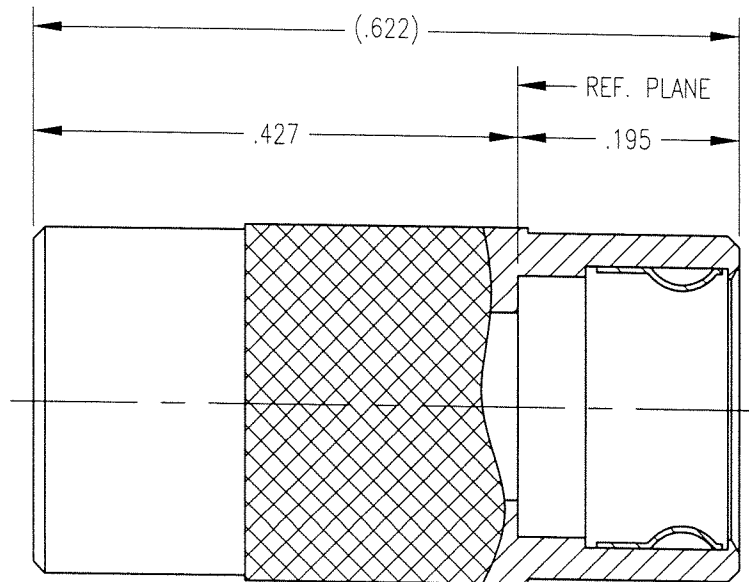

NOTES:

1. MATERIALS:
 - BODY: STAINLESS STEEL PER ASTM A582
 - OUTER CONTACT: BERYLLIUM COPPER PER ASTM B194
 - CAP: BRASS PER ASTM B16
2. FINISH:
 - OUTER AND CONTACT: .000030 MIN. GOLD PER MIL-G-45204 OVER
.000050 MIN. NICKEL PER QQ-N-290
 - BODY: .000015 MIN. GOLD PER MIL-G-45204 OVER
.000050 MIN. NICKEL PER QQ-N-290
 - CAP: .000005 MIN. GOLD PER MIL-G-45204 OVER
.000050 MIN. NICKEL PER QQ-N-290

PER ASME Y14.5M-1994 UNLESS OTHERWISE SPECIFIED: DIMENSIONS ARE IN INCHES (MM)		Litton	
TOLERANCES: DECIMALS xx ± .01/0.254 xxx ± .005/0.127 ANGLES ± Z'		Winchester/Retconn 400 Park Road Wallingford, Connecticut 06795	
SCALE: 6:1		TITLE	
CUSTOMER DRAWING		BMA JACK OPEN	
DRAWN KJT	DATE 02/23/01	CHECKED JWH	DATE 3/16/01
APPROVED JEM	DATE 3/16/01	APPROVED JED	DATE 3/16/01
A		361-100-0002G	SHT. 1 OF 1 REV. A