

Current Transformers for Power Control

Japan
Singapore
Indonesia

Type: **E19B, E19I**



Detect the input current of the power line for voltage conversion

Industrial Property: Utility models 2 (incl.pending)

■ Features

- Casing structure
- Linear input/output characteristics
- Good temperature characteristics of input/output
- Capable of automatic mounting

■ Recommended Applications

- IH electric rice cooker
- Air-conditioner
- H.A. controller

■ Explanation of Part Numbers

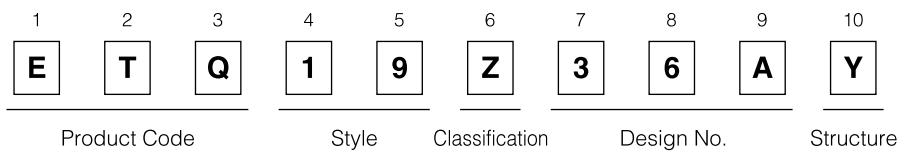

■ Performance, Specifications, Summary (E19B)

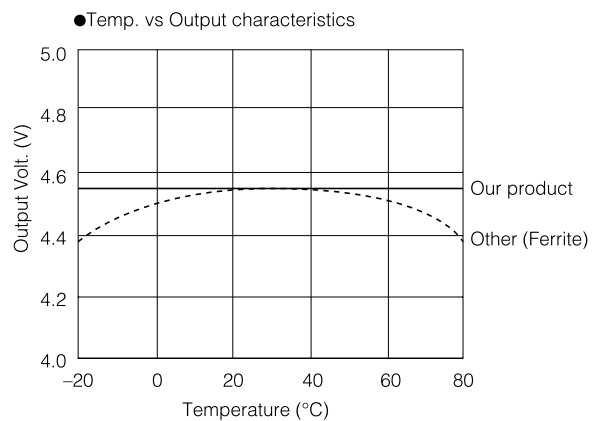
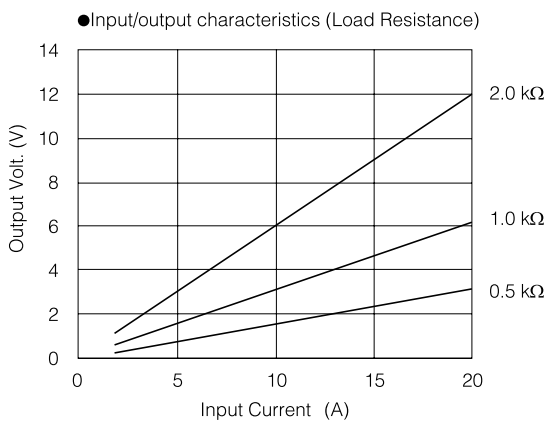

Output Volt.	Current Amp.	Load Resis.	Environmental Temp.	Withstanding Volt.
AC 4.55V (Tolerance: ±3 %)	50/60 Hz 15 A	1.0 kΩ	20 °C	AC 1500 V, 1 min
AC 4.55V (Tolerance: ±5 %)	50/60 Hz 15 A	1.0 kΩ	-25 °C to 80 °C	

■ Dimensions in mm (not to scale)

E19B (Series Z)

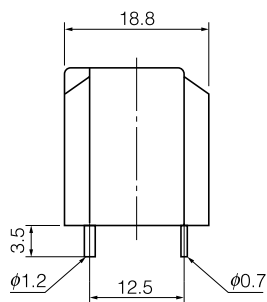
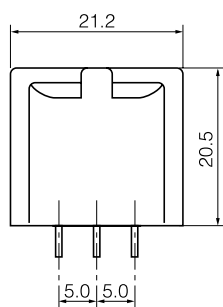

Recommended PWB Piercing Plan
(Top View)

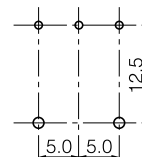

E19I

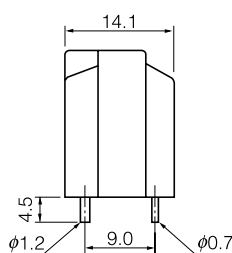
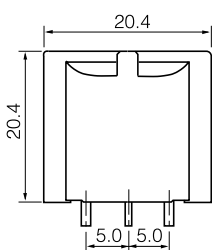

Recommended PWB Piercing Plan
(Top View)

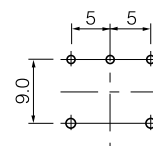

■ Packaging Methods

Size	E19B	E19I
Min. Quantity (pcs.)	100	130
Quantity/Standard Box (pcs.)	500	650

⚠ Cautions for use

If abnormal operations (disconnecting and shorting, etc.) should happen, the current transformers may occur unusual smell, sound and smoking, etc.

User is recommended to set up suitable protective circuit for stopping the abnormal conditions.