

- 1.0 PERFORMANCE
- 1.1 FREQUENCY RANGE: DC-300 MHz
- 1.2 VOLTAGE RATING: 500V RMS (see level)
- 1.3 NOMINAL IMPEDANCE: NON-CONSTANT
- 1.4 DWV: 1500 V RMS @ 60 Hz (see level)
- 1.5 TEMPERATURE RANGE: -55°C TO +85°C
- 2.0 MATERIALS
- 2.1 DIELECTRIC: TEFLON, ASTM-D-1710
- 2.2 CENTER CONTACT: BRASS PER ASTM-B-16
- 2.3 OTHER METAL PARTS: BRASS PER ASTM-B-16
- 3.0 FINISHES
- 3.1 CENTER CONTACT: SILVER PLATED
- 3.2 ALL OTHER METAL PARTS: NICKEL PLATED

DWG NO. 01-0601-04-1 REV. A

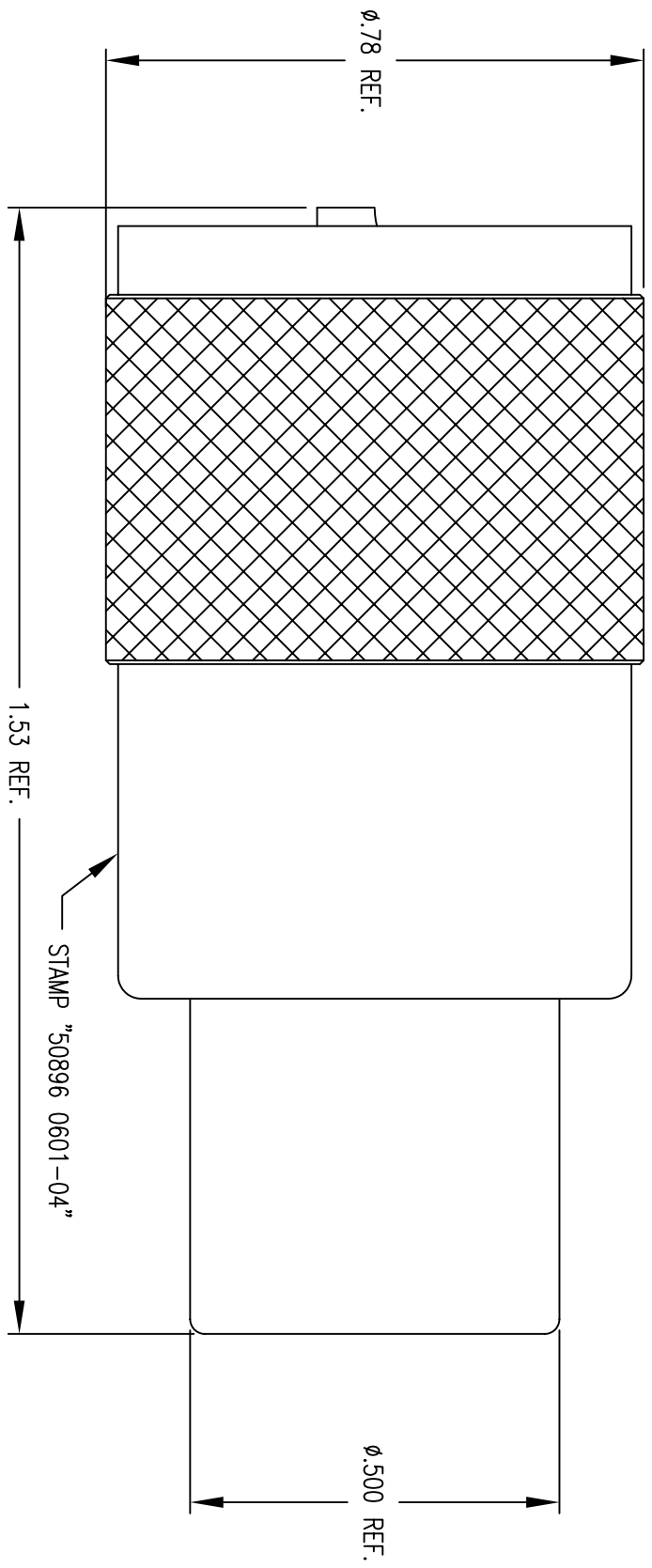

PROPRIETARY
 THIS DRAWING CONTAINS CONFIDENTIAL INFORMATION PROPRIETARY TO SAN*TRON INC. IT MUST NOT BE REPRODUCED OR DISCLOSED TO OTHERS OR USED IN ANY OTHER WAY, IN WHOLE OR PART EXCEPT AS AUTHORIZED IN WRITING BY SAN*TRON INCORPORATED.

REMOVE ALL BURRS AND SHARP EDGES .005 MAX. UNLESS OTHERWISE STATED ALL DIMENSIONS ARE IN INCHES AND APPLY AFTER PLATING

UNSPECIFIED TOL.		DWN	JMB	5/17/00
DEC.	± .005	CHKD	SJS	11/27/00
FRAC.	± 1/64	APPR		
ANG.	± 1/2°			

CONCENTRICITY .004 TIR 63/ ALL MACHINED SURFACES

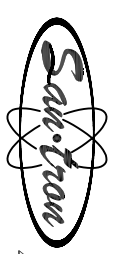

SAN • TRON, INC.
 4 NEWBURYPORT TPK, IPSWICH, MA 01938

TITLE UHF PLUG, STRAIGHT FOR USE WITH RG-8,9,213,214 & 225/U

MATERIAL: SEE NOTE 2.0 FINISH: SEE NOTE 3.0

FSCM NO. 50896 DWG NO. 01-0601-04-1 SCALE 4:1 REV. A

Rev.	Revisions	Date	Dwn.	Appd.
A	ORIGINAL	12/3/00	✓	✓
RECOM.	STOCK SIZE	FT/M PCS	QTY REQD	