

Models 1509R2-2 & 1509R3-2 0.5 to 2.0 GHz 2-WAY POWER DIVIDERS

SMA Female Connectors

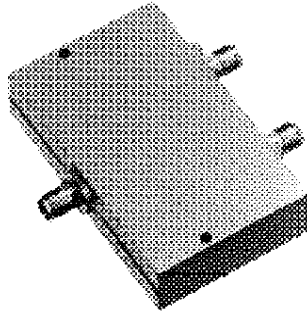

This series of Wilkinson Power Dividers has been designed to achieve high isolation and low SWR in a miniature stripline configuration. Etched teflon fiberglass stripline circuits are enclosed within a machined housing that eliminates RF moding and provides high RF shielding. These designs are ideal for lab applications, internal leveling, ECM Systems, communication satellites, RF and microwave test equipment, and wireless applications. Other features include:

- ❑ Flat Frequency Response.
- ❑ Excellent Amplitude and Phase Tracking.
- ❑ Stainless Steel Female SMA Connectors - mate nondestructively with MIL-C-39012 connectors.

SPECIFICATIONS

Model Number	Frequency Range (GHz)	Isolation (dB min)	Maximum SWR		Maximum Insertion Loss (dB)	Amplitude Tracking (dB MAX)	Phase Tracking (± ° TYP)	Average Power (W) Load SWR		
			INPUT	OUTPUT				1.2	2.0	
1509R2-2	0.5-1.0	22	1.20	1.10	0.20	0.20	2.0	30	10	1
1509R3-2	1.0-2.0	22	1.25	1.20	0.25	0.20	3.0	30	10	1

PHYSICAL DIMENSIONS:

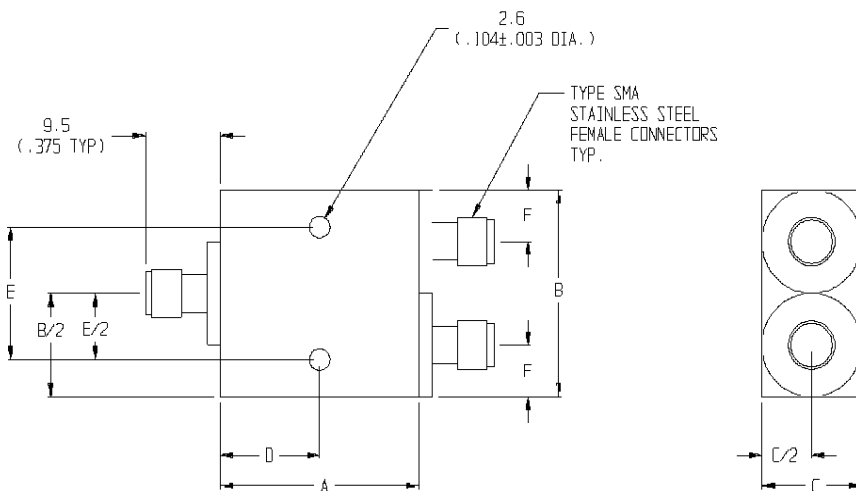

Notes:

1. All dimensions are given inmm (inches) and are nominal unless otherwise specified
2. Specifications subject to change without notice.

Model	A	B	C	D	E	F
1509R3-2	38.10(1.50)	38.10(1.50)	12.70(0.50)	19.05(0.75)	33.27(1.31)	6.35(0.25)
1509R2-2	38.10(1.50)	63.50(2.50)	12.70(0.50)	13.46(0.53)	58.67(2.31)	19.05(0.75)