

Rev	AWO #	Description	Date	Appr
-		RELEASED	9/02/10	

APPROVED: _____
 DATE: _____ TITLE: _____

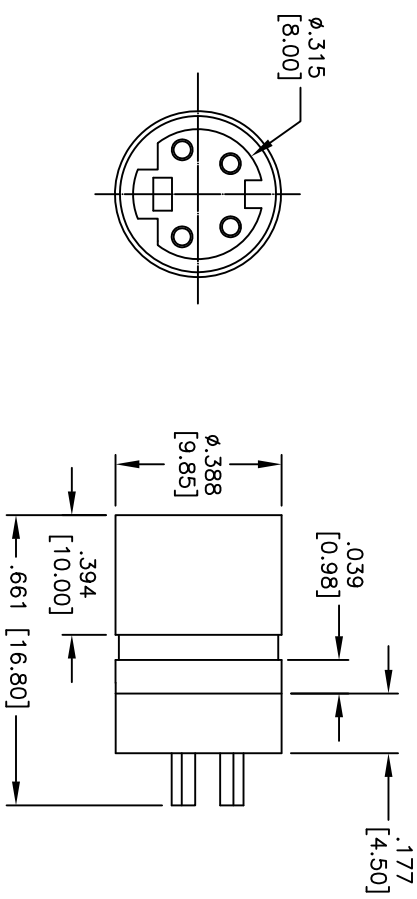

MATING FACE CONFIGURATIONS					
MDV-003-M	MDV-004-M	MDV-005-M	MDV-006-M	MDV-007-M	MDV-008-M

SPECIFICATIONS:
 Material: _____
 Metal Part: Copper, Nickel plated
 Insulator: PC
 Pin contact: Copper, silver plated
 Electrical:
 Operating voltage: 100V AC 1A MAX or 12V DC 2A MAX
 Contact resistance: 30 mohms max.
 Insulation resistance: 50 Mohms min @ 250V DC
 Dielectric withstanding voltage: 250 VAC for 1 minute
 Environmental:
 Lead free, RoHS compliant.



UNLESS OTHERWISE SPECIFIED
 ALL DIMENSIONS ARE IN INCHES [MM]
 TOLERANCES: EXCEPT AS NOTED
 INCHES Holes ±.10
 .X ±.10 ØXX ±.10
 .XX ±.020 ØXXX ±.015
 .XXX ±.015 ØXXXX ±.010
 APPROVALS DATE

ADAM TECH
 909 Railway Avenue, Union, NJ 07083
 Phone: 908-687-5000 Fax: 908-687-5710

TITLE: **MINI DIN JACK, MOLDED TYPE**

DRAWN	DY	9/02/10	SIZE	PART NO.	REV.
CHECKED			X	MDV-00X-M	-
APPROVED			REF: S0067T	SCALE: NTS	SHEET 1 OF 1