

Assembly Layout
Straight Angle (V-Type)

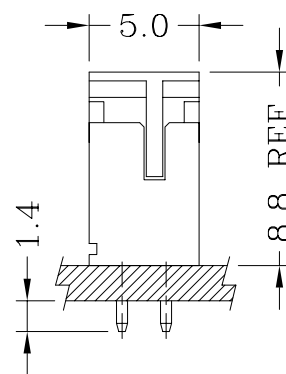

Right Angle (R-Type)

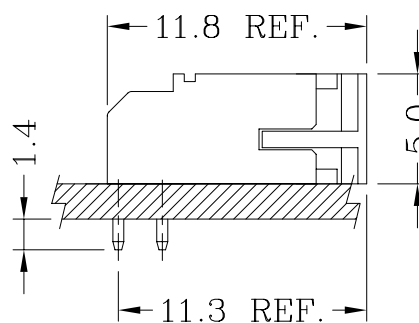

Specifications:

Pitch between poles	2.0mm
Rated Voltage	250V AC,DC
Rated Current	2A (AWG #24) / 1A (AWG #26~#28)
Withstand Voltage	800V AC/minute
Contact Resistance	10mΩ (MAX.)
Insulation Resistance	1,000MΩ (MIN.)
Temperature Range	-25°~+85°C
Applicable P.C.B. Thickness	1.6mm
Applicable P.C.B. Hole dia.	ø0.80±0.05
Applicable Wire Range	AWG #24~#28

UL: Recognized No. E144544

A2006 Series 2.00mm pitch crimp terminal socket

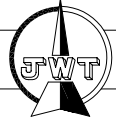

Features:

- * Available in 6 through 40 circuits
- * Material: Nylon 66 UL 94V-0 (White)
- * Suitable for JWT A2006 series terminal
- * Mates with JWT A2006 series wafer

Dimensional & Ordering Information:

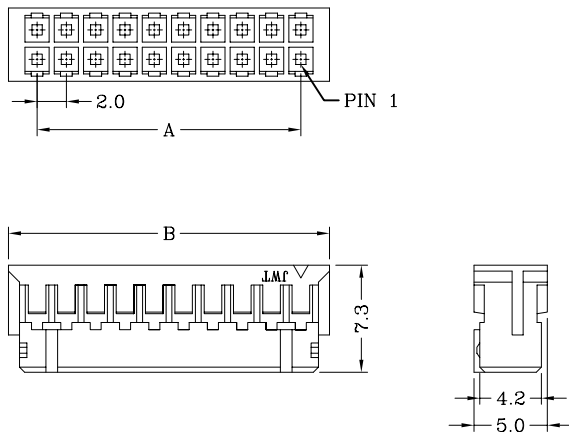

Circuits	Part No	Dimensions		Pcs/Bag
		A	B	
6	A2006H00-2x3P	4.0	7.9	1,000
8	A2006H00-2x4P	6.0	9.9	1,000
10	A2006H00-2x5P	8.0	11.9	1,000
12	A2006H00-2x6P	10.0	13.9	1,000
14	A2006H00-2x7P	12.0	15.9	1,000
16	A2006H00-2x8P	14.0	17.9	1,000
18	A2006H00-2x9P	16.0	19.9	1,000
20	A2006H00-2x10P	18.0	21.9	1,000
22	A2006H00-2x11P	20.8	23.9	1,000
24	A2006H00-2x12P	22.0	25.9	1,000
26	A2006H00-2x13P	24.0	27.9	1,000
28	A2006H00-2x14P	26.0	29.9	1,000
30	A2006H00-2x15P	28.0	31.9	1,000
32	A2006H00-2x16P	30.0	33.9	1,000
34	A2006H00-2x17P	32.0	35.9	1,000
36	A2006H00-2x18P	34.0	37.9	1,000
38	A2006H00-2x19P	36.0	39.9	1,000
40	A2006H00-2x20P	38.0	41.9	1,000

A2006 Series 2.00mm pitch crimp terminal

Features:

- * Dual contact point
- * Used in JWT A2006 series socket

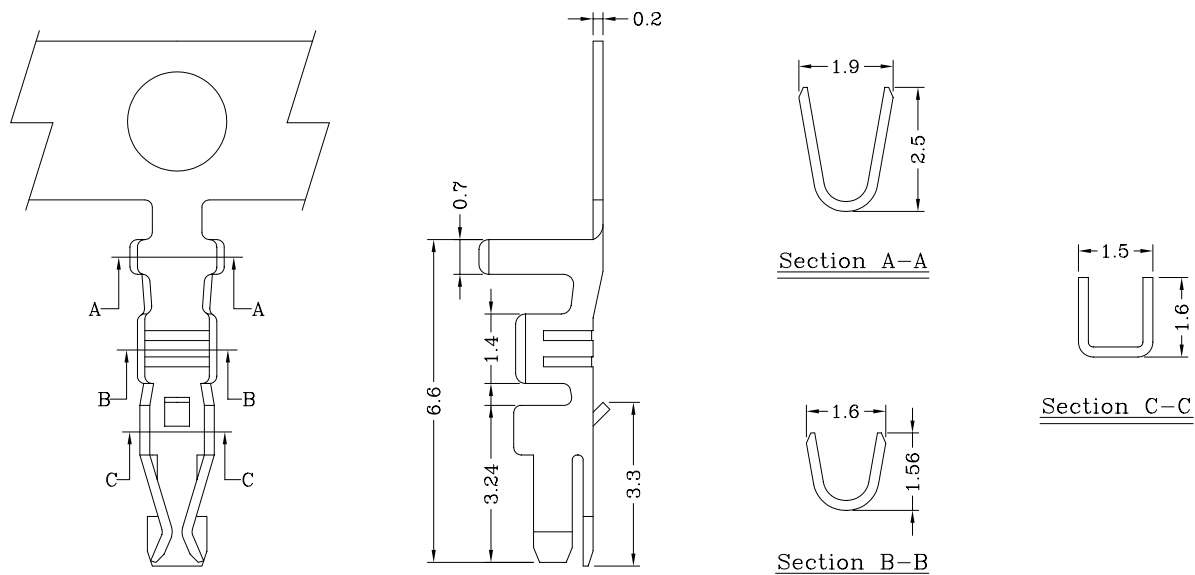

Specifications & Ordering Information:

Part No	Wire Range	Insulation O.D.	Material	Finish	Qty/reel
A2006TOP-2	AWG #24~#28	1.60mm(max)	Phosphor bronze	Tin-plated	10,000 PCS

A2006 Series 2.00mm pitch wafer (V-Type)

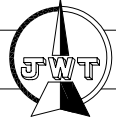

Features:

- * Available in 6 through 40 circuits
- * Material: Insulator: PBT UL 94V-0 with 15% GF (White)
Contact: 0.50mm(.020") square pin, brass, tin plated
- * Mates with JWT A2006 series socket

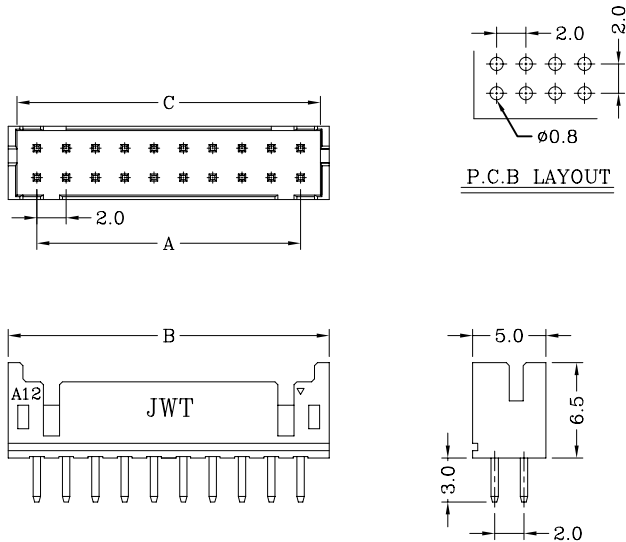

Dimensional & Ordering Information:

Circuits	Part No	Dimensions			Pcs/Bag
		A	B	C	
6	A2006WVO-2x3P	4.0	7.9	6.7	1000
8	A2006WVO-2x4P	6.0	9.9	8.7	1000
10	A2006WVO-2x5P	8.0	11.9	10.7	500
12	A2006WVO-2x6P	10.0	13.9	12.7	500
14	A2006WVO-2x7P	12.0	15.9	14.7	500
16	A2006WVO-2x8P	14.0	17.9	16.7	500
18	A2006WVO-2x9P	16.0	19.9	18.7	500
20	A2006WVO-2x10P	18.0	21.9	20.7	250
22	A2006WVO-2x11P	20.8	23.9	22.7	250
24	A2006WVO-2x12P	22.0	25.9	24.7	250
26	A2006WVO-2x13P	24.0	27.9	26.7	250
28	A2006WVO-2x14P	26.0	29.9	28.7	250
30	A2006WVO-2x15P	28.0	31.9	30.7	250
32	A2006WVO-2x16P	30.0	33.9	32.7	250
34	A2006WVO-2x17P	32.0	35.9	34.7	250
36	A2006WVO-2x18P	34.0	37.9	36.7	250
38	A2006WVO-2x19P	36.0	39.9	38.7	250
40	A2006WVO-2x20P	38.0	41.9	40.7	250

A2006 Series 2.00mm pitch wafer (R-Type)

Features:

- * Available in 6 through 40 circuits
- * Material: Insulator: PBT UL 94V-0 with 15% GF (White)
Contact: 0.50mm(.020") square pin, brass, tin plated
- * Mates with JWT A2006 series socket

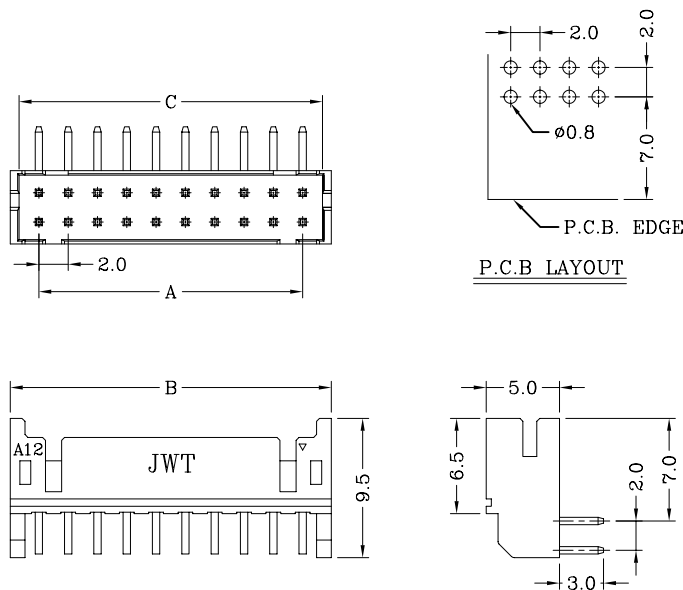

Dimensional & Ordering Information:

Circuits	Part No	Dimensions			Pcs/Bag
		A	B	C	
6	A2006WRO-2x3P	4.0	7.9	6.7	1000
8	A2006WRO-2x4P	6.0	9.9	8.7	1000
10	A2006WRO-2x5P	8.0	11.9	10.7	500
12	A2006WRO-2x6P	10.0	13.9	12.7	500
14	A2006WRO-2x7P	12.0	15.9	14.7	500
16	A2006WRO-2x8P	14.0	17.9	16.7	500
18	A2006WRO-2x9P	16.0	19.9	18.7	500
20	A2006WRO-2x10P	18.0	21.9	20.7	250
22	A2006WRO-2x11P	20.8	23.9	22.7	250
24	A2006WRO-2x12P	22.0	25.9	24.7	250
26	A2006WRO-2x13P	24.0	27.9	26.7	250
28	A2006WRO-2x14P	26.0	29.9	28.7	250
30	A2006WRO-2x15P	28.0	31.9	30.7	250
32	A2006WRO-2x16P	30.0	33.9	32.7	250
34	A2006WRO-2x17P	32.0	35.9	34.7	250
36	A2006WRO-2x18P	34.0	37.9	36.7	250
38	A2006WRO-2x19P	36.0	39.9	38.7	250
40	A2006WRO-2x20P	38.0	41.9	40.7	250