

DASH NO.	M CODE	MADE FROM
----------	--------	-----------

SD

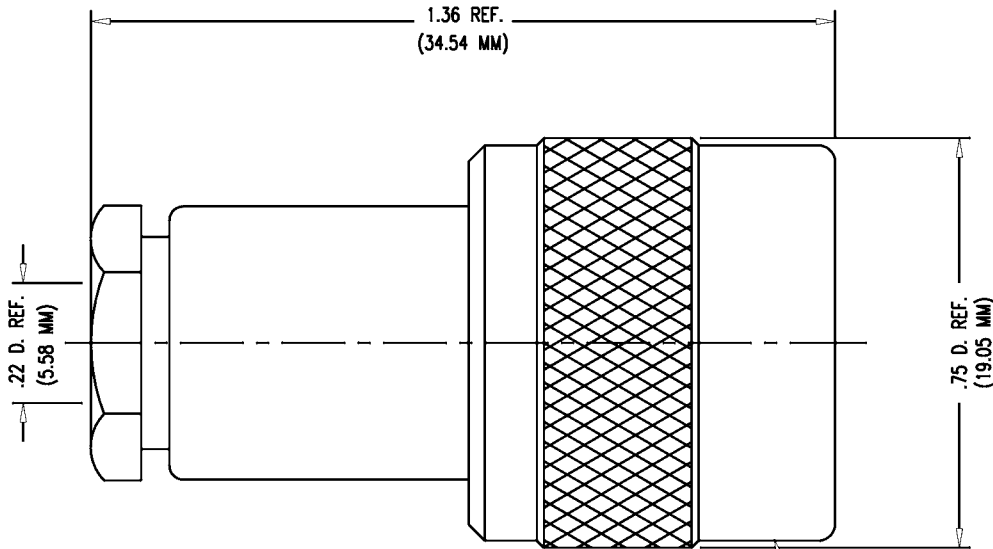

STAMP: 91836 UG-709B/U
YRWK (DATE CODE)

NOTES:

1. FOR USE WITH RG-55, 58, 141, 142, 223, 303 & 400/U CABLES.
2. FOR CABLING INSTRUCTIONS SEE CP-1015.
3. MARK PACKAGE: 91836 UG-709 B/U
YRWK (DATE CODE)

REVISIONS	
ISSUE	CHANGES
9	CN 38128 C REDRAWN TML 03/28/01
10	CN 38756 E JPK 01/22/03
11	CN 39177 B JLA 09/30/04
12	CN 39306 E HVN 07/25/05

UG-709 B/U

709BUdR12

SCALE 4:1	
APPROX SURFACE AREA	
KD-57-01	
USED ON	
REF: MS90214D	
PLUG, C	
DRAWN TML	DATE 03/28/01
DESIGN	DATE
APPR.	DATE
 KINGS ELECTRONICS CO., INC. ROCK HILL, SOUTH CAROLINA 29730	
UG-709 B/U	

SD

UNLESS OTHERWISE SPECIFIED 1. TOLERANCES: FRACTIONS & 2 PLACE DECIMALS ± .010 3 PLACE DECIMALS ± .004 ANGLES ± 1° CONCENTRICITY OF ANY 2 DIAMETERS MAY NOT EXCEED HALF THE SUM OF THEIR TOLERANCES.	2. REMOVE ALL BURRS, BREAK SHARP EDGES .005 MAX. 3. NO FILLETS PERMITTED. 4. SURFACE ROUGHNESS 63 MICROINCHES RMS MAX. 5. ALL DIMENSIONS PRIOR TO PLATING. 6. ALL PLATING IN ACCORDANCE WITH KER 10004.	7. ALL LEAD THREADS TO BE CHAMFERED 45° TO ROOT DIAMETER. ★ CRITICAL DIMENSIONS
---	---	---