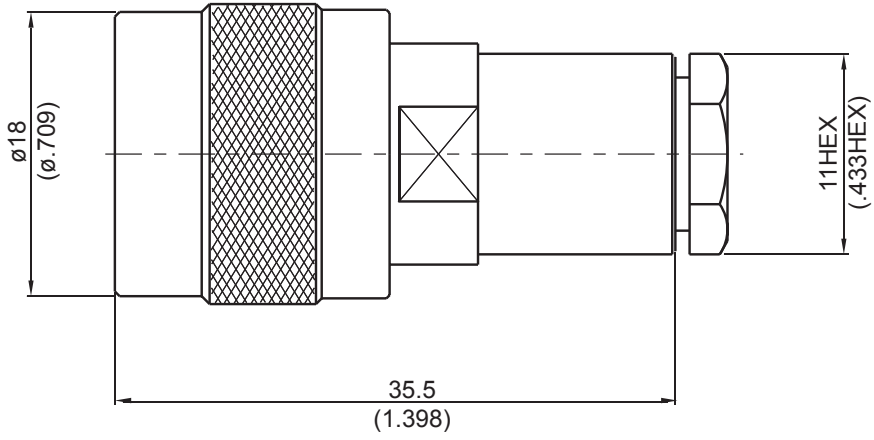

C3200B-0058		C Plug Clamp	50Ω
			
Parts	Material	Plating(Micro-inch)	
Ferrule	Brass	Tin-Zinc-Copper-Alloy 100 Over Copper 50	
Nut Hex	Brass	Tin-Zinc-Copper-Alloy 100 Over Copper 50	
Gasket	Silicone		
Braid Clamp	Brass	Tin-Zinc-Copper-Alloy 100 Over Copper 50	
Center Pin	Brass	Gold 5 Over Nickel 50 Over Copper 50	
Spring	SK5	Tin-Zinc-Copper-Alloy 100 Over Copper 50	
Washer	Brass	Tin-Zinc-Copper-Alloy 100 Over Copper 50	
Insulator	Teflon		
Contact Body	Brass	Tin-Zinc-Copper-Alloy 100 Over Copper 50	
Body	Brass	Tin-Zinc-Copper-Alloy 100 Over Copper 50	
Coupling Nut	Brass	Tin-Zinc-Copper-Alloy 100 Over Copper 50	
Weight: 34.73 g Suitable Cables: RG58, JBY195, RG55, RG142, RG400, RG142-E, RG223			

This part number complies with RoHS.

Notice: JYEBAO reserves the right to make modifications deemed appropriate.

## CABLE ASSEMBLY INSTRUCTION

C3200B-0058

JYE BAO CO., LTD.

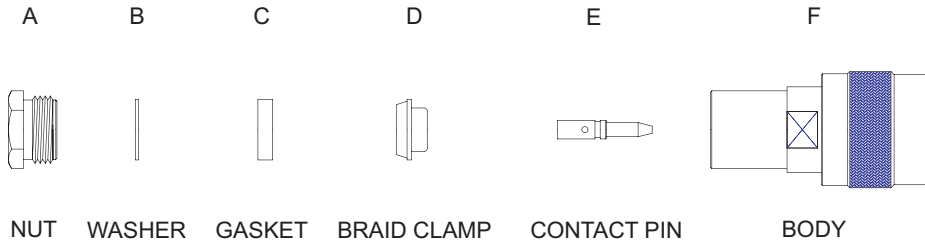

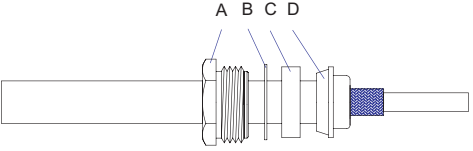
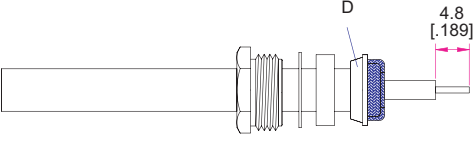
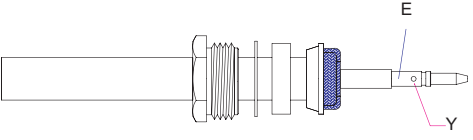
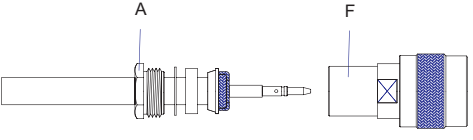

DIAGRAM	ASSEMBLY INSTRUCTION
	Step 1: STRIP AS SHOWN.
	Step 2: SLIDE "A" "B" "C" "D" OVER CABLE.
	Step 3: WRAP THE BRAIDING OVER "D".
	Step 4: PUT PIN "E" ON CENTER CONDUCTOR AND SOLDER IT IN "Y".
	Step 5: FINALLY SCREW "A" ON THE CONNECTOR BODY "F".

This part number complies with RoHS.

Notice: JYEBAO reserves the right to make modifications deemed appropriate.