

## AMP-LEAF Blindmate Drawer Connectors (Continued)

**10-Position,  
AMP-LEAF Connector,  
Housing Header**  
Part No. 343348-1, accepts  
AMP-LEAF contacts, loose  
piece or strip-form mounted on  
reels

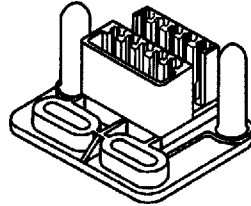

**Material and Finish:**

**Housing**—PBT 30% GF,  
94V-0 rated, black

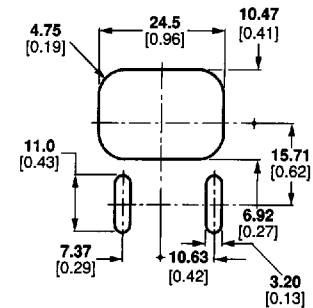
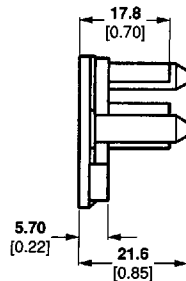
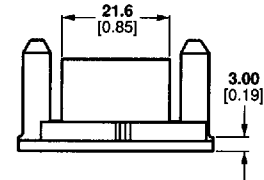
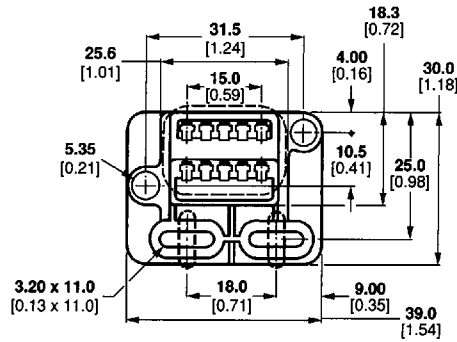

Panel Cutout

**10-Position,  
AMP-LEAF Connector,  
Printed Circuit Board  
Housing Header**  
Part No. 344978-1, housing  
partially loaded with contacts  
in positions 1, 2, 4, 5, 6,  
and 10

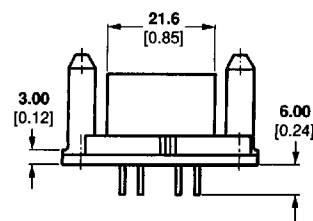
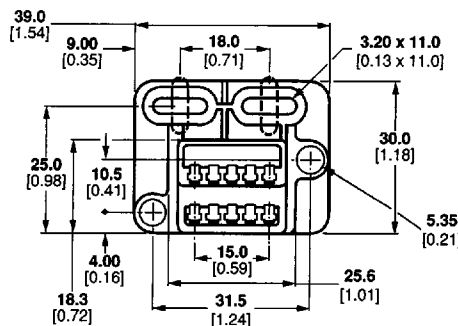

**Unloaded Housing**

Part No. 344977-1, accepts  
AMP-LEAF contacts Part No.  
2-582355-0

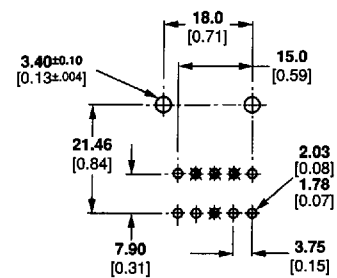
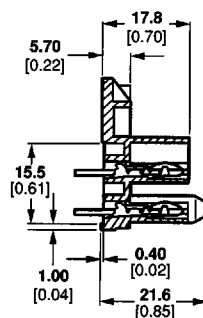

Recommended PC Board Layout

Blindmate Drawer Connectors

## AMP Blindmate Drawer Connectors – Introduction

### Product Facts

- Ideal for rack and panel applications
- High durability, withstands repeated mating and unmating
- Hermaphroditic contact design
- Integrated guide mechanism assures proper mating
- Design provides face-to-face contact
- Hermaphroditic contacts provide positive electrical contact

### Mini-Drawer Connectors

- Front mating connectors, contacts pre-assembled
- CT receptacles in rear of connector
- Blindmate hermaphroditic housings 14 and 22-positions available
- Pre-loaded hermaphroditic contacts
- IDC type contacts for CT connectors

### Hybrid Mini-Drawer Connectors

- Provides integrated signal and power circuitry
- Power circuits up to 15 amp
- Meets requirements for creep and spatial distances for primary power supplies per IEC-950 Safety Specifications
- Approved by UL and TUV Standards

### Hybrid Drawer Connectors

- Mixed signal and power circuits
- Plugs and receptacles for cable mount, receptacles for board mount
- Wire size range 24-14 [0.2-2.0mm<sup>2</sup>]

### High Current,

### Hybrid Drawer Connectors

- Mixed signal and high current circuits
- MIC connector contacts used for high current circuits
- Available in 24-positions, 4-high current and 20-signal

### Other Drawer Connectors include:

- 3-position tab contact connectors
- 3-position double-leaf spring contact connectors, and:

### AMP-LEAF Drawer Connectors

- Designed for blindmate applications
- Wire-to-wire, wire-to-board styles 6 and 10-positions available
- Housings made of PBT 30% GF
- Contacts in strip-form or loose piece
- Contacts plated gold-over-nickel
- Accepts wire size range 0.15-2.0mm<sup>2</sup> [26-14 AWG]



AMP blindmate drawer connectors are designed to provide an economical means of connection in rack and panel applications, such as copying machines, control boards, industrial equipment, electronic-based equipment and power supply systems.

A major feature of these connectors is their ability to withstand repeated mating and unmating. This is facilitated by a low insertion and extraction force.

Hermaphroditic contacts are designed to provide a positive electrical contact. Housings provide an integrated guide system to facilitate blindmating of the connectors. Housings also provide for outside dust protection.

For complete specifications see:

- Pages 24-28 – CHAMP 1.0mm Micro-Drawer Connectors
- Pages 29-30 – Mini-Drawer Connectors

- Pages 31-34 – Hybrid Mini-Drawer Connectors
- Pages 35-37 – Hybrid Drawer Connectors
- Pages 38-39 – High Current, Hybrid Drawer Connectors
- Pages 40-45 – AMP-LEAF Blindmate Drawer Connectors, and Tab and Double Leaf Spring Contact Drawer Connectors

**New Product**

**CHAMP 1.0mm Micro-Drawer Connectors**

These newest members of the CHAMP High Density Connector Family offer true metric design with contacts on 1.00 [.039] centerlines, minimizing use of pc board real estate.

Low profile design, only 7.5 [.295] high lends to their overall micro-minia-

ture application in the modularization of sub-notebook/notebook computers with interconnection designs for batteries, disk drives, CD-ROMS, etc.

Other applications include:

- Notepad computers
- Cellular telephones
- Miniaturized facsimile and modem equipment
- Other computer/peripheral and communications type equipment

The CHAMP 1.0mm Micro-Drawer Connector features housings and tine plates

made of 94V-0 rated thermoplastic, with pre-inserted contacts made of phosphor bronze, plated with durable palladium/nickel. Tin-lead plated retention legs secure the connector to the pc board prior to soldering, and assure proper connector positioning during the soldering operation.

**Turn to page 24 for complete details on this exciting, new product.**

## Special Versions — Blindmate Drawer Connectors

### Product Facts

#### 3-position tab power contact connector

- Blindmate connector
- Accepts FASTON tabs
- Contacts—Brass, tin-plated
- Housings—PBT 30% GF, black
- Current Rating—10 A (18-14 AWG [0.9-9.0mm<sup>2</sup>])
- Voltage Rating—250 VAC
- Insulation Diameter—.122-.161 [3.10-4.10]



#### 3-position, double-leaf spring power contact connector

- Blindmate connector
- Accepts Standard timer contacts with cantilever springs
- Housing—PBT 30% GF, black
- Contacts—Copper, plated tin
- Wire Size Range—17-12 AWG [1.0-2.5mm<sup>2</sup>]
- Insulation Diameter—.118-.169 [3.0-4.3]



#### 6 and 10-position AMP-LEAF connectors, socket housing and PC board header

- Blindmate connector
- Accepts AMP-LEAF contacts
- Housing—PBT 30% GF, black
- Contacts—Phosphor bronze, plated gold over nickel
- Current Rating—4 A max., 26-14 AWG [0.14-0.36mm<sup>2</sup>]
- Voltage Rating—50 VDC
- Temperature Rating—-10°C to +80°C
- Insulation Diameter—.050-.064 [1.27-1.63]

