

LOC	DIST	P	F	ZONE	LTR	REVISIONS	DATE	APPD
AJ	16				D	SUP5D P/N'S PER 0U20-0644-00	10APR01	MO

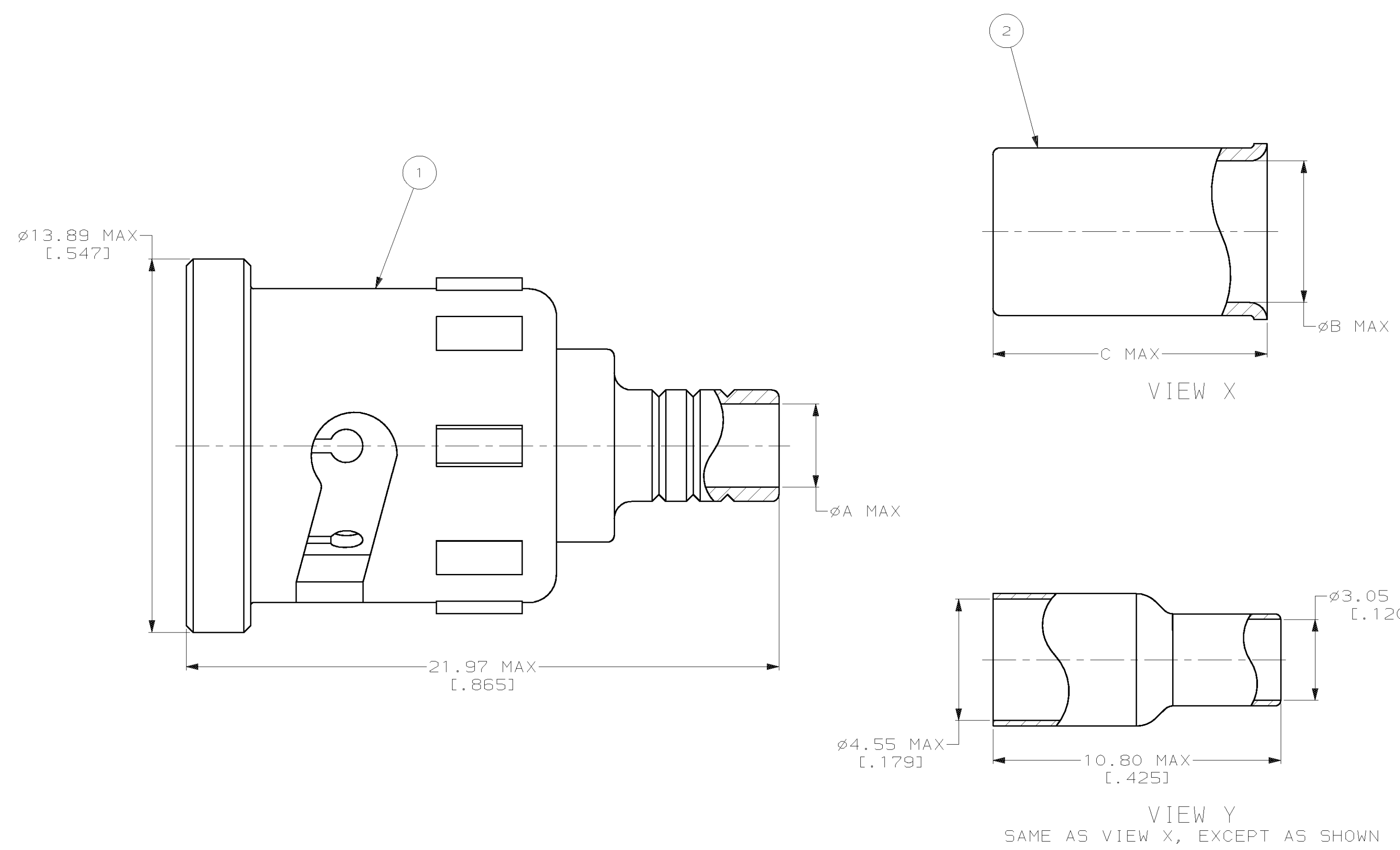

1. TERMINATE WITH AMP-O-ELECTRIC TERMINATING MACHINE 220152-1 WITH APPLICATOR
2. USED WITH CENTER CONTACTS SUPPLIED ON STRIP, PURCHASED SEPARATELY

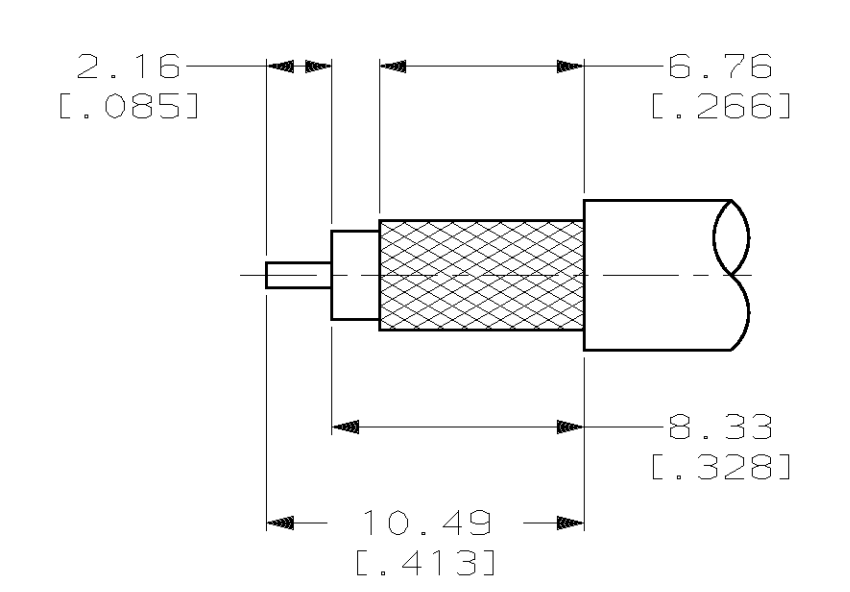

RECOMMENDED STRIP LENGTH
SCALE 4:1

SUPERSEDED BY 414915-3	RG-174/U, 179/U	YELLOW	-	-	Y	2-328666-5	2.92 [.115]	2-414721-1	2-414914-1
SUPERSEDED BY 414915-2	RG-59, 59A, 59B/U	YELLOW	10.57 [.416]	6.63 [.261]	X	50428-2	4.01 [.158]	2-414721-0	2-414914-0
SUPERSEDED BY 414915-1	RG-58, 58A, 58B, 58C/U & BELDEN 9907	YELLOW	10.41 [.410]	5.33 [.210]	X	50427-4	3.23 [.127]	1-414721-9	1-414914-9
SUPERSEDED BY 414915-3	RG-174/U, 179/U	WHITE	-	-	Y	2-328666-5	2.92 [.115]	1-414721-8	1-414914-8
SUPERSEDED BY 414915-2	RG-59, 59A, 59B/U	WHITE	10.57 [.416]	6.63 [.261]	X	50428-2	4.01 [.158]	1-414721-7	1-414914-7
SUPERSEDED BY 414915-1	RG-58, 58A, 58B, 58C/U & BELDEN 9907	WHITE	10.41 [.410]	5.33 [.210]	X	50427-4	3.23 [.127]	1-414721-6	1-414914-6
SUPERSEDED BY 414915-3	RG-174/U, 179/U	GRAY	-	-	Y	2-328666-5	2.92 [.115]	1-414721-5	1-414914-5
SUPERSEDED BY 414915-2	RG-59, 59A, 59B/U	GRAY	10.57 [.416]	6.63 [.261]	X	50428-2	4.01 [.158]	1-414721-4	1-414914-4
SUPERSEDED BY 414915-1	RG-58, 58A, 58B, 58C/U & BELDEN 9907	GRAY	10.41 [.410]	5.33 [.210]	X	50427-4	3.23 [.127]	1-414721-3	1-414914-3
SUPERSEDED BY 414915-3	RG-174/U, 179/U	GREEN	-	-	Y	2-328666-5	2.92 [.115]	1-414721-2	1-414914-2
SUPERSEDED BY 414915-2	RG-59, 59A, 59B/U	GREEN	10.57 [.416]	6.63 [.261]	X	50428-2	4.01 [.158]	1-414721-1	1-414914-1
SUPERSEDED BY 414915-1	RG-58, 58A, 58B, 58C/U & BELDEN 9907	GREEN	10.41 [.410]	5.33 [.210]	X	50427-4	3.23 [.127]	1-414721-0	1-414914-0
SUPERSEDED BY 414915-3	RG-174/U, 179/U	RED	-	-	Y	2-328666-5	2.92 [.115]	414721-9	414914-9
SUPERSEDED BY 414915-2	RG-59, 59A, 59B/U	RED	10.57 [.416]	6.63 [.261]	X	50428-2	4.01 [.158]	414721-8	414914-8
SUPERSEDED BY 414915-1	RG-58, 58A, 58B, 58C/U & BELDEN 9907	RED	10.41 [.410]	5.33 [.210]	X	50427-4	3.23 [.127]	414721-7	414914-7
SUPERSEDED BY 414915-3	RG-174/U, 179/U	BLUE	-	-	Y	2-328666-5	2.92 [.115]	414721-6	414914-6
SUPERSEDED BY 414915-2	RG-59, 59A, 59B/U	BLUE	10.57 [.416]	6.63 [.261]	X	50428-2	4.01 [.158]	414721-5	414914-5
SUPERSEDED BY 414915-1	RG-58, 58A, 58B, 58C/U & BELDEN 9907	BLUE	10.41 [.410]	5.33 [.210]	X	50427-4	3.23 [.127]	414721-4	414914-4
SUPERSEDED BY 414915-3	RG-174/U, 179/U	BLACK	-	-	Y	2-328666-5	2.92 [.115]	414721-3	414914-3
SUPERSEDED BY 414915-2	RG-59, 59A, 59B/U	BLACK	10.57 [.416]	6.63 [.261]	X	50428-2	4.01 [.158]	414721-2	414914-2
SUPERSEDED BY 414915-1	RG-58, 58A, 58B, 58C/U & BELDEN 9907	BLACK	10.41 [.410]	5.33 [.210]	X	50427-4	3.23 [.127]	414721-1	414914-1

FOR USE WITH CABLE	COLLAR COLOR	C	B	VIEW	(2)	FERRULE QTY=1	A	(1)	PLUG ASSEMBLY QTY=1	PART NUMBER
--------------------	--------------	---	---	------	-----	---------------	---	-----	---------------------	-------------

DO NOT SCALE PRINT. UNLESS SPECIFIED DIMENSIONS IN mm [INCHES] TOLERANCES ON: 2 PLC DEC ± .016 3 PLC DEC ± .010 ANGLES ± -	DR 21JUL94 M.E. COWHER CHK 21JUL94 M. PHILLIPS APPD 21JUL94 M. PHILLIPS	AMP Incorporated Harrisburg, PA 17105-3508
MATERIAL	APPD 21JUL94 M.E. COWHER	
FINISH	PRODUCT SPEC	NAME
WEIGHT	APPLICATION SPEC	PLUG, 50 OHM, CONSUMER, BNC
		SIZE D
		CAGE CODE 00779
		DRAWING NO. C-414914
		SCALE 10:1
		SHEET 1 OF 1

THIS DRAWING IS A CONTROLLED DOCUMENT FOR AMP INCORPORATED. IT IS SUBJECT TO CHANGE AND THE CONTROLLING ENGINEERING ORGANIZATION SHOULD BE CONTACTED FOR THE LATEST REVISION.